

☐ Motive Battery ■ Energy Storage Battery

☐ Reserve Battery ☐ Motorcycle Battery



## Energy Storage Battery-Tubular GEL Technology-OPzV Series

# 100PzV1000

## (2V 1000Ah)

### GENERAL FEATURES

- ◆ 20 years design life at floating condition
- ◆ Wide operating temperature range from -40°C to +60°C
- ◆ Tubular positive plate with prolonged cycle life
- ◆ Fumed silica gel electrolyte
- ◆ Lead calcium die case grid with improved corrosion resistance ability
- ◆ Low self-discharge rate and long shelf life
- ◆ Excellent deep discharge recovery capability



### Application

- ◆ Renewable energy system
- ◆ Hybrid solar power system
- ◆ Uninterrupted Power Supply ( UPS )
- ◆ Communications and electric equipment
- ◆ Emergency lighting equipment
- ◆ Fire alarm and security systems
- ◆ Control equipment, and other factory automation equipment
- ◆ Emergency power supply ( EPS )
- ◆ Lighting equipment

### Dimension

Unit:mm

Length	233±2mm	/	9.17inch
Width	210±2mm	/	8.27inch
Container Height	646±3mm	/	25.43inch
Total Height	681±3mm	/	26.81inch

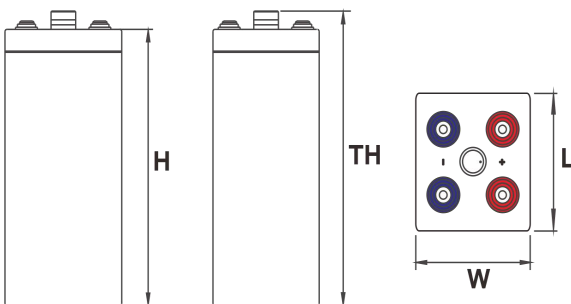

### Terminal

Unit:mm

Terminal Type I7

### Weight

78.5kg 173.06lbs

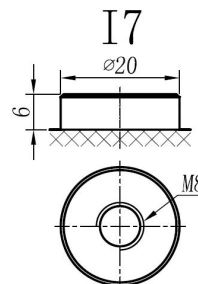

This document is subject to change without prior notification

Motive Battery  Energy Storage Battery

Reserve Battery  Motorcycle Battery



# 100PzV1000

## Specification

<b>Nominal Voltage</b>	2V	
<b>Rated Capacity(25°C)</b>	1060Ah	20hr Rate(1.80V/cell)
	1000Ah	10hr Rate(1.80V/cell)
	866Ah	5hr Rate(1.75V/cell)
	778Ah	3hr Rate(1.70V/cell)
	569Ah	1hr Rate(1.60V/cell)
<b>Container Material</b>	ABS ( Fire-proofing ABS container available )	
<b>Operating Temperature Range</b>	<b>Discharge</b>	-20 ~ +50°C
	<b>Charge</b>	0 ~ +40°C
	<b>Storage</b>	-15 ~ +40°C
<b>Capacity Effected by Temperature</b>	40°C / 104°F	106%
	25°C / 77°F	100%
	0°C / 32°F	86%
	-10°C / 14°F	65%
<b>Charge Voltage</b>	<b>Float Voltage</b>	2.25 -2.30V/cell@25°C, Compensation Factor : -3mV/cell/°C
	<b>Equalize Voltage</b>	2.35 -2.40V/cell@25°C, Compensation Factor : -3mV/cell/°C
	<b>Cycle Voltage</b>	2.40 -2.50V/cell@25°C, Compensation Factor : -5mV/cell/°C
<b>Max Charging Current</b>	300A (0.3C)	
<b>Max. Discharge Current (5S)</b>	8000A	
<b>Internal Resistance</b>	0.19mΩ	
<b>Self Discharge</b>	<3%, TN series stored at 25 ° C require a supplementary charge every six months, the charging interval would shrink when the ambient temperature went higher	

## Discharge Performance

Constant Current Discharge Table (25°C/77°F) Unit: A

F.V/Time	10min	15min	30min	1h	2h	3h	5h	8h	10h	20h
1.85V/cell	682.7	648.6	558.6	445.4	295.3	228.2	157.2	110.11	93.71	49.66
1.80V/cell	839.8	784.8	650.7	502.5	324.3	249.2	169.2	118.12	100.01	53.00
1.75V/cell	993.0	877.9	693.7	522.5	333.3	254.3	173.2	119.12	102.01	54.06
1.70V/cell	1114.1	958.0	733.7	542.5	342.3	259.3	175.2	121.12	103.01	54.59
1.65V/cell	1197.2	1012.0	763.8	558.6	349.3	264.3	178.2	122.12	104.01	55.12
1.60V/cell	1252.3	1048.0	782.8	568.6	354.4	267.3	180.2	123.12	105.01	55.65

Constant Power Discharge Table (25°C/77°F) Unit: W

F.V/Time	10min	15min	30min	1h	2h	3h	5h	8h	10h	20h
1.85V/cell	1269.3	1218.2	1067.1	862.9	574.6	446.4	309.3	217.2	186.19	99.17
1.80V/cell	1533.5	1453.5	1231.2	965.0	627.6	483.5	332.3	232.2	199.20	106.09
1.75V/cell	1783.8	1604.6	1299.3	998.0	641.6	492.5	337.3	236.2	201.20	107.17
1.70V/cell	1966.0	1725.7	1361.4	1030.0	654.7	500.5	341.3	238.2	203.20	108.23
1.65V/cell	2073.1	1794.8	1401.4	1052.1	665.7	507.5	345.3	241.2	205.21	109.30
1.60V/cell	2128.1	1831.8	1422.4	1063.1	670.7	511.5	347.3	242.2	206.21	109.83

□ 动力电池

■ 储能电池

□ 备用电池

□ 摩托车电池



### 储能电池-管式胶体技术-OPzV系列

# 100PzV1000

## (2V 1000Ah)

### 产品特点

- ◆ 20年设计浮充寿命
- ◆ 使用温度区间宽广, 在-40°C至+60°C之间均可正常使用
- ◆ 管式正极板设计, 大大延长使用寿命
- ◆ 气象二氧化硅凝胶电解质
- ◆ 铅钙板栅显著提升抗腐蚀能力
- ◆ 自放电率低, 能够长时间放置保存
- ◆ 出色的深放电恢复能力



### 产品应用

- ◆ 不间断电源(UPS)
- ◆ 通信及电力设备
- ◆ 应急照明系统
- ◆ 安防及火灾报警系统
- ◆ 控制设备及其他工厂自动化设备
- ◆ 应急电源 (EPS)
- ◆ 照明设备

### 尺寸

单个尺寸

长	233±2mm
宽	210±2mm
高	646±3mm
总高	681±3mm

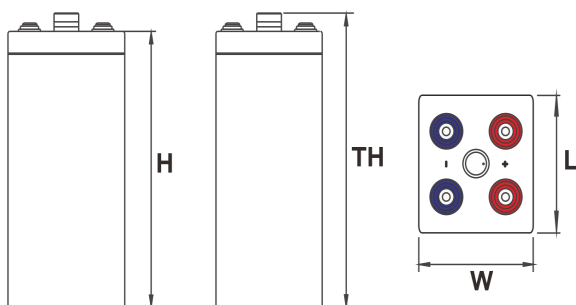

### 端子类型

单位:mm

端子类型 I7

### 重量

78.5kg 173.06lbs

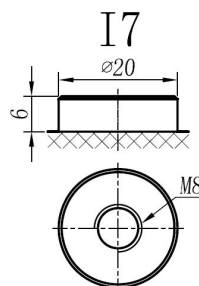

内容如有改动, 恕不另行通知

动力电池

储能电池

备用电池

摩托车电池



## 规格书

# 100PzV1000

额定电压	2V	
容量(25°C)	1060Ah	20hr Rate(1.80V/cell)
	1000Ah	10hr Rate(1.80V/cell)
	866Ah	5hr Rate(1.75V/cell)
	778Ah	3hr Rate(1.70V/cell)
	569Ah	1hr Rate(1.60V/cell)
壳体材料	ABS (阻燃ABS壳体可选)	
使用温度范围	放电	-20 ~ +50°C
	充电	0 ~ +40°C
	储存	-15 ~ +40°C
不同温度下 电池容量系数	40°C / 104°F	106%
	25°C / 77°F	100%
	0°C / 32°F	86%
	-10°C / 14°F	65%
充电电压	浮充	2.25 -2.30V/单格@25°C, 补偿系数: -3mV/单格/°C
	均充	2.35 -2.40V/单格@25°C, 补偿系数: -3mV/单格/°C
	循环使用	2.40 -2.50V/单格@25°C, 补偿系数: -5mV/单格/°C
最大充电电流	300A (0.3C)	
最大放电电流 (5S)	8000A	
电阻	0.19mΩ	
自放电	<3%, TN系列储存在25°C 时需每6个月进行一次补充充电, 环境温度更高时则充电间隔时间越短	

## 放电性能

恒电流放电表 (25°C/77°F) 单位: A										
F.V/Time	10min	15min	30min	1h	2h	3h	5h	8h	10h	20h
1.85V/cell	682.7	648.6	558.6	445.4	295.3	228.2	157.2	110.1	93.7	49.7
1.80V/cell	839.8	784.8	650.7	502.5	324.3	249.2	169.2	118.1	100.0	53.0
1.75V/cell	993.0	877.9	693.7	522.5	333.3	254.3	173.2	119.1	102.0	54.1
1.70V/cell	1114.1	958.0	733.7	542.5	342.3	259.3	175.2	121.1	103.0	54.6
1.65V/cell	1197.2	1012.0	763.8	558.6	349.3	264.3	178.2	122.1	104.0	55.1
1.60V/cell	1252.3	1048.0	782.8	568.6	354.4	267.3	180.2	123.1	105.0	55.7

恒功率放电表 (25°C/77°F) 单位: W										
F.V/Time	10min	15min	30min	1h	2h	3h	5h	8h	10h	20h
1.85V/cell	1269.3	1218.2	1067.1	862.9	574.6	446.4	309.3	217.2	186.2	99.2
1.80V/cell	1533.5	1453.5	1231.2	965.0	627.6	483.5	332.3	232.2	199.2	106.1
1.75V/cell	1783.8	1604.6	1299.3	998.0	641.6	492.5	337.3	236.2	201.2	107.2
1.70V/cell	1966.0	1725.7	1361.4	1030.0	654.7	500.5	341.3	238.2	203.2	108.2
1.65V/cell	2073.1	1794.8	1401.4	1052.1	665.7	507.5	345.3	241.2	205.2	109.3
1.60V/cell	2128.1	1831.8	1422.4	1063.1	670.7	511.5	347.3	242.2	206.2	109.8