

Motive Battery  Energy Storage Battery

Reserve Battery  Motorcycle Battery



## Energy Storage Battery-Tubular GEL Technology-OPzV Series

# 50PzV250

## (2V 250Ah)

### GENERAL FEATURES

- ◆ 20 years design life at floating condition
- ◆ Wide operating temperature range from -40°C to +60°C
- ◆ Tubular positive plate with prolonged cycle life
- ◆ Fumed silica gel electrolyte
- ◆ Lead calcium die case grid with improved corrosion resistance ability
- ◆ Low self-discharge rate and long shelf life
- ◆ Excellent deep discharge recovery capability



### Application

- ◆ Renewable energy system
- ◆ Hybrid solar power system
- ◆ Uninterrupted Power Supply ( UPS )
- ◆ Communications and electric equipment
- ◆ Emergency lighting equipment
- ◆ Fire alarm and security systems
- ◆ Control equipment, and other factory automation equipment
- ◆ Emergency power supply ( EPS )
- ◆ Lighting equipment

### Dimension

Unit:mm

Length	124±2mm	/	4.88inch
Width	206±2mm	/	8.11inch
Container Height	355±3mm	/	13.98inch
Total Height	390±3mm	/	15.35inch

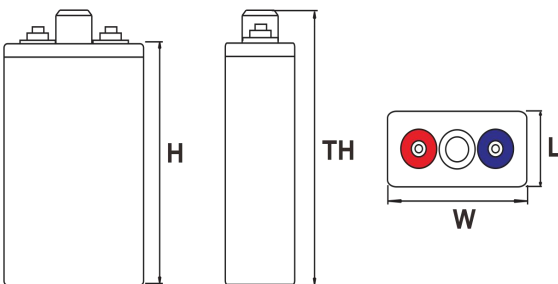

### Terminal

Unit:mm

Terminal Type I7

### Weight

22kg 48.5lbs

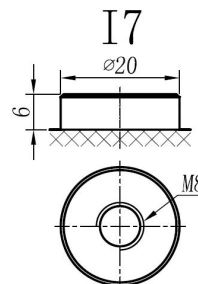

This document is subject to change without prior notification

Motive Battery  Energy Storage Battery

Reserve Battery  Motorcycle Battery



## 50PzV250

### Specification

<b>Nominal Voltage</b>	2V	
<b>Rated Capacity(25°C)</b>	265Ah	20hr Rate(1.80V/cell)
	250Ah	10hr Rate(1.80V/cell)
	219Ah	5hr Rate(1.75V/cell)
	199Ah	3hr Rate(1.70V/cell)
	143Ah	1hr Rate(1.60V/cell)
<b>Container Material</b>	ABS ( Fire-proofing ABS container available )	
<b>Operating Temperature Range</b>	<b>Discharge</b>	-20 ~ +50°C
	<b>Charge</b>	0 ~ +40°C
	<b>Storage</b>	-15 ~ +40°C
<b>Capacity Effected by Temperature</b>	40°C / 104°F	106%
	25°C / 77°F	100%
	0°C / 32°F	86%
	-10°C / 14°F	65%
<b>Charge Voltage</b>	<b>Float Voltage</b>	2.25 -2.30V/cell@25°C, Compensation Factor : -3mV/cell/°C
	<b>Equalize Voltage</b>	2.35 -2.40V/cell@25°C, Compensation Factor : -3mV/cell/°C
	<b>Cycle Voltage</b>	2.40 -2.50V/cell@25°C, Compensation Factor : -5mV/cell/°C
<b>Max Charging Current</b>	75A (0.3C)	
<b>Max. Discharge Current (5S)</b>	2000A	
<b>Internal Resistance</b>	1.1mΩ	
<b>Self Discharge</b>	<3%, TN series stored at 25 ° C require a supplementary charge every six months, the charging interval would shrink when the ambient temperature went higher	

### Discharge Performance

Constant Current Discharge Table (25°C/77°F) Unit: A

F.V/Time	10min	15min	30min	1h	2h	3h	5h	8h	10h	20h
1.85V/cell	213.2	194.2	153.2	112.1	76.1	58.5	39.9	27.83	23.40	12.40
1.80V/cell	263.3	235.2	178.2	126.1	83.6	63.6	43.0	29.83	25.00	13.25
1.75V/cell	311.3	263.3	190.2	131.1	85.9	65.0	43.8	30.33	25.40	13.46
1.70V/cell	348.3	287.3	201.2	136.1	88.1	66.4	44.5	30.63	25.70	13.62
1.65V/cell	374.4	303.3	209.2	140.1	90.0	67.6	45.2	31.03	25.90	13.73
1.60V/cell	392.4	314.3	214.2	143.1	91.2	68.4	45.7	31.33	26.10	13.83

Constant Power Discharge Table (25°C/77°F) Unit: W

F.V/Time	10min	15min	30min	1h	2h	3h	5h	8h	10h	20h
1.85V/cell	397.4	365.4	292.3	217.2	148.1	114.1	78.5	55.16	46.65	24.84
1.80V/cell	480.5	435.4	337.3	243.2	161.2	123.1	84.4	58.86	49.65	26.44
1.75V/cell	558.6	480.5	355.4	251.3	165.2	126.1	85.7	59.76	50.45	26.87
1.70V/cell	615.6	517.5	372.4	259.3	168.2	128.1	86.8	60.36	50.95	27.14
1.65V/cell	648.6	538.5	383.4	265.3	171.2	130.1	87.8	60.96	51.35	27.35
1.60V/cell	665.7	549.5	389.4	267.3	173.2	130.1	88.3	61.26	51.65	27.51

□ 动力电池

■ 储能电池

□ 备用电池

□ 摩托车电池



### 储能电池-管式胶体技术-OPzV系列

# 50PzV250

## (2V 250Ah)

### 产品特点

- ◆ 20年设计浮充寿命
- ◆ 使用温度区间宽广, 在-40°C至+60°C之间均可正常使用
- ◆ 管式正极板设计, 大大延长使用寿命
- ◆ 气象二氧化硅凝胶电解质
- ◆ 铅钙板栅显著提升抗腐蚀能力
- ◆ 自放电率低, 能够长时间放置保存
- ◆ 出色的深放电恢复能力



### 产品应用

- ◆ 不间断电源(UPS)
- ◆ 通信及电力设备
- ◆ 应急照明系统
- ◆ 安防及火灾报警系统
- ◆ 控制设备及其他工厂自动化设备
- ◆ 应急电源 (EPS)
- ◆ 照明设备

### 尺寸

单个尺寸

长	124±2mm
宽	206±2mm
高	355±3mm
总高	390±3mm

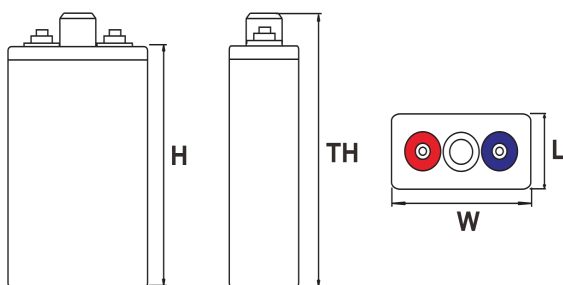

### 端子类型

单位:mm

端子类型 I7

### 重量

22kg 48.5lbs

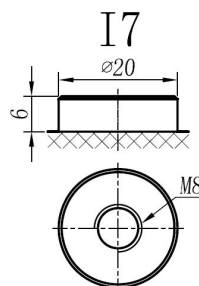

内容如有改动, 恕不另行通知

- 动力电池
- 储能电池
- 备用电池
- 摩托车电池



## 50PzV250

### 规格书

<b>额定电压</b>	2V	
<b>容量(25°C)</b>	265Ah	20hr Rate(1.80V/cell)
	250Ah	10hr Rate(1.80V/cell)
	219Ah	5hr Rate(1.75V/cell)
	199Ah	3hr Rate(1.70V/cell)
	143Ah	1hr Rate(1.60V/cell)
<b>壳体材料</b>	ABS (阻燃ABS壳体可选)	
<b>使用温度范围</b>	<b>放电</b>	-20 ~ +50°C
	<b>充电</b>	0 ~ +40°C
	<b>储存</b>	-15 ~ +40°C
<b>不同温度下 电池容量系数</b>	<b>40°C / 104°F</b>	106%
	<b>25°C / 77°F</b>	100%
	<b>0°C / 32°F</b>	86%
	<b>-10°C / 14°F</b>	65%
<b>充电电压</b>	<b>浮充</b>	2.25 -2.30V/单格@25°C, 补偿系数: -3mV/单格/°C
	<b>均充</b>	2.35 -2.40V/单格@25°C, 补偿系数: -3mV/单格/°C
	<b>循环使用</b>	2.40 -2.50V/单格@25°C, 补偿系数: -5mV/单格/°C
<b>最大充电电流</b>	75A (0.3C)	
<b>最大放电电流 (5S)</b>	2000A	
<b>电阻</b>	1.1mΩ	
<b>自放电</b>	<3%, TN系列储存在25°C 时需每6个月进行一次补充充电, 环境温度更高时则充电间隔时间越短	

### 放电性能

恒电流放电表 (25°C/77°F) 单位: A										
F.V/Time	10min	15min	30min	1h	2h	3h	5h	8h	10h	20h
1.85V/cell	213.2	194.2	153.2	112.1	76.1	58.5	39.9	27.8	23.4	12.4
1.80V/cell	263.3	235.2	178.2	126.1	83.6	63.6	43.0	29.8	25.0	13.3
1.75V/cell	311.3	263.3	190.2	131.1	85.9	65.0	43.8	30.3	25.4	13.5
1.70V/cell	348.3	287.3	201.2	136.1	88.1	66.4	44.5	30.6	25.7	13.6
1.65V/cell	374.4	303.3	209.2	140.1	90.0	67.6	45.2	31.0	25.9	13.7
1.60V/cell	392.4	314.3	214.2	143.1	91.2	68.4	45.7	31.3	26.1	13.8

恒功率放电表 (25°C/77°F) 单位: W										
F.V/Time	10min	15min	30min	1h	2h	3h	5h	8h	10h	20h
1.85V/cell	397.4	365.4	292.3	217.2	148.1	114.1	78.5	55.2	46.6	24.8
1.80V/cell	480.5	435.4	337.3	243.2	161.2	123.1	84.4	58.9	49.6	26.4
1.75V/cell	558.6	480.5	355.4	251.3	165.2	126.1	85.7	59.8	50.5	26.9
1.70V/cell	615.6	517.5	372.4	259.3	168.2	128.1	86.8	60.4	51.0	27.1
1.65V/cell	648.6	538.5	383.4	265.3	171.2	130.1	87.8	61.0	51.4	27.4
1.60V/cell	665.7	549.5	389.4	267.3	173.2	130.1	88.3	61.3	51.7	27.5