

Motive Battery

Energy Storage Battery

Reserve Battery

Motorcycle Battery



## Energy Storage Battery-Tubular GEL Technology-OPzV Series

# OPzV1500

(2V 1500Ah)

## GENERAL FEATURES

- ◆ 20 years design life at floating condition
- ◆ Wide operating temperature range from -40°C to +60°C
- ◆ Tubular positive plate with prolonged cycle life
- ◆ Fumed silica gel electrolyte
- ◆ lead-calcium grid significantly improves the corrosion resistance ability
- ◆ Low self-discharge rate and long shelf life
- ◆ Excellent deep discharge recovery capability



## Application

- ◆ Renewable energy system
- ◆ Hybrid solar power system
- ◆ Uninterrupted Power Supply (UPS)
- ◆ Communications and electric equipment
- ◆ Emergency lighting equipment
- ◆ Fire alarm and security systems
- ◆ Control equipment, and other factory automation equipment
- ◆ Emergency power supply (EPS)
- ◆ Lighting equipment

## Dimension

Unit:mm

Length 275±2mm / 10.83inch

Width 210±2mm / 8.27inch

Container Height 795±3mm / 31.3inch

Total Height 827±3mm / 32.56inch

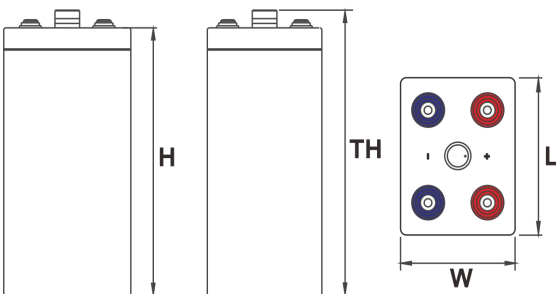

## Terminal

Unit:mm

Terminal Type: I7

## Weight

113.5kg 250.22lbs

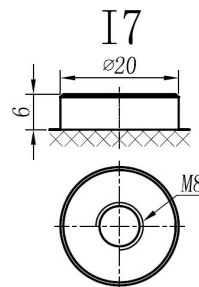

ISO9001 ISO14001 OHSAS18001

This document is subject to change without prior notification

Motive Battery Energy Storage Battery Reserve Battery Motorcycle Battery

## OPzV1500

### Specification

<b>Nominal Voltage</b>	2V	
<b>Rated Capacity(25°C)</b>	1590Ah	20hr Rate(1.80V/cell)
	1500Ah	10hr Rate(1.80V/cell)
	1309Ah	5hr Rate(1.75V/cell)
	1174Ah	3hr Rate(1.70V/cell)
	897Ah	1hr Rate(1.60V/cell)
<b>Container Material</b>	ABS (Fire-proofing ABS container available)	
<b>Operating Temperature Range</b>	<b>Discharge</b>	-40 ~ +60°C
	<b>Charge</b>	0 ~ +40°C
	<b>Storage</b>	-20 ~ +40°C
<b>Capacity Effected by Temperature</b>	<b>40°C / 104°F</b>	106%
	<b>25°C / 77°F</b>	100%
	<b>0°C / 32°F</b>	86%
	<b>-20°C / -4°F</b>	60%
<b>Charge Voltage</b>	<b>Float Voltage</b>	2.23V/cell@25°C, Compensation Factor: -3mV/cell/°C
	<b>Equalize Voltage</b>	2.35 -2.40V/cell@25°C, Compensation Factor: -3mV/cell/°C
	<b>Cycle Voltage</b>	2.40 -2.50V/cell@25°C, Compensation Factor: -5mV/cell°C
<b>Max Charging Current</b>	300A (0.2C)	
<b>Max. Discharge Current (5S)</b>	9000A	
<b>Internal Resistance</b>	0.35mΩ	
<b>Self Discharge</b>	<3%, OPZV series stored at 25 °C require a supplementary charge every six months, the charging interval would shrink when the ambient temperature went higher	

### Discharge Performance

Constant Current Discharge Table (25°C/77°F) Unit: A

F.V/Time	15min	30min	1h	2h	3h	5h	8h	10h	20h
1.85V/cell	1132	906	679	467	357	246	175	145	76.7
1.80V/cell	1258	999	747	495	374	255	182	150	79.5
1.75V/cell	1343	1065	786	519	383	262	187	154	81.3
1.70V/cell	1424	1127	827	534	391	268	189	156	82.7
1.65V/cell	1500	1187	860	549	398	272	192	157	83.3
1.60V/cell	1582	1225	897	558	402	275	194	159	83.7

Constant Power Discharge Table (25°C/77°F) Unit: W

F.V/Time	15min	30min	1h	2h	3h	5h	8h	10h	20h
1.85V/cell	2128	1721	1302	902	692	480	344	285	152
1.80V/cell	2313	1858	1410	948	720	493	355	293	156
1.75V/cell	2433	1953	1471	987	733	504	361	298	159
1.70V/cell	2538	2041	1535	1010	745	514	364	301	161
1.65V/cell	2628	2126	1584	1033	755	520	369	303	162
1.60V/cell	2728	2159	1638	1042	759	523	371	305	162



Motive



Energy Storage Battery



Reserve Battery



Motorcycle Battery

### Discharge Characteristics Curve

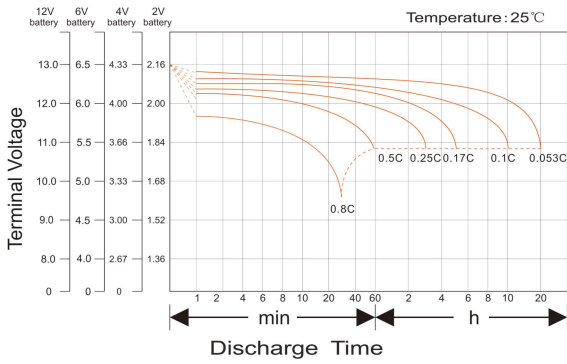

### Charging Characteristics Curve

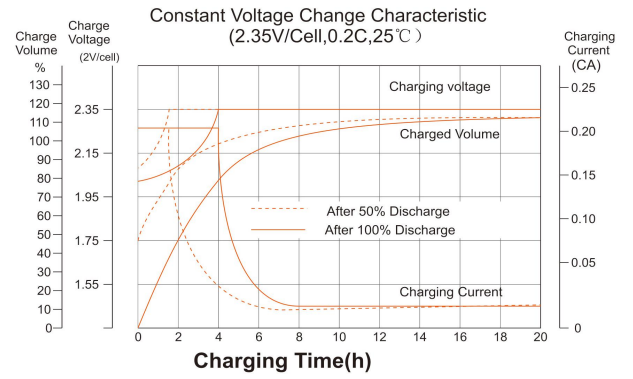

### Cycle life in relation to depth of Discharge

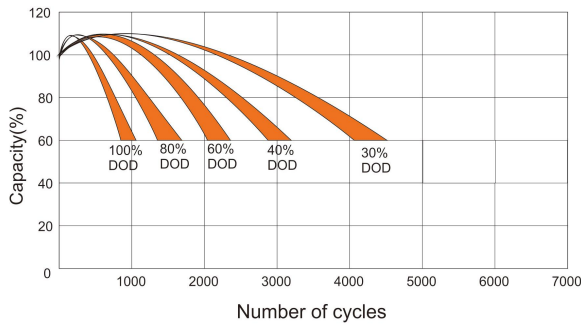

### Temperature effects on Capacity

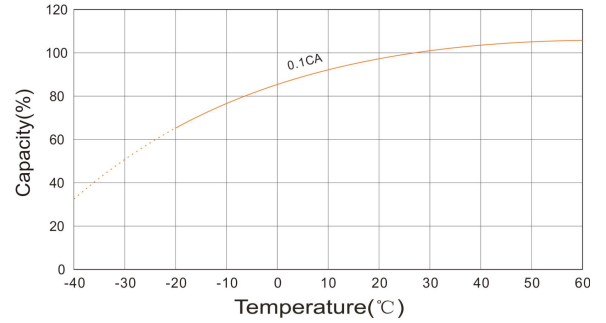

### Relationship between charging voltage and temperature

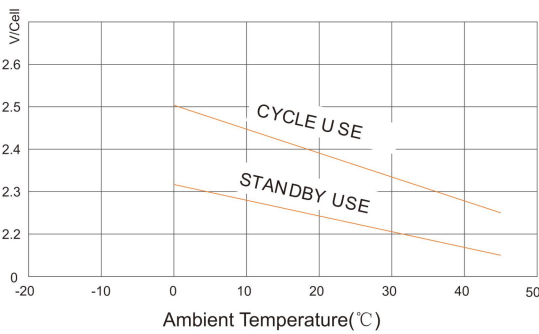

### Self-discharge Characteristics

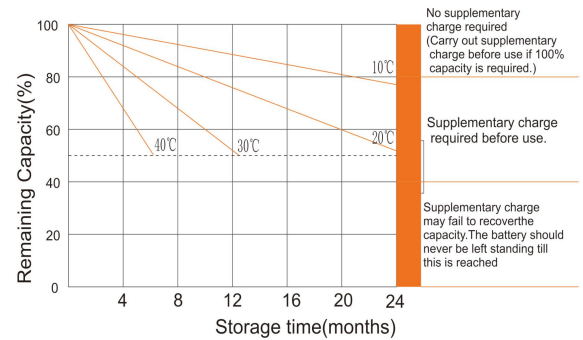

### Temperature effects on Float life

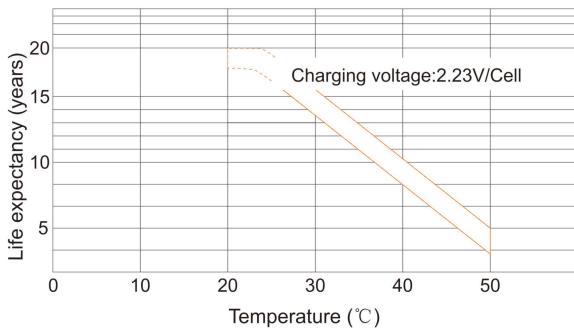

### Life Characteristics of Standby use

