

Motive Battery

Energy Storage Battery

Reserve Battery

Motorcycle Battery



## Energy Storage Battery-Tubular GEL Technology-OPzV Series

# OPzV2000

(2V 2000Ah)

### GENERAL FEATURES

- ◆ 20 years design life at floating condition
- ◆ Wide operating temperature range from -40°C to +60°C
- ◆ Tubular positive plate with prolonged cycle life
- ◆ Fumed silica gel electrolyte
- ◆ lead-calcium grid significantly improves the corrosion resistance ability
- ◆ Low self-discharge rate and long shelf life
- ◆ Excellent deep discharge recovery capability



### Application

- ◆ Renewable energy system
- ◆ Hybrid solar power system
- ◆ Uninterrupted Power Supply (UPS)
- ◆ Communications and electric equipment
- ◆ Emergency lighting equipment
- ◆ Fire alarm and security systems
- ◆ Control equipment, and other factory automation equipment
- ◆ Emergency power supply (EPS)
- ◆ Lighting equipment

### Dimension

Unit:mm

Length 399±2mm / 15.71inch

Width 212±2mm / 8.35inch

Container Height 770±3mm / 30.31inch

Total Height 802±3mm / 31.57inch

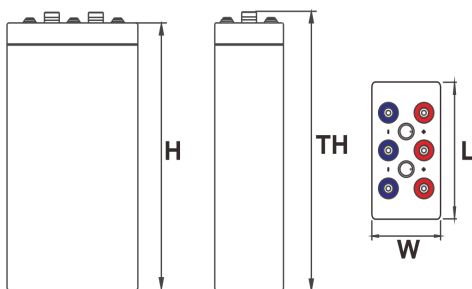

### Terminal

Unit:mm

Terminal Type: I7

### Weight

153kg 337.3lbs

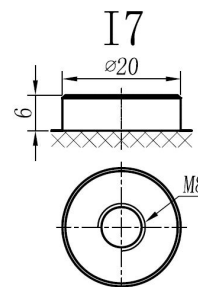

ISO9001 ISO14001 OHSAS18001

This document is subject to change without prior notification

Motive Battery Energy Storage Battery Reserve Battery Motorcycle Battery

## OPzV2000

### Specification

<b>Nominal Voltage</b>	2V	
<b>Rated Capacity(25°C)</b>	2120Ah	20hr Rate(1.80V/cell)
	2000Ah	10hr Rate(1.80V/cell)
	1746Ah	5hr Rate(1.75V/cell)
	1565Ah	3hr Rate(1.70V/cell)
	1197Ah	1hr Rate(1.60V/cell)
<b>Container Material</b>	ABS (Fire-proofing ABS container available)	
<b>Operating Temperature Range</b>	<b>Discharge</b>	-40 ~ +60°C
	<b>Charge</b>	0 ~ +40°C
	<b>Storage</b>	-20 ~ +40°C
<b>Capacity Effected by Temperature</b>	<b>40°C / 104°F</b>	106%
	<b>25°C / 77°F</b>	100%
	<b>0°C / 32°F</b>	86%
	<b>-20°C / -4°F</b>	60%
<b>Charge Voltage</b>	<b>Float Voltage</b>	2.23V/cell@25°C, Compensation Factor: -3mV/cell/°C
	<b>Equalize Voltage</b>	2.35 -2.40V/cell@25°C, Compensation Factor: -3mV/cell/°C
	<b>Cycle Voltage</b>	2.40 -2.50V/cell@25°C, Compensation Factor: -5mV/cell/°C
<b>Max Charging Current</b>	400A (0.2C)	
<b>Max. Discharge Current (5S)</b>	12000A	
<b>Internal Resistance</b>	0.32mΩ	
<b>Self Discharge</b>	<3%, OPZV series stored at 25 °C require a supplementary charge every six months, the charging interval would shrink when the ambient temperature went higher	

### Discharge Performance

Constant Current Discharge Table (25°C/77°F) Unit: A

F.V/Time	15min	30min	1h	2h	3h	5h	8h	10h	20h
1.85V/cell	1510	1209	906	623	476	328	234	194	102
1.80V/cell	1677	1332	996	660	499	340	243	200	106
1.75V/cell	1791	1420	1048	692	511	349	249	205	108
1.70V/cell	1898	1502	1102	712	522	357	252	208	110
1.65V/cell	2000	1583	1146	732	531	363	256	210	111
1.60V/cell	2110	1633	1197	744	536	367	258	212	112

Constant Power Discharge Table (25°C/77°F) Unit: W

F.V/Time	15min	30min	1h	2h	3h	5h	8h	10h	20h
1.85V/cell	2837	2295	1736	1203	923	640	458	381	202
1.80V/cell	3084	2478	1880	1264	960	658	473	390	208
1.75V/cell	3244	2604	1962	1316	977	672	481	398	212
1.70V/cell	3384	2722	2047	1347	993	685	486	401	215
1.65V/cell	3504	2835	2112	1377	1007	693	492	404	215
1.60V/cell	3637	2878	2184	1389	1012	698	495	407	216



Motive



Energy Storage Battery



Reserve Battery



Motorcycle Battery

### Discharge Characteristics Curve

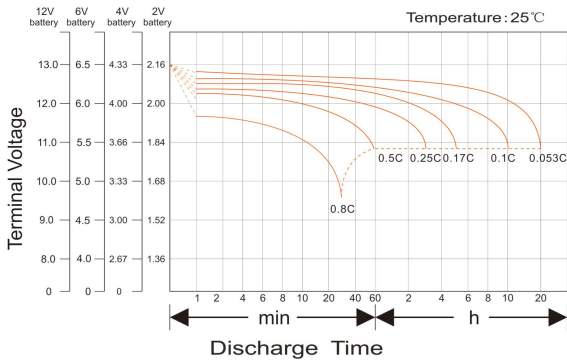

### Charging Characteristics Curve

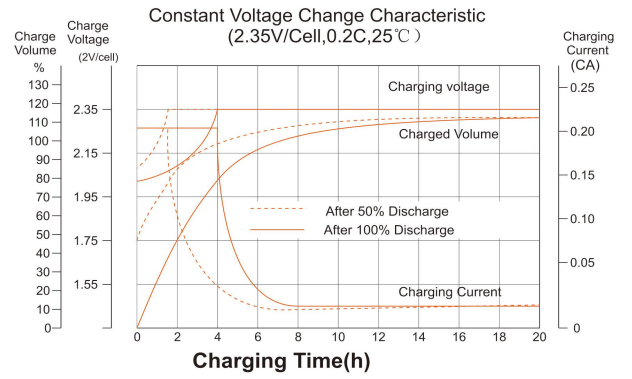

### Cycle life in relation to depth of Discharge

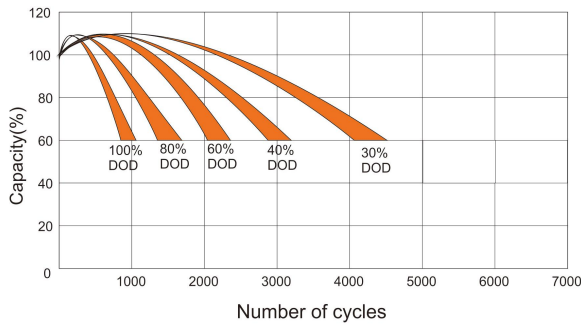

### Temperature effects on Capacity

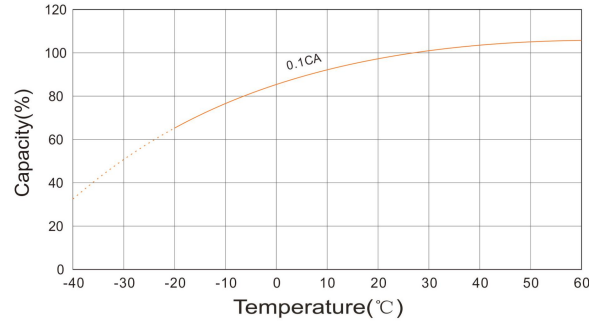

### Relationship between charging voltage and temperature

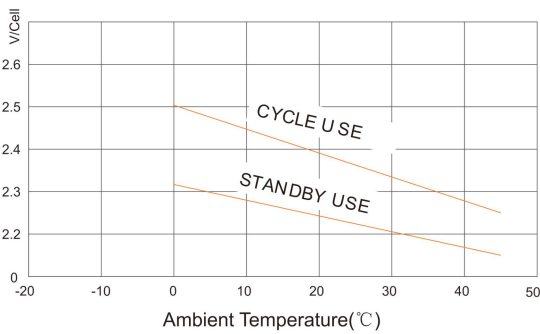

### Self-discharge Characteristics

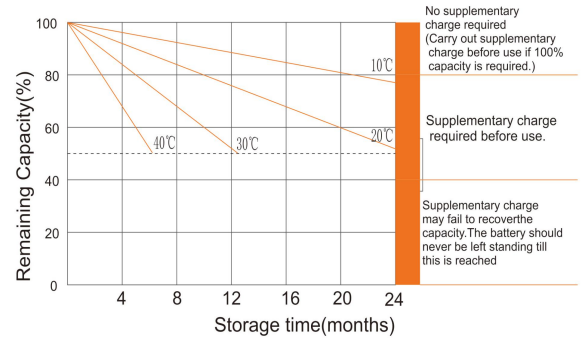

### Temperature effects on Float life

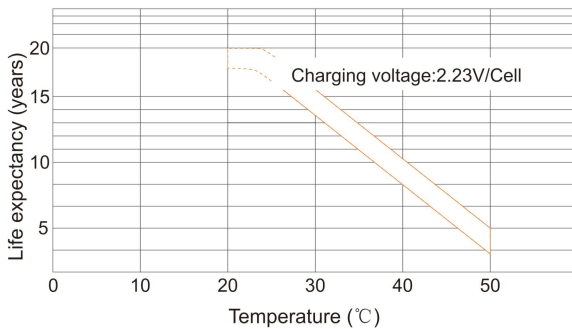

### Life Characteristics of Standby use

