

Motive Battery

Energy Storage Battery

Reserve Battery

Motorcycle Battery



## Energy Storage Battery-Tubular GEL Technology-OPzV Series

# OPzV800E

(2V 800Ah)

## GENERAL FEATURES

- ◆ 20 years design life at floating condition
- ◆ Wide operating temperature range from -40°C to +60°C
- ◆ Tubular positive plate with prolonged cycle life
- ◆ Fumed silica gel electrolyte
- ◆ lead-calcium grid significantly improves the corrosion resistance ability
- ◆ Low self-discharge rate and long shelf life
- ◆ Excellent deep discharge recovery capability



## Application

- ◆ Renewable energy system
- ◆ Hybrid solar power system
- ◆ Uninterrupted Power Supply (UPS)
- ◆ Communications and electric equipment
- ◆ Emergency lighting equipment
- ◆ Fire alarm and security systems
- ◆ Control equipment, and other factory automation equipment
- ◆ Emergency power supply (EPS)
- ◆ Lighting equipment

## Dimension

Unit:mm

Length	191±2mm / 7.52inch
Width	210±2mm / 8.27inch
Container Height	646±3mm / 25.43inch
Total Height	678±3mm / 26.69inch

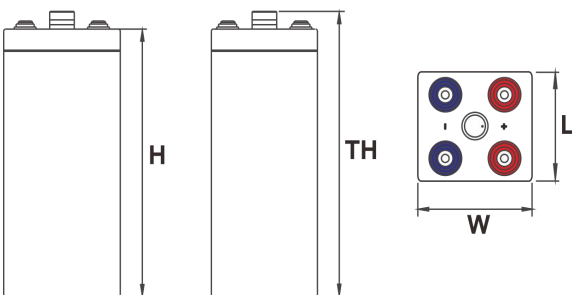

## Terminal

Unit:mm

Terminal Type: I7

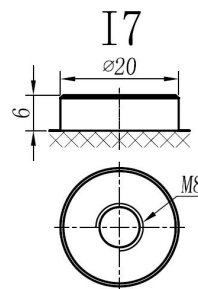

## Weight

60.9kg 134.26lbs



ISO9001 ISO14001 OHSAS18001

This document is subject to change without prior notification

Motive Battery

Energy Storage Battery



Reserve Battery

Motorcycle Battery

# OPzV800E

## Specification

<b>Nominal Voltage</b>	2V	
<b>Rated Capacity(25°C)</b>	848Ah	20hr Rate(1.80V/cell)
	800Ah	10hr Rate(1.80V/cell)
	698Ah	5hr Rate(1.75V/cell)
	626Ah	3hr Rate(1.70V/cell)
	479Ah	1hr Rate(1.60V/cell)
<b>Container Material</b>	ABS (Fire-proofing ABS container available)	
<b>Operating Temperature Range</b>	<b>Discharge</b>	-40 ~ +60°C
	<b>Charge</b>	0 ~ +40°C
	<b>Storage</b>	-20 ~ +40°C
<b>Capacity Effected by Temperature</b>	<b>40°C / 104°F</b>	106%
	<b>25°C / 77°F</b>	100%
	<b>0°C / 32°F</b>	86%
	<b>-20°C / -4°F</b>	60%
<b>Charge Voltage</b>	<b>Float Voltage</b>	2.23V/cell@25°C, Compensation Factor: -3mV/cell/°C
	<b>Equalize Voltage</b>	2.35 -2.40V/cell@25°C, Compensation Factor: -3mV/cell/°C
	<b>Cycle Voltage</b>	2.40 -2.50V/cell@25°C, Compensation Factor: -5mV/cell°C
<b>Max Charging Current</b>	160A (0.2C)	
<b>Max. Discharge Current (5S)</b>	4800A	
<b>Internal Resistance</b>	0.4mΩ	
<b>Self Discharge</b>	<3%, OPZV series stored at 25 °C require a supplementary charge every six months, the charging interval would shrink when the ambient temperature went higher	

## Discharge Performance

Constant Current Discharge Table (25°C/77°F) Unit: A

F.V/Time	15min	30min	1h	2h	3h	5h	8h	10h	20h
1.85V/cell	574	459	362	249	190	131	93.6	77.4	40.9
1.80V/cell	637	506	398	264	199	136	97.3	80.0	42.4
1.75V/cell	681	540	419	277	204	140	99.5	82.0	43.4
1.70V/cell	721	571	441	285	209	143	101	83.1	44.1
1.65V/cell	760	601	458	293	212	145	102	83.9	44.4
1.60V/cell	802	620	479	298	214	147	103	84.8	44.6

Constant Power Discharge Table (25°C/77°F) Unit: W

F.V/Time	15min	30min	1h	2h	3h	5h	8h	10h	20h
1.85V/cell	1078	872	695	481	369	256	183	152	80.9
1.80V/cell	1172	942	752	505	384	263	189	156	83.2
1.75V/cell	1233	990	785	526	391	269	193	159	84.7
1.70V/cell	1286	1034	819	539	397	274	194	161	85.8
1.65V/cell	1332	1077	845	551	403	277	197	162	86.2
1.60V/cell	1382	1094	874	556	405	279	198	163	86.3



Motive



Energy Storage Battery



Reserve Battery



Motorcycle Battery

### Discharge Characteristics Curve

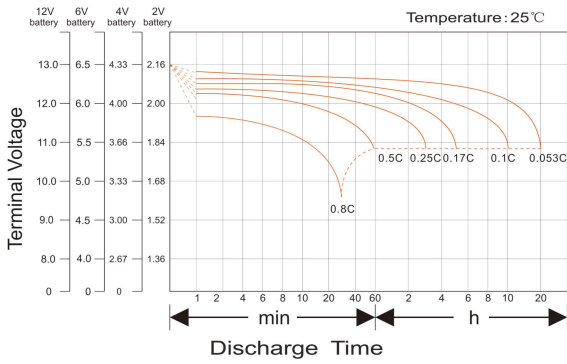

### Charging Characteristics Curve

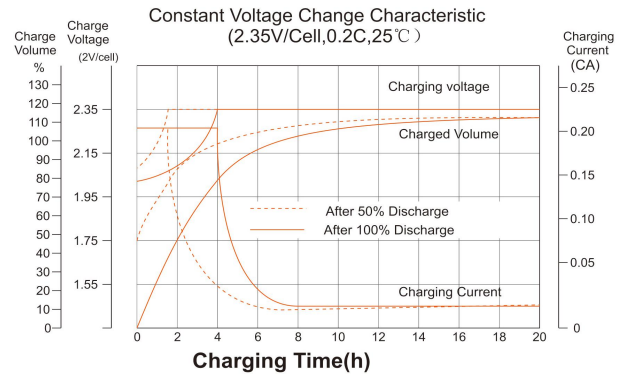

### Cycle life in relation to depth of Discharge

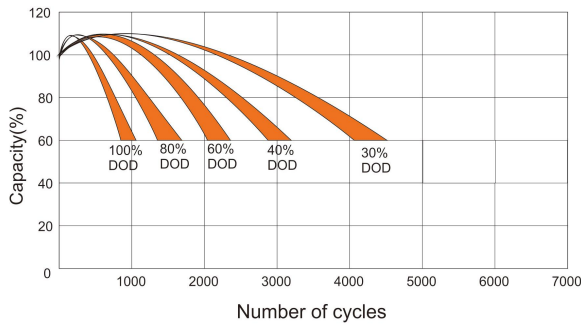

### Temperature effects on Capacity

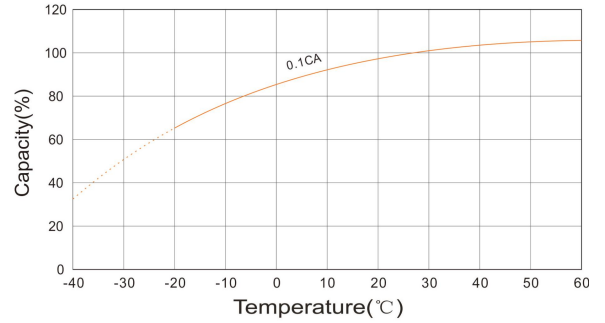

### Relationship between charging voltage and temperature

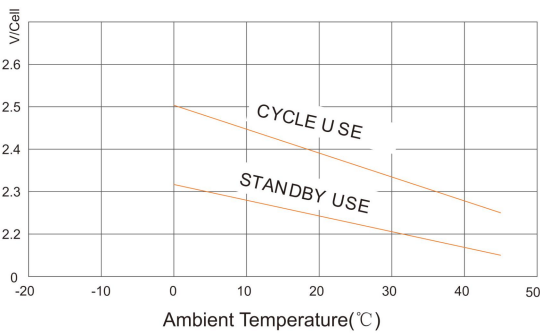

### Self-discharge Characteristics

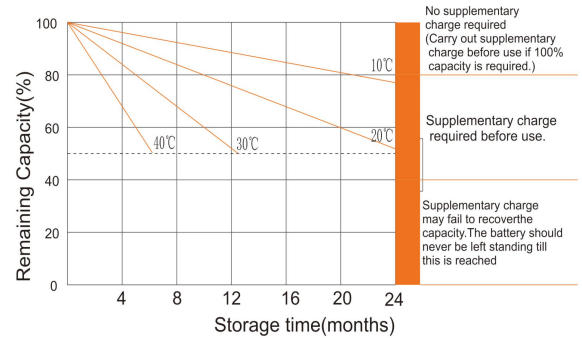

### Temperature effects on Float life

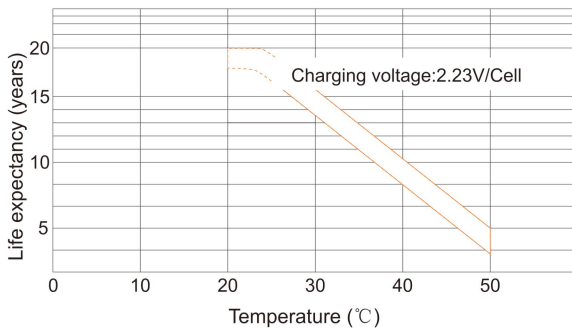

### Life Characteristics of Standby use

