

Motive Battery

Energy Storage Battery

Reserve Battery

Motorcycle Battery



Industry Battery-General Purpose AGM Battery-TN Series

TN12-15

(12V 15Ah)

GENERAL FEATURES

- Oxygen recombination technology: maintenance-free, no need to add water or acid
- The patent grid alloy: less gassing, low self-discharge, excellent corrosion resistance
- Design life is 3~5 years at 25°C under standby application, deep discharge recoverability
- High quality AGM separator: extend cycle life and prevent micro short circuit
- ABS container: increase the strength of battery (Flame-retardant ABS UL94-V0 is optional)

Dimension

Unit:mm

Length	182±2mm / 7.17inch
Width	76±2mm / 2.99inch
Container Height	170±3mm / 6.69inch
Total Height	170±3mm / 6.69inch

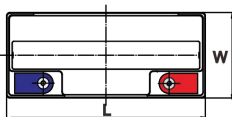
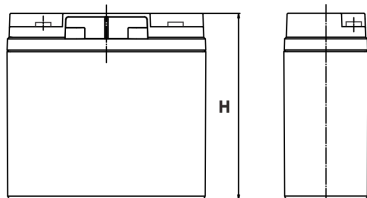

Application

- Uninterrupted Power Supply (UPS)
- Communications and electric equipment
- Emergency lighting equipment
- Fire alarm and security system
- Robots, control equipment, and other factory automation equipment
- Emergency power supply (EPS)
- Portable VTR/TV, radio and so on
- Power tools, lawn mowers, vacuum cleaners
- Cameras and photographic equipment
- Portable measuring equipment
- Portable telephone sets
- Various power toys and hobby equipment
- Lighting equipment

Terminal

Unit:mm

Terminal Type: I10

Weight

5kg

11.02lbs

I10

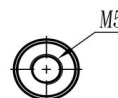
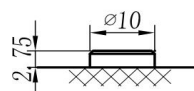

This document is subject to change without prior notification

Motive Battery

Energy Storage Battery

Reserve Battery

Motorcycle Battery



TN12-15

Specificaion

Nominal Voltage	12V	
Rated Capacity(25°C)	15.02Ah	20hr Rate(1.80V/cell)
	14.01Ah	10hr Rate(1.80V/cell)
	12.94Ah	5hr Rate(1.75V/cell)
	11.97Ah	3hr Rate(1.70V/cell)
	9.56Ah	1hr Rate(1.60V/cell)
Container Material	ABS (Flame-retardant ABS UL94-V0 is optional)	
Operating Temperature Range	Discharge	-20 ~ +50°C
	Charge	0 ~ +40°C
	Storage	-15 ~ +40°C
Capacity Effected by Temperature	40°C / 104°F	106%
	25°C / 77°F	100%
	0°C / 32°F	86%
	-10°C / 14°F	65%
Charge	Float Voltage	2.23 -2.27V/cell@25°C, Tem.Coefficient : -3mV/cell/°C
	Equalize Voltage	2.35 -2.40V/cell@25°C, Tem.Coefficient : -3mV/cell/°C
	Cycle Voltage	2.40 -2.50V/cell@25°C, Tem.Coefficient : -5mV/cell/°C
Max. Charging Current	4.5A (0.3C)	
Max. Discharge Current (5S)	225A	
Internal Resistance	18mΩ	
Self-Discharge	<3%, TN series stored at 25 °C require a supplementary charge every six months, the charging interval would shrink when the ambient temperature went higher	

Discharge Performance

Constant Current Discharge Table (25°C/77°F) Unit: A

F.V/Time	5min	10min	15min	20min	30min	45min	1h	2h	3h	4h	5h	6h	8h	10h	20h
1.85V/cell	28.6	21.9	18.2	15.7	12.1	9.1	7.65	4.53	3.54	2.88	2.34	2.03	1.64	1.351	0.741
1.80V/cell	38.3	28.0	22.0	18.6	14.3	10.6	8.58	4.94	3.82	3.08	2.52	2.17	1.74	1.401	0.751
1.75V/cell	43.2	30.8	24.0	20.0	14.9	11.0	8.97	5.13	3.89	3.15	2.59	2.23	1.77	1.431	0.761
1.70V/cell	47.6	33.6	25.6	21.0	15.5	11.4	9.26	5.26	3.99	3.23	2.65	2.28	1.79	1.461	0.771
1.67V/cell	52.6	36.2	27.2	22.3	16.3	11.7	9.47	5.33	4.16	3.34	2.73	2.33	1.82	1.491	0.781
1.60V/cell	58.0	39.3	29.1	23.8	17.3	12.2	9.56	5.56	4.28	3.44	2.82	2.38	1.84	1.512	0.791

Constant Power Discharge Table (25°C/77°F) Unit: W

F.V/Time	5min	10min	15min	20min	30min	45min	1h	2h	3h	4h	5h	6h	8h	10h	20h
1.85V/cell	52.3	40.5	33.9	29.6	23.2	17.2	14.61	8.67	6.81	5.56	4.54	3.95	3.20	2.683	1.471
1.80V/cell	69.5	51.3	40.4	34.5	26.9	19.9	16.22	9.40	7.29	5.90	4.85	4.22	3.38	2.763	1.481
1.75V/cell	76.6	55.4	43.6	36.8	27.7	20.4	16.92	9.71	7.39	6.01	4.96	4.32	3.43	2.833	1.502
1.70V/cell	82.0	59.0	45.9	38.3	28.7	21.1	17.42	9.93	7.59	6.16	5.09	4.40	3.48	2.883	1.522
1.67V/cell	89.2	63.1	48.4	40.4	30.0	21.5	17.62	10.01	7.88	6.35	5.21	4.49	3.52	2.943	1.542
1.60V/cell	96.1	67.0	51.0	42.6	31.4	22.3	17.72	10.41	8.08	6.53	5.36	4.57	3.55	2.963	1.552

□ 动力电池

■ 储能电池

■ 备用电池

□ 摩托车电池



阀控式免维护铅酸蓄电池-通用型

TN12-15

(12V 15Ah)

产品特点

- ◆ 阀控式免维护设计，寿命期间无需加水或加酸
- ◆ 专利稀土合金板栅，减少气体产生，自放电率低，抗腐蚀能力出众
- ◆ 在25°C下，产品浮充设计寿命为3~5年，优良的深放电恢复能力
- ◆ 高质量AGM隔板：防止微短路，延长循环寿命
- ◆ ABS壳盖：电池外壳强度高（阻燃壳体UL94-V0可选）



尺寸

单个尺寸

长	182±2mm
宽	76±2mm
高	170±3mm
总高	170±3mm

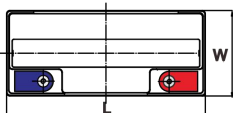
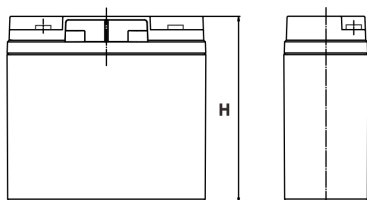

产品应用

- ◆ 不间断电源(UPS)
- ◆ 通信和电力设备
- ◆ 紧急照明设备
- ◆ 火灾报警及安防系统
- ◆ 机器人、控制设备及其他机械自动化设备
- ◆ 应急电源系统
- ◆ 便携式音频设备
- ◆ 电动工具，割草机，真空吸尘器
- ◆ 照相设备
- ◆ 便携式测量工具
- ◆ 便携式通话设备
- ◆ 各式电动玩具及娱乐设施
- ◆ 照明设备

端子类型

单位:mm

端子类型 I10

重量

5kg 11.02lbs

I10

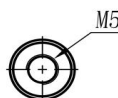
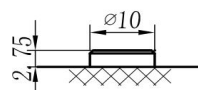

内容如有改动，恕不另行通知



动力电池

储能电池

备用电池

摩托车电池



TN12-15

规格书

额定电压	12V	
容量(25°C)	15.02Ah 20hr Rate(1.80V/cell)	
	14.01Ah 10hr Rate(1.80V/cell)	
	12.94Ah 5hr Rate(1.75V/cell)	
	11.97Ah 3hr Rate(1.70V/cell)	
	9.56Ah 1hr Rate(1.60V/cell)	
壳体材料	ABS (阻燃ABS壳体可选)	
使用温度范围	放电	-20 ~ +50°C
	充电	0 ~ +40°C
	储存	-15 ~ +40°C
不同温度下 电池容量系数	40°C / 104°F	106%
	25°C / 77°F	100%
	0°C / 32°F	86%
	-10°C / 14°F	65%
充电	浮充电压	2.23 -2.27V/单格@25°C, 温度补偿系数: -3mV/单格/°C
	均充电压	2.35 -2.40V/单格@25°C, 温度补偿系数: -3mV/单格/°C
	循环使用电压	2.40 -2.50V/单格@25°C, 温度补偿系数: -5mV/单格/°C
最大充电电流	4.5A (0.3C)	
最大放电电流 (5S)	225A	
电阻	18mΩ	
自放电	<3%, TN系列储存在25°C时需每6个月进行一次补充充电, 环境温度更高时则充电间隔时间越短	

放电性能

恒电流放电表 (25°C/77°F) 单位: A															
F.V/Time	5min	10min	15min	20min	30min	45min	1h	2h	3h	4h	5h	6h	8h	10h	20h
1.85V/cell	28.6	21.9	18.2	15.7	12.1	9.1	7.65	4.53	3.54	2.88	2.34	2.03	1.64	1.351	0.741
1.80V/cell	38.3	28.0	22.0	18.6	14.3	10.6	8.58	4.94	3.82	3.08	2.52	2.17	1.74	1.401	0.751
1.75V/cell	43.2	30.8	24.0	20.0	14.9	11.0	8.97	5.13	3.89	3.15	2.59	2.23	1.77	1.431	0.761
1.70V/cell	47.6	33.6	25.6	21.0	15.5	11.4	9.26	5.26	3.99	3.23	2.65	2.28	1.79	1.461	0.771
1.67V/cell	52.6	36.2	27.2	22.3	16.3	11.7	9.47	5.33	4.16	3.34	2.73	2.33	1.82	1.491	0.781
1.60V/cell	58.0	39.3	29.1	23.8	17.3	12.2	9.56	5.56	4.28	3.44	2.82	2.38	1.84	1.512	0.791

恒功率放电表 (25°C/77°F) 单位: W															
F.V/Time	5min	10min	15min	20min	30min	45min	1h	2h	3h	4h	5h	6h	8h	10h	20h
1.85V/cell	52.3	40.5	33.9	29.6	23.2	17.2	14.61	8.67	6.81	5.56	4.54	3.95	3.20	2.683	1.471
1.80V/cell	69.5	51.3	40.4	34.5	26.9	19.9	16.22	9.40	7.29	5.90	4.85	4.22	3.38	2.763	1.481
1.75V/cell	76.6	55.4	43.6	36.8	27.7	20.4	16.92	9.71	7.39	6.01	4.96	4.32	3.43	2.833	1.502
1.70V/cell	82.0	59.0	45.9	38.3	28.7	21.1	17.42	9.93	7.59	6.16	5.09	4.40	3.48	2.883	1.522
1.67V/cell	89.2	63.1	48.4	40.4	30.0	21.5	17.62	10.01	7.88	6.35	5.21	4.49	3.52	2.943	1.542
1.60V/cell	96.1	67.0	51.0	42.6	31.4	22.3	17.72	10.41	8.08	6.53	5.36	4.57	3.55	2.963	1.552