

Motive Battery

Energy Storage Battery

Reserve Battery

Motorcycle Battery



## Industry Battery-General Purpose AGM Battery-TN Series

# TN12-200E

(12V 200Ah)

### GENERAL FEATURES

- ◆ Oxygen recombination technology: maintenance-free, no need to add water or acid
- ◆ The patent grid alloy: less gassing, low self-discharge, excellent corrosion resistance
- ◆ Design life is 7~9 years at 25°C under standby application, deep discharge recoverability
- ◆ High quality AGM separator: extend cycle life and prevent micro short circuit
- ◆ ABS container: increase the strength of battery (Flame-retardant ABS UL94-V0 is optional)

### Dimension

Unit:mm

Length	520±2mm	/	20.47inch
Width	239±2mm	/	9.41inch
Container Height	220±3mm	/	8.66inch
Total Height	225±3mm	/	8.86inch

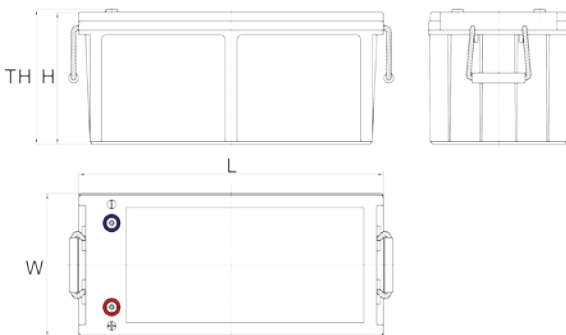

### Application

- ◆ Uninterrupted Power Supply ( UPS )
- ◆ Communications and electric equipment
- ◆ Emergency lighting equipment
- ◆ Fire alarm and security system
- ◆ Control equipment, and other factory automation equipment
- ◆ Emergency power supply ( EPS )
- ◆ Portable VTR/TV, radio and so on
- ◆ Power tools, lawn mowers, vacuum cleaners
- ◆ Cameras and photographic equipment
- ◆ Portable measuring equipment
- ◆ Portable telephone sets
- ◆ Various power toys and hobby equipment
- ◆ Lighting equipment

### Terminal

Unit:mm

Terminal Type: I7

### Weight

57.1kg 126.24lbs

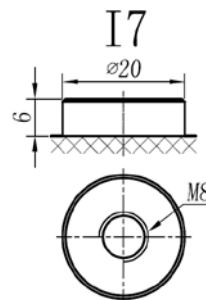

ISO9001 ISO14001 OHSAS18001

This document is subject to change without prior notification

Motive Battery

Energy Storage Battery

Reserve Battery

Motorcycle Battery



## TN12-200E

### Specificaion

<b>Nominal Voltage</b>	12V	
<b>Rated Capacity(25°C)</b>	200Ah	20hr Rate (1.80V/cell)
	193Ah	10hr Rate (1.80V/cell)
	171Ah	5hr Rate (1.75V/cell)
	160Ah	3hr Rate (1.70V/cell)
	113Ah	1hr Rate (1.60V/cell)
<b>Container Material</b>	ABS ( Flame-retardant ABS UL94-V0 is optional )	
<b>Operating Temperature Range</b>	<b>Discharge</b>	-20 ~ +50°C
	<b>Charge</b>	0 ~ +40°C
	<b>Storage</b>	-15 ~ +40°C
<b>Capacity Effected by Temperature</b>	40°C / 104°F	106%
	25°C / 77°F	100%
	0°C / 32°F	86%
	-10°C / 14°F	65%
<b>Charge</b>	<b>Float Voltage</b>	2.23 -2.27V/cell@25°C, Tem.Coefficient : -3mV/cell/°C
	<b>Equalize Voltage</b>	2.35 -2.40V/cell@25°C, Tem.Coefficient : -3mV/cell/°C
	<b>Cycle Voltage</b>	2.40 -2.50V/cell@25°C, Tem.Coefficient : -5mV/cell°C
<b>Max. Charging Current</b>	60A ( 0.3C)	
<b>Max. Discharge Current (5S)</b>	2000A	
<b>Internal Resistance</b>	2.7mΩ	
<b>Self-Discharge</b>	<3%, TN series stored at 25 °C require a supplementary charge every six months, the charging interval would shrink when the ambient temperature went higher	

### Discharge Performance

Constant Current Discharge Table (25°C/77°F) Unit: A

F.V/Time	10min	15min	20min	30min	45min	1h	2h	3h	4h	5h	6h	8h	10h	20h
1.85V/cell	297.0	247.1	206.5	159.9	120.7	97.60	61.39	47.52	38.60	31.70	27.31	22.05	18.67	9.956
1.80V/cell	345.9	280.3	230.2	175.7	132.9	105.75	65.33	50.22	40.58	33.31	28.70	22.93	19.33	10.010
1.75V/cell	378.5	299.6	243.1	184.1	138.1	109.88	67.85	51.67	41.66	34.19	29.41	23.29	19.54	10.193
1.70V/cell	410.6	319.3	257.4	192.6	142.6	113.44	70.18	53.47	42.89	35.06	30.03	23.64	19.79	10.361
1.67V/cell	444.4	340.4	274.3	201.9	147.3	117.36	72.34	55.43	44.29	36.15	30.69	24.00	20.09	10.437
1.60V/cell	389.5	313.0	259.1	191.3	141.0	113.17	70.74	54.26	43.48	35.89	30.82	24.57	20.59	10.939

Constant Power Discharge Table (25°C/77°F) Unit: W

F.V/Time	10min	15min	20min	30min	45min	1h	2h	3h	4h	5h	6h	8h	10h	20h
1.85V/cell	545.2	458.0	386.4	302.4	228.1	185.15	117.12	91.08	74.16	61.16	53.11	43.05	36.93	19.699
1.80V/cell	626.4	513.1	425.6	328.5	248.8	199.58	124.08	95.86	77.65	63.98	55.62	44.64	38.16	19.902
1.75V/cell	672.5	541.2	445.6	341.8	256.7	206.62	128.45	98.30	79.53	65.55	56.84	45.30	38.52	20.102
1.70V/cell	717.7	570.3	468.2	355.0	263.5	212.27	132.38	101.40	81.66	67.03	57.90	45.91	39.02	20.408
1.67V/cell	764.5	600.9	494.4	369.5	270.3	218.21	135.63	104.66	84.05	68.80	59.01	46.57	39.58	20.612
1.60V/cell	683.2	562.2	474.2	355.4	262.0	212.22	133.69	103.14	82.92	68.78	59.54	47.78	40.66	21.620

动力电池

储能电池

备用电池

摩托车电池



## 阀控式免维护铅酸蓄电池-通用型

# TN12-200E

(12V 200Ah)

### 产品特点

- ◆ 阀控式免维护设计，寿命期间无需加水或加酸
- ◆ 专利稀土合金板栅，减少气体产生，自放电率低，抗腐蚀能力出众
- ◆ 在25°C下，产品浮充设计寿命为7~9年，优良的深放电恢复能力
- ◆ 高质量AGM隔板：防止微短路，延长循环寿命
- ◆ ABS壳盖：电池外壳强度高（阻燃壳体UL94-V0可选）

### 尺寸

单个尺寸

长	520±2mm
宽	239±2mm
高	220±3mm
总高	225±3mm

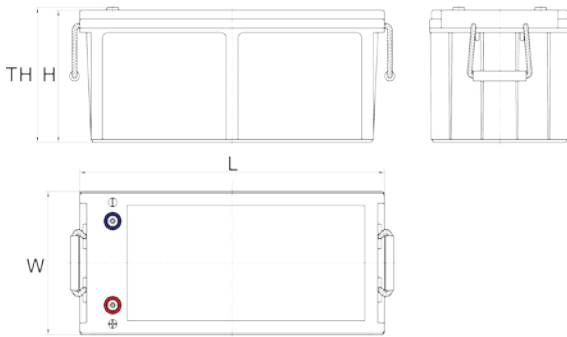

### 产品应用

- ◆ 不间断电源(UPS)
- ◆ 通信和电力设备
- ◆ 紧急照明设备
- ◆ 火灾报警及安防系统
- ◆ 控制设备及其他机械自动化设备
- ◆ 应急电源系统
- ◆ 便携式音频设备
- ◆ 电动工具，割草机，真空吸尘器
- ◆ 照相设备
- ◆ 便携式测量工具
- ◆ 便携式通话设备
- ◆ 各式电动玩具及娱乐设施
- ◆ 照明设备

### 端子类型

单位:mm

端子类型 I7

### 重量

57.1kg 126.24lbs

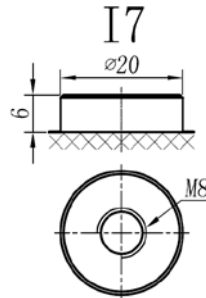

内容如有改动，恕不另行通知



ISO9001 ISO14001 OHSAS18001

天能电池集团有限公司

长兴天能进出口有限公司

www.tiannenggroup.com

版本：

V1.0

发行日期：

2016/7/1

©2016 天能集团 版权所有，保留一切权利；商标所有权属于天能集团及其附属机构

浙江省长兴画溪工业区包桥路18号天能集团 邮编：313199

□ 动力电池

■ 储能电池

■ 备用电池

□ 摩托车电池



# TN12-200E

## 规格书

额定电压	12V	
容量(25°C)	200Ah	20hr Rate (1.80V/cell)
	193Ah	10hr Rate (1.80V/cell)
	171Ah	5hr Rate (1.75V/cell)
	160Ah	3hr Rate (1.70V/cell)
	113Ah	1hr Rate (1.60V/cell)
壳体材料	ABS (阻燃ABS壳体可选)	
使用温度范围	放电	-20 ~ +50°C
	充电	0 ~ +40°C
	储存	-15 ~ +40°C
不同温度下 电池容量系数	40°C / 104°F	106%
	25°C / 77°F	100%
	0°C / 32°F	86%
	-10°C / 14°F	65%
充电	浮充电压	2.23 -2.27V/单格@25°C, 温度补偿系数: -3mV/单格/°C
	均充电压	2.35 -2.40V/单格@25°C, 温度补偿系数: -3mV/单格/°C
	循环使用电压	2.40 -2.50V/单格@25°C, 温度补偿系数: -5mV/单格/°C
最大充电电流	60A (0.3C)	
最大放电电流 (5S)	2000A	
电阻	2.7mΩ	
自放电	<3%, TN系列储存在25°C 时需每6个月进行一次补充充电, 环境温度更高时则充电间隔时间越短	

## 放电性能

F.V/Time	恒电流放电表 (25°C/77°F) 单位: A													
	10min	15min	20min	30min	45min	1h	2h	3h	4h	5h	6h	8h	10h	20h
1.85V/cell	297.0	247.1	206.5	159.9	120.7	97.60	61.39	47.52	38.60	31.70	27.31	22.05	18.67	9.956
1.80V/cell	345.9	280.3	230.2	175.7	132.9	105.75	65.33	50.22	40.58	33.31	28.70	22.93	19.33	10.010
1.75V/cell	378.5	299.6	243.1	184.1	138.1	109.88	67.85	51.67	41.66	34.19	29.41	23.29	19.54	10.193
1.70V/cell	410.6	319.3	257.4	192.6	142.6	113.44	70.18	53.47	42.89	35.06	30.03	23.64	19.79	10.361
1.67V/cell	444.4	340.4	274.3	201.9	147.3	117.36	72.34	55.43	44.29	36.15	30.69	24.00	20.09	10.437
1.60V/cell	389.5	313.0	259.1	191.3	141.0	113.17	70.74	54.26	43.48	35.89	30.82	24.57	20.59	10.939

F.V/Time	恒功率放电表 (25°C/77°F) 单位: W													
	10min	15min	20min	30min	45min	1h	2h	3h	4h	5h	6h	8h	10h	20h
1.85V/cell	545.2	458.0	386.4	302.4	228.1	185.15	117.12	91.08	74.16	61.16	53.11	43.05	36.93	19.699
1.80V/cell	626.4	513.1	425.6	328.5	248.8	199.58	124.08	95.86	77.65	63.98	55.62	44.64	38.16	19.902
1.75V/cell	672.5	541.2	445.6	341.8	256.7	206.62	128.45	98.30	79.53	65.55	56.84	45.30	38.52	20.102
1.70V/cell	717.7	570.3	468.2	355.0	263.5	212.27	132.38	101.40	81.66	67.03	57.90	45.91	39.02	20.408
1.67V/cell	764.5	600.9	494.4	369.5	270.3	218.21	135.63	104.66	84.05	68.80	59.01	46.57	39.58	20.612
1.60V/cell	683.2	562.2	474.2	355.4	262.0	212.22	133.69	103.14	82.92	68.78	59.54	47.78	40.66	21.620