

Motive Battery

Energy Storage Battery

Reserve Battery

Motorcycle Battery



## Industry Battery-General Purpose AGM Battery-TN Series

# TN12-30A

(12V 30Ah)

### GENERAL FEATURES

- Oxygen recombination technology: maintenance-free, no need to add water or acid
- The patent grid alloy: less gassing, low self-discharge, excellent corrosion resistance
- Design life is 3~5 years at 25°C under standby application, deep discharge recoverability
- High quality AGM separator: extend cycle life and prevent micro short circuit
- ABS container: increase the strength of battery (Flame-retardant ABS UL94-V0 is optional)

### Dimension

Unit:mm

Length 166±2mm / 6.54inch

Width 175±2mm / 6.89inch

Container Height 125±3mm / 4.92inch

Total Height 125±3mm / 4.92inch

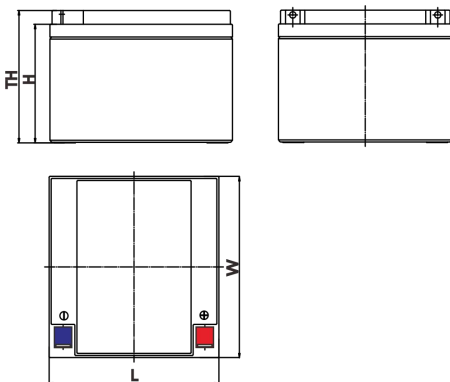

### Application

- Uninterrupted Power Supply ( UPS )
- Communications and electric equipment
- Emergency lighting equipment
- Fire alarm and security system
- Robots, control equipment, and other factory automation equipment
- Emergency power supply ( EPS )
- Portable VTR/TV, radio and so on
- Power tools, lawn mowers, vacuum cleaners
- Cameras and photographic equipment
- Portable measuring equipment
- Portable telephone sets
- Various power toys and hobby equipment
- Lighting equipment

### Terminal

Unit:mm

Terminal Type: L1

### Weight

8.6kg

18.96lbs

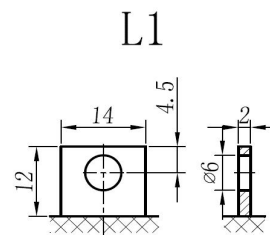

This document is subject to change without prior notification

Motive Battery Energy Storage Battery Reserve Battery Motorcycle Battery

## TN12-30A

### Specification

<b>Nominal Voltage</b>	12V	
<b>Rated Capacity(25°C)</b>	30.03Ah	20hr Rate(1.80V/cell )
	27.93Ah	10hr Rate(1.80V/cell )
	25.88Ah	5hr Rate(1.75V/cell )
	23.93Ah	3hr Rate(1.70V/cell )
	19.08Ah	1hr Rate(1.60V/cell )
<b>Container Material</b>	ABS ( Flame-retardant ABS UL94-V0 is optional )	
<b>Operating Temperature Range</b>	<b>Discharge</b>	-20 ~ +50°C
	<b>Charge</b>	0 ~ +40°C
	<b>Storage</b>	-15 ~ +40°C
<b>Capacity Effected by Temperature</b>	<b>40°C / 104°F</b>	106%
	<b>25°C / 77°F</b>	100%
	<b>0°C / 32°F</b>	86%
	<b>-10°C / 14°F</b>	65%
<b>Charge</b>	<b>Float Voltage</b>	2.23 -2.27V/cell@25°C, Tem.Coefficient : -3mV/cell/°C
	<b>Equalize Voltage</b>	2.35 -2.40V/cell@25°C, Tem.Coefficient : -3mV/cell/°C
	<b>Cycle Voltage</b>	2.40 -2.50V/cell@25°C, Tem.Coefficient : -5mV/cell/°C
<b>Max. Charging Current</b>	9A ( 0.3C )	
<b>Max. Discharge Current (5S)</b>	450A	
<b>Internal Resistance</b>	13mΩ	
<b>Self-Discharge</b>	<3%, TN series stored at 25 °C require a supplementary charge every six months, the charging interval would shrink when the ambient temperature went higher	

### Discharge Performance

Constant Current Discharge Table (25°C/77°F) Unit: A

F.V/Time	5min	10min	15min	20min	30min	45min	1h	2h	3h	4h	5h	6h	8h	10h	20h
1.85V/cell	57.2	43.9	36.3	31.4	24.3	18.2	15.33	9.05	7.08	5.77	4.70	4.06	3.27	2.713	1.491
1.80V/cell	76.8	56.2	43.9	37.1	28.7	21.1	17.15	9.89	7.62	6.15	5.04	4.35	3.47	2.793	1.502
1.75V/cell	86.6	61.7	48.0	40.0	29.8	21.9	17.97	10.25	7.76	6.29	5.18	4.47	3.54	2.873	1.522
1.70V/cell	95.3	67.2	51.3	42.0	31.0	22.8	18.47	10.56	7.98	6.46	5.31	4.57	3.58	2.923	1.542
1.67V/cell	105.1	72.6	54.5	44.6	32.7	23.3	18.98	10.66	8.32	6.68	5.45	4.67	3.64	2.983	1.562
1.60V/cell	115.9	78.8	58.3	47.5	34.5	24.4	19.08	11.17	8.58	6.89	5.63	4.77	3.67	3.023	1.572

Constant Power Discharge Table (25°C/77°F) Unit: W

F.V/Time	5min	10min	15min	20min	30min	45min	1h	2h	3h	4h	5h	6h	8h	10h	20h
1.85V/cell	104.6	81.1	67.9	59.3	46.3	34.4	29.13	17.32	13.61	11.11	9.09	7.91	6.40	5.365	2.943
1.80V/cell	138.8	102.4	80.9	69.1	53.9	39.7	32.43	18.82	14.61	11.81	9.70	8.45	6.77	5.516	2.973
1.75V/cell	153.3	110.7	87.3	73.6	55.5	40.8	33.83	19.42	14.81	12.01	9.93	8.65	6.87	5.656	2.993
1.70V/cell	164.1	118.0	91.9	76.8	57.4	42.3	34.73	19.82	15.22	12.31	10.21	8.82	6.96	5.766	3.043
1.67V/cell	178.4	126.1	97.0	80.9	60.1	42.9	35.34	20.02	15.72	12.71	10.41	8.98	7.06	5.876	3.083
1.60V/cell	192.2	133.8	102.0	85.3	63.0	44.5	35.44	20.82	16.12	13.01	10.71	9.14	7.11	5.936	3.103

□ 动力电池

■ 储能电池

■ 备用电池

□ 摩托车电池



## 阀控式免维护铅酸蓄电池-通用型

# TN12-30A

(12V 30Ah)

### 产品特点

- ◆ 阀控式免维护设计，寿命期间无需加水或加酸
- ◆ 专利稀土合金板栅，减少气体产生，自放电率低，抗腐蚀能力出众
- ◆ 在25°C下，产品浮充设计寿命为3~5年，优良的深放电恢复能力
- ◆ 高质量AGM隔板：防止微短路，延长循环寿命
- ◆ ABS壳盖：电池外壳强度高（阻燃壳体UL94-V0可选）



### 尺寸

单个尺寸

长	166±2mm
宽	175±2mm
高	125±3mm
总高	125±3mm

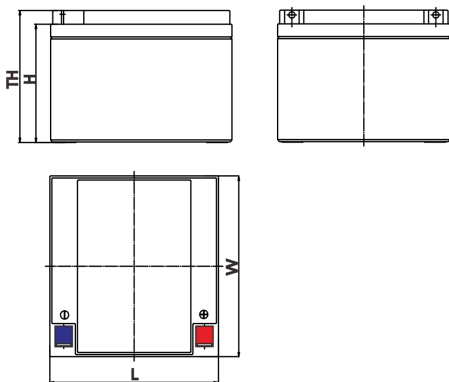

### 产品应用

- ◆ 不间断电源(UPS)
- ◆ 通信和电力设备
- ◆ 紧急照明设备
- ◆ 火灾报警及安防系统
- ◆ 机器人、控制设备及其他机械自动化设备
- ◆ 应急电源系统
- ◆ 便携式音频设备
- ◆ 电动工具，割草机，真空吸尘器
- ◆ 照相设备
- ◆ 便携式测量工具
- ◆ 便携式通话设备
- ◆ 各式电动玩具及娱乐设施
- ◆ 照明设备

### 端子类型

单位:mm

端子类型 L1

### 重量

8.6kg

18.96lbs

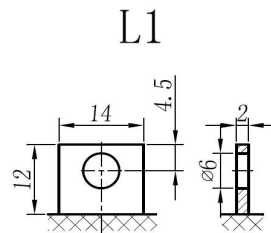

内容如有改动，恕不另行通知

动力电池

储能电池

备用电池

摩托车电池



## TN12-30A

### 规格书

额定电压	12V
容量(25°C)	30.03Ah 20hr Rate(1.80V/cell)
	27.93Ah 10hr Rate(1.80V/cell)
	25.88Ah 5hr Rate(1.75V/cell)
	23.93Ah 3hr Rate(1.70V/cell)
	19.08Ah 1hr Rate(1.60V/cell)
壳体材料	ABS (阻燃ABS壳体可选)
使用温度范围	放电 -20 ~ +50°C
	充电 0 ~ +40°C
	储存 -15 ~ +40°C
不同温度下 电池容量系数	40°C / 104°F 106%
	25°C / 77°F 100%
	0°C / 32°F 86%
	-10°C / 14°F 65%
充电	浮充电压 2.23 -2.27V/单格@25°C, 温度补偿系数: -3mV/单格/°C
	均充电压 2.35 -2.40V/单格@25°C, 温度补偿系数: -3mV/单格/°C
	循环使用电压 2.40 -2.50V/单格@25°C, 温度补偿系数: -5mV/单格/°C
最大充电电流	9A (0.3C)
最大放电电流 (5S)	450A
电阻	13mΩ
自放电	<3%, TN系列储存在25°C时需每6个月进行一次补充充电, 环境温度更高时则充电间隔时间越短

### 放电性能

恒电流放电表 (25°C/77°F) 单位: A															
F.V/Time	5min	10min	15min	20min	30min	45min	1h	2h	3h	4h	5h	6h	8h	10h	20h
1.85V/cell	57.2	43.9	36.3	31.4	24.3	18.2	15.33	9.05	7.08	5.77	4.70	4.06	3.27	2.713	1.491
1.80V/cell	76.8	56.2	43.9	37.1	28.7	21.1	17.15	9.89	7.62	6.15	5.04	4.35	3.47	2.793	1.502
1.75V/cell	86.6	61.7	48.0	40.0	29.8	21.9	17.97	10.25	7.76	6.29	5.18	4.47	3.54	2.873	1.522
1.70V/cell	95.3	67.2	51.3	42.0	31.0	22.8	18.47	10.56	7.98	6.46	5.31	4.57	3.58	2.923	1.542
1.67V/cell	105.1	72.6	54.5	44.6	32.7	23.3	18.98	10.66	8.32	6.68	5.45	4.67	3.64	2.983	1.562
1.60V/cell	115.9	78.8	58.3	47.5	34.5	24.4	19.08	11.17	8.58	6.89	5.63	4.77	3.67	3.023	1.572

恒功率放电表 (25°C/77°F) 单位: W															
F.V/Time	5min	10min	15min	20min	30min	45min	1h	2h	3h	4h	5h	6h	8h	10h	20h
1.85V/cell	104.6	81.1	67.9	59.3	46.3	34.4	29.13	17.32	13.61	11.11	9.09	7.91	6.40	5.365	2.943
1.80V/cell	138.8	102.4	80.9	69.1	53.9	39.7	32.43	18.82	14.61	11.81	9.70	8.45	6.77	5.516	2.973
1.75V/cell	153.3	110.7	87.3	73.6	55.5	40.8	33.83	19.42	14.81	12.01	9.93	8.65	6.87	5.656	2.993
1.70V/cell	164.1	118.0	91.9	76.8	57.4	42.3	34.73	19.82	15.22	12.31	10.21	8.82	6.96	5.766	3.043
1.67V/cell	178.4	126.1	97.0	80.9	60.1	42.9	35.34	20.02	15.72	12.71	10.41	8.98	7.06	5.876	3.083
1.60V/cell	192.2	133.8	102.0	85.3	63.0	44.5	35.44	20.82	16.12	13.01	10.71	9.14	7.11	5.936	3.103