

Motive Battery

Energy Storage Battery

Reserve Battery

Motorcycle Battery



Industry Battery-General Purpose AGM Battery-TN Series

TN12-45

(12V 45Ah)

GENERAL FEATURES

- ♦ Oxygen recombination technology: maintenance-free, no need to add water or acid
- ♦ The patent grid alloy: less gassing, low self-discharge, excellent corrosion resistance
- ♦ Design life is 7~9 years at 25°C under standby application, deep discharge recoverability
- ♦ High quality AGM separator: extend cycle life and prevent micro short circuit
- ♦ ABS container: increase the strength of battery (Flame-retardant ABS UL94-V0 is optional)

Dimension

Unit:mm

Length 198.5±2mm / 7.81inch

Width 166±2mm / 6.54inch

Container Height 169.5±3mm / 6.67inch

Total Height 169.5±3mm / 6.67inch

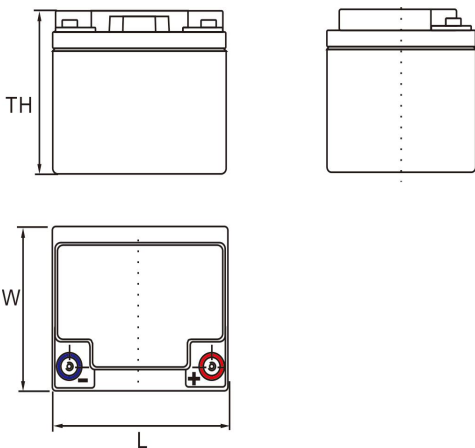

Application

- ♦ Uninterrupted Power Supply (UPS)
- ♦ Communications and electric equipment
- ♦ Emergency lighting equipment
- ♦ Fire alarm and security system
- ♦ Control equipment, and other factory automation equipment
- ♦ Emergency power supply (EPS)
- ♦ Portable VTR/TV, radio and so on
- ♦ Power tools, lawn mowers, vacuum cleaners
- ♦ Cameras and photographic equipment
- ♦ Portable measuring equipment
- ♦ Portable telephone sets
- ♦ Various power toys and hobby equipment
- ♦ Lighting equipment

Terminal

Unit:mm

Terminal Type: I3

Weight

14.2kg

31.31lbs

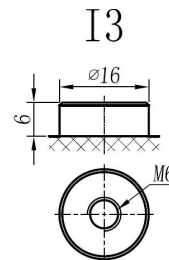

ISO9001 ISO14001 OHSAS18001

This document is subject to change without prior notification

Motive Battery

Energy Storage Battery

Reserve Battery

Motorcycle Battery



TN12-45

Specificaion

Nominal Voltage	12V	
	47Ah	20hr Rate (1.80V/cell)
	45Ah	10hr Rate (1.80V/cell)
Rated Capacity(25°C)	39Ah	5hr Rate (1.75V/cell)
	37Ah	3hr Rate (1.70V/cell)
	28Ah	1hr Rate (1.60V/cell)
Container Material	ABS (Flame-retardant ABS UL94-V0 is optional)	
Operating Temperature Range	Discharge	-20 ~ +50°C
	Charge	0 ~ +40°C
	Storage	-15 ~ +40°C
Capacity Effected by Temperature	40°C / 104°F	106%
	25°C / 77°F	100%
	0°C / 32°F	86%
	-10°C / 14°F	65%
Charge	Float Voltage	2.23 -2.27V/cell@25°C, Tem.Coefficient : -3mV/cell/°C
	Equalize Voltage	2.35 -2.40V/cell@25°C, Tem.Coefficient : -3mV/cell/°C
	Cycle Voltage	2.40 -2.50V/cell@25°C, Tem.Coefficient : -5mV/cell/°C
Max. Charging Current	13.5A (0.3C)	
Max. Discharge Current (5S)	540A	
Internal Resistance	9mΩ	
Self-Discharge	<3%, TN series stored at 25 °C require a supplementary charge every six months, the charging interval would shrink when the ambient temperature went higher	

Discharge Performance

Constant Current Discharge Table (25°C/77°F) Unit: A															
F.V/Time	5min	10min	15min	20min	30min	45min	1h	2h	3h	4h	5h	6h	8h	10h	20h
1.85V/cell	77.1	60.7	51.6	43.1	34.2	26.3	21.52	13.70	10.86	8.86	7.14	6.18	5.02	4.254	2.322
1.80V/cell	103.5	77.5	62.3	51.0	40.4	30.6	24.16	14.92	11.67	9.46	7.67	6.64	5.32	4.505	2.342
1.75V/cell	116.7	85.1	68.1	54.9	41.9	31.8	25.27	15.53	11.88	9.67	7.86	6.82	5.41	4.555	2.362
1.70V/cell	128.5	92.8	72.7	57.7	43.6	33.0	25.98	16.14	12.18	9.93	8.07	6.96	5.49	4.595	2.412
1.67V/cell	141.6	100.1	77.2	61.3	46.0	33.8	26.90	16.54	12.69	10.27	8.29	7.11	5.59	4.685	2.442
1.60V/cell	156.3	108.7	82.6	65.2	48.6	35.2	27.91	17.15	13.09	10.59	8.57	7.27	5.64	4.735	2.452

Constant Power Discharge Table (25°C/77°F) Unit: W															
F.V/Time	5min	10min	15min	20min	30min	45min	1h	2h	3h	4h	5h	6h	8h	10h	20h
1.85V/cell	140.9	112.0	96.2	81.3	65.3	49.8	40.94	26.23	20.82	17.12	13.81	12.01	9.83	8.418	4.595
1.80V/cell	187.2	141.3	114.6	94.7	75.9	57.6	45.65	28.43	22.32	18.12	14.71	12.91	10.41	8.899	4.635
1.75V/cell	206.6	152.9	123.7	100.8	78.2	59.2	47.55	29.43	22.62	18.52	15.12	13.21	10.51	8.979	4.675
1.70V/cell	221.1	162.9	130.2	105.2	80.9	61.3	48.85	30.53	23.22	18.92	15.42	13.41	10.71	9.059	4.755
1.67V/cell	240.4	174.1	137.4	110.9	84.6	62.3	50.15	31.23	24.12	19.52	15.82	13.71	10.81	9.229	4.815
1.60V/cell	259.1	184.7	144.5	116.8	88.7	64.5	51.65	32.13	24.72	20.02	16.32	13.91	10.91	9.319	4.835

动力电池

储能电池

备用电池

摩托车电池



阀控式免维护铅酸蓄电池 - 通用型

TN12-45

(12V 45Ah)

产品特点

- ◆ 阀控式免维护设计，寿命期间无需加水或加酸
- ◆ 专利稀土合金板栅，减少气体产生，自放电率低，抗腐蚀能力出众
- ◆ 在25°C下，产品浮充设计寿命为7~9年，优良的深放电恢复能力
- ◆ 高质量AGM隔板：防止微短路，延长循环寿命
- ◆ ABS壳盖：电池外壳强度高（阻燃壳体UL94-V0可选）

尺寸

单个尺寸

长	198.5 ± 2mm
宽	166 ± 2mm
高	169.5 ± 3mm
总高	169.5 ± 3mm

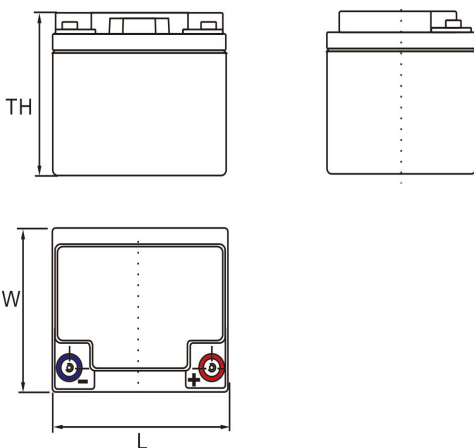

产品应用

- ◆ 不间断电源(UPS)
- ◆ 通信和电力设备
- ◆ 紧急照明设备
- ◆ 火灾报警及安防系统
- ◆ 控制设备及其他机械自动化设备
- ◆ 应急电源系统
- ◆ 便携式音频设备
- ◆ 电动工具，割草机，真空吸尘器
- ◆ 照相设备
- ◆ 便携式测量工具
- ◆ 便携式通话设备
- ◆ 各式电动玩具及娱乐设施
- ◆ 照明设备

端子类型

单位:mm

端子类型 I3

重量

14.2kg 31.31lbs

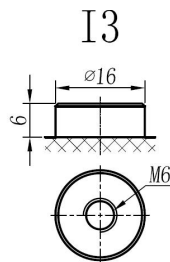

ISO9001 ISO14001 OHSAS18001

内容如有改动，恕不另行通知

动力电池

储能电池

备用电池

摩托车电池



TN12-45

规格书

额定电压	12V	
容量(25°C)	47Ah	20hr Rate (1.80V/cell)
	45Ah	10hr Rate (1.80V/cell)
	39Ah	5hr Rate (1.75V/cell)
	37Ah	3hr Rate (1.70V/cell)
	28Ah	1hr Rate (1.60V/cell)
壳体材料	ABS (阻燃ABS壳体可选)	
使用温度范围	放电	-20 ~ +50°C
	充电	0 ~ +40°C
	储存	-15 ~ +40°C
不同温度下 电池容量系数	40°C / 104°F	106%
	25°C / 77°F	100%
	0°C / 32°F	86%
	-10°C / 14°F	65%
充电	浮充电压	2.23 -2.27V/单格@25°C, 温度补偿系数: -3mV/单格/°C
	均充电压	2.35 -2.40V/单格@25°C, 温度补偿系数: -3mV/单格/°C
	循环使用电压	2.40 -2.50V/单格@25°C, 温度补偿系数: -5mV/单格/°C
最大充电电流	13.5A (0.3C)	
最大放电电流 (5S)	540A	
电阻	9mΩ	
自放电	<3%, TN系列储存在25°C 时需每6个月进行一次补充充电, 环境温度更高时则充电间隔时间越短	

放电性能

恒电流放电表 (25°C/77°F) 单位: A															
F.V/Time	5min	10min	15min	20min	30min	45min	1h	2h	3h	4h	5h	6h	8h	10h	20h
1.85V/cell	77.1	60.7	51.6	43.1	34.2	26.3	21.52	13.70	10.86	8.86	7.14	6.18	5.02	4.254	2.322
1.80V/cell	103.5	77.5	62.3	51.0	40.4	30.6	24.16	14.92	11.67	9.46	7.67	6.64	5.32	4.505	2.342
1.75V/cell	116.7	85.1	68.1	54.9	41.9	31.8	25.27	15.53	11.88	9.67	7.86	6.82	5.41	4.555	2.362
1.70V/cell	128.5	92.8	72.7	57.7	43.6	33.0	25.98	16.14	12.18	9.93	8.07	6.96	5.49	4.595	2.412
1.67V/cell	141.6	100.1	77.2	61.3	46.0	33.8	26.90	16.54	12.69	10.27	8.29	7.11	5.59	4.685	2.442
1.60V/cell	156.3	108.7	82.6	65.2	48.6	35.2	27.91	17.15	13.09	10.59	8.57	7.27	5.64	4.735	2.452

恒功率放电表 (25°C/77°F) 单位: W															
F.V/Time	5min	10min	15min	20min	30min	45min	1h	2h	3h	4h	5h	6h	8h	10h	20h
1.85V/cell	140.9	112.0	96.2	81.3	65.3	49.8	40.94	26.23	20.82	17.12	13.81	12.01	9.83	8.418	4.595
1.80V/cell	187.2	141.3	114.6	94.7	75.9	57.6	45.65	28.43	22.32	18.12	14.71	12.91	10.41	8.899	4.635
1.75V/cell	206.6	152.9	123.7	100.8	78.2	59.2	47.55	29.43	22.62	18.52	15.12	13.21	10.51	8.979	4.675
1.70V/cell	221.1	162.9	130.2	105.2	80.9	61.3	48.85	30.53	23.22	18.92	15.42	13.41	10.71	9.059	4.755
1.67V/cell	240.4	174.1	137.4	110.9	84.6	62.3	50.15	31.23	24.12	19.52	15.82	13.71	10.81	9.229	4.815
1.60V/cell	259.1	184.7	144.5	116.8	88.7	64.5	51.65	32.13	24.72	20.02	16.32	13.91	10.91	9.319	4.835