

Motive Battery

Energy Storage Battery

Reserve Battery

Motorcycle Battery



Industry Battery-General Purpose AGM Battery-TN Series

TN12-75

(12V 75Ah)

GENERAL FEATURES

- ◆ Oxygen recombination technology: maintenance-free, no need to add water or acid
- ◆ The patent grid alloy: less gassing, low self-discharge, excellent corrosion resistance
- ◆ Design life is 7~9 years at 25°C under standby application, deep discharge recoverability
- ◆ High quality AGM separator: extend cycle life and prevent micro short circuit
- ◆ ABS container: increase the strength of battery (Flame-retardant ABS UL94-V0 is optional)



Application

- ◆ Uninterrupted Power Supply (UPS)
- ◆ Communications and electric equipment
- ◆ Emergency lighting equipment
- ◆ Fire alarm and security system
- ◆ Control equipment, and other factory automation equipment
- ◆ Emergency power supply (EPS)
- ◆ Portable VTR/TV, radio and so on
- ◆ Power tools, lawn mowers, vacuum cleaners
- ◆ Cameras and photographic equipment
- ◆ Portable measuring equipment
- ◆ Portable telephone sets
- ◆ Various power toys and hobby equipment
- ◆ Lighting equipment

Dimension

Unit:mm

Length 260±2mm / 10.24inch

Width 168±2mm / 6.61inch

Container Height 211±3mm / 8.31inch

Total Height 213.5±3mm / 8.41inch

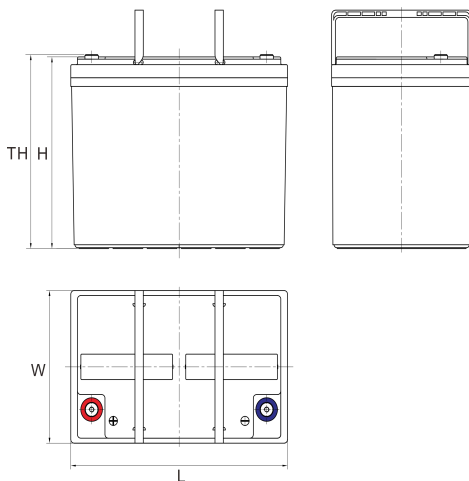

Terminal

Unit:mm

Terminal Type: I3

Weight

22.3kg

49.16lbs

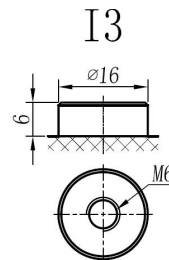

This document is subject to change without prior notification

Motive Battery

Energy Storage Battery

Reserve Battery

Motorcycle Battery



TN12-75

Specification

Nominal Voltage	12V	
	78Ah	20hr Rate (1.80V/cell)
	75Ah	10hr Rate (1.80V/cell)
Rated Capacity(25°C)	65Ah	5hr Rate (1.75V/cell)
	61Ah	3hr Rate (1.70V/cell)
	46Ah	1hr Rate (1.60V/cell)
Container Material	ABS (Flame-retardant ABS UL94-V0 is optional)	
Operating Temperature Range	Discharge	-20 ~ +50°C
	Charge	0 ~ +40°C
	Storage	-15 ~ +40°C
Capacity Effected by Temperature	40°C / 104°F	106%
	25°C / 77°F	100%
	0°C / 32°F	86%
	-10°C / 14°F	65%
Charge	Float Voltage	2.23 -2.27V/cell@25°C, Tem.Coefficient : -3mV/cell/°C
	Equalize Voltage	2.35 -2.40V/cell@25°C, Tem.Coefficient : -3mV/cell/°C
	Cycle Voltage	2.40 -2.50V/cell@25°C, Tem.Coefficient : -5mV/cell/°C
Max. Charging Current	22.5A (0.3C)	
Max. Discharge Current (5S)	900A	
Internal Resistance	6.6mΩ	
Self-Discharge	<3%, TN series stored at 25 °C require a supplementary charge every six months, the charging interval would shrink when the ambient temperature went higher	

Discharge Performance

Constant Current Discharge Table (25°C/77°F) Unit: A															
F.V/Time	5min	10min	15min	20min	30min	45min	1h	2h	3h	4h	5h	6h	8h	10h	20h
1.85V/cell	128.5	101.0	85.9	71.9	57.2	43.8	35.93	22.84	18.07	14.72	11.88	10.30	8.37	7.087	3.864
1.80V/cell	172.5	129.0	103.8	85.0	67.4	51.0	40.19	24.97	19.49	15.73	12.79	11.01	8.88	7.508	3.904
1.75V/cell	194.5	141.8	113.4	91.4	70.0	52.9	42.02	25.88	19.79	16.14	13.09	11.31	9.03	7.588	3.944
1.70V/cell	214.1	154.6	121.0	96.0	72.8	55.0	43.34	26.90	20.40	16.54	13.40	11.62	9.16	7.658	4.014
1.67V/cell	236.1	166.9	128.7	102.0	76.8	56.4	44.86	27.61	21.21	17.05	13.80	11.82	9.30	7.818	4.074
1.60V/cell	260.5	181.1	137.6	108.7	81.1	58.8	46.49	28.62	21.92	17.66	14.31	12.12	9.39	7.898	4.094

Constant Power Discharge Table (25°C/77°F) Unit: W															
F.V/Time	5min	10min	15min	20min	30min	45min	1h	2h	3h	4h	5h	6h	8h	10h	20h
1.85V/cell	234.9	186.6	160.3	135.4	108.8	83.1	68.27	43.74	34.73	28.43	23.02	20.12	16.42	14.014	7.658
1.80V/cell	312.0	235.6	191.1	157.8	126.4	95.9	76.08	47.45	37.14	30.23	24.62	21.42	17.32	14.815	7.718
1.75V/cell	344.2	254.8	206.1	168.1	130.2	98.5	79.18	49.05	37.74	30.83	25.13	22.02	17.62	14.915	7.788
1.70V/cell	368.6	271.4	217.0	175.3	134.7	102.1	81.48	50.85	38.74	31.53	25.73	22.42	17.82	15.115	7.928
1.67V/cell	400.7	290.2	229.0	184.9	141.0	103.7	83.58	52.05	40.14	32.53	26.33	22.82	18.02	15.415	8.028
1.60V/cell	431.7	307.9	240.8	194.8	147.8	107.5	86.09	53.45	41.24	33.43	27.13	23.22	18.22	15.516	8.058

动力电池

储能电池

备用电池

摩托车电池



阀控式免维护铅酸蓄电池 - 通用型

TN12-75

(12V 75Ah)

产品特点

- ◆ 阀控式免维护设计，寿命期间无需加水或加酸
- ◆ 专利稀土合金板栅，减少气体产生，自放电率低，抗腐蚀性能力出众
- ◆ 在25°C下，产品浮充设计寿命为7~9年，优良的深放电恢复能力
- ◆ 高质量AGM隔板：防止微短路，延长循环寿命
- ◆ ABS壳盖：电池外壳强度高（阻燃壳体UL94-V0可选）



产品应用

- ◆ 不间断电源(UPS)
- ◆ 通信和电力设备
- ◆ 紧急照明设备
- ◆ 火灾报警及安防系统
- ◆ 控制设备及其他机械自动化设备
- ◆ 应急电源系统
- ◆ 便携式音频设备
- ◆ 电动工具，割草机，真空吸尘器
- ◆ 照相设备
- ◆ 便携式测量工具
- ◆ 便携式通话设备
- ◆ 各式电动玩具及娱乐设施
- ◆ 照明设备

尺寸

单个尺寸

长	260±2mm
宽	168±2mm
高	211±3mm
总高	213.5±3mm

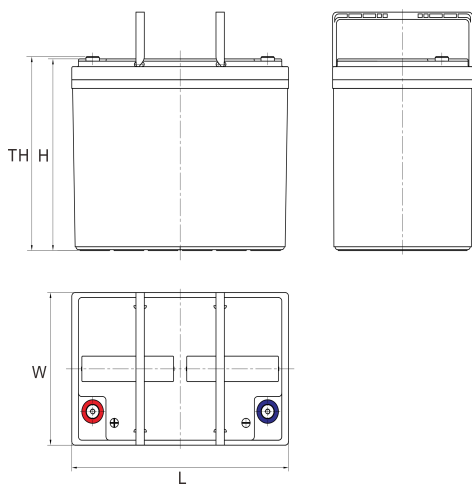

端子类型

单位:mm

端子类型 I3

重量

22.3kg 49.16lbs

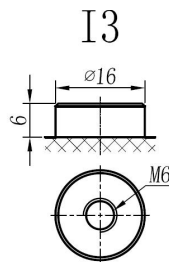

内容如有改动，恕不另行通知

动力电池

储能电池

备用电池

摩托车电池



TN12-75

规格书

额定电压	12V	
容量(25°C)	78Ah	20hr Rate (1.80V/cell)
	75Ah	10hr Rate (1.80V/cell)
	65Ah	5hr Rate (1.75V/cell)
	61Ah	3hr Rate (1.70V/cell)
	46Ah	1hr Rate (1.60V/cell)
壳体材料	ABS (阻燃ABS壳体可选)	
使用温度范围	放电	-20 ~ +50°C
	充电	0 ~ +40°C
	储存	-15 ~ +40°C
不同温度下 电池容量系数	40°C / 104°F	106%
	25°C / 77°F	100%
	0°C / 32°F	86%
	-10°C / 14°F	65%
充电	浮充电压	2.23 -2.27V/单格@25°C, 温度补偿系数: -3mV/单格/°C
	均充电压	2.35 -2.40V/单格@25°C, 温度补偿系数: -3mV/单格/°C
	循环使用电压	2.40 -2.50V/单格@25°C, 温度补偿系数: -5mV/单格/°C
最大充电电流	22.5A (0.3C)	
最大放电电流 (5S)	900A	
电阻	6.6mΩ	
自放电	<3%, TN系列储存在25°C 时需每6个月进行一次补充充电, 环境温度更高时则充电间隔时间越短	

放电性能

恒电流放电表 (25°C/77°F) 单位: A															
F.V/Time	5min	10min	15min	20min	30min	45min	1h	2h	3h	4h	5h	6h	8h	10h	20h
1.85V/cell	128.5	101.0	85.9	71.9	57.2	43.8	35.93	22.84	18.07	14.72	11.88	10.30	8.37	7.087	3.864
1.80V/cell	172.5	129.0	103.8	85.0	67.4	51.0	40.19	24.97	19.49	15.73	12.79	11.01	8.88	7.508	3.904
1.75V/cell	194.5	141.8	113.4	91.4	70.0	52.9	42.02	25.88	19.79	16.14	13.09	11.31	9.03	7.588	3.944
1.70V/cell	214.1	154.6	121.0	96.0	72.8	55.0	43.34	26.90	20.40	16.54	13.40	11.62	9.16	7.658	4.014
1.67V/cell	236.1	166.9	128.7	102.0	76.8	56.4	44.86	27.61	21.21	17.05	13.80	11.82	9.30	7.818	4.074
1.60V/cell	260.5	181.1	137.6	108.7	81.1	58.8	46.49	28.62	21.92	17.66	14.31	12.12	9.39	7.898	4.094

恒功率放电表 (25°C/77°F) 单位: W															
F.V/Time	5min	10min	15min	20min	30min	45min	1h	2h	3h	4h	5h	6h	8h	10h	20h
1.85V/cell	234.9	186.6	160.3	135.4	108.8	83.1	68.27	43.74	34.73	28.43	23.02	20.12	16.42	14.014	7.658
1.80V/cell	312.0	235.6	191.1	157.8	126.4	95.9	76.08	47.45	37.14	30.23	24.62	21.42	17.32	14.815	7.718
1.75V/cell	344.2	254.8	206.1	168.1	130.2	98.5	79.18	49.05	37.74	30.83	25.13	22.02	17.62	14.915	7.788
1.70V/cell	368.6	271.4	217.0	175.3	134.7	102.1	81.48	50.85	38.74	31.53	25.73	22.42	17.82	15.115	7.928
1.67V/cell	400.7	290.2	229.0	184.9	141.0	103.7	83.58	52.05	40.14	32.53	26.33	22.82	18.02	15.415	8.028
1.60V/cell	431.7	307.9	240.8	194.8	147.8	107.5	86.09	53.45	41.24	33.43	27.13	23.22	18.22	15.516	8.058