

☐ Motive Battery

■ Energy Storage Battery

■ Reserve Battery

☐ Motorcycle Battery



## Industry Battery-General Purpose AGM Battery-TN Series

# TN2-1200

(2V 1200Ah)

### GENERAL FEATURES

- ◆ Oxygen recombination technology: maintenance-free, no need to add water or acid
- ◆ The patent grid alloy: less gassing, low self-discharge, excellent corrosion resistance
- ◆ Design life is 11~13 years at 25°C under standby application, deep discharge recoverability
- ◆ High quality AGM separator: extend cycle life and prevent micro short circuit
- ◆ ABS container: increase the strength of battery (Flame-retardant ABS UL94-V0 is optional)

### Dimension

Unit:mm

Length 471±2mm / 18.54inch

Width 171±2mm / 6.73inch

Container Height 330±3mm / 12.99inch

Total Height 342±3mm / 13.46inch

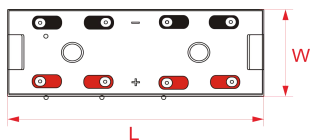
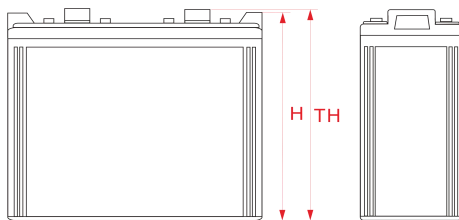

### Application

- ◆ Uninterrupted Power Supply ( UPS )
- ◆ Communications and electric equipment
- ◆ Emergency lighting equipment
- ◆ Fire alarm and security system
- ◆ Control equipment, and other factory automation equipment
- ◆ Emergency power supply ( EPS )
- ◆ Portable VTR/TV, radio and so on
- ◆ Power tools, lawn mowers, vacuum cleaners
- ◆ Cameras and photographic equipment
- ◆ Portable measuring equipment
- ◆ Portable telephone sets
- ◆ Various power toys and hobby equipment
- ◆ Lighting equipment

### Terminal

Unit:mm

Terminal Type: I7

### Weight

66.2kg 146.36lbs

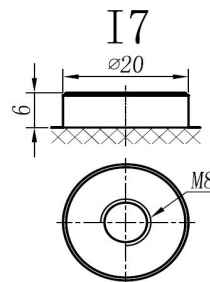

ISO9001 ISO14001 OHSAS18001

This document is subject to change without prior notification

Motive Battery

Energy Storage Battery

Reserve Battery

Motorcycle Battery



## TN2-1200

### Specificaion

<b>Nominal Voltage</b>	2V	
<b>Rated Capacity(25°C)</b>	1261Ah	20hr Rate (1.80V/cell)
	1200Ah	10hr Rate (1.80V/cell)
	1060Ah	5hr Rate (1.75V/cell)
	945Ah	3hr Rate (1.70V/cell)
	739Ah	1hr Rate (1.60V/cell)
<b>Container Material</b>	ABS ( Flame-retardant ABS UL94-V0 is optional )	
<b>Operating Temperature Range</b>	<b>Discharge</b>	-20 ~ +50°C
	<b>Charge</b>	0 ~ +40°C
	<b>Storage</b>	-15 ~ +40°C
<b>Capacity Effected by Temperature</b>	<b>40°C / 104°F</b>	106%
	<b>25°C / 77°F</b>	100%
	<b>0°C / 32°F</b>	86%
	<b>-10°C / 14°F</b>	65%
<b>Charge</b>	<b>Float Voltage</b>	2.23 -2.27V/cell@25°C, Tem.Coefficient : -3mV/cell/°C
	<b>Equalize Voltage</b>	2.35 -2.40V/cell@25°C, Tem.Coefficient : -3mV/cell/°C
	<b>Cycle Voltage</b>	2.40 -2.50V/cell@25°C, Tem.Coefficient : -5mV/cell°C
<b>Max. Charging Current</b>	360A ( 0.3C)	
<b>Max. Discharge Current (5S)</b>	9600A	
<b>Internal Resistance</b>	0.4mΩ	
<b>Self-Discharge</b>	<3%, TN series stored at 25 °C require a supplementary charge every six months, the charging interval would shrink when the ambient temperature went higher	

### Discharge Performance

Constant Current Discharge Table (25°C/77°F) Unit: A											
F.V/Time	30min	45min	1h	2h	3h	4h	5h	6h	8h	10h	20h
1.85V/cell	921.0	740.5	607.78	365.10	282.17	231.72	197.32	171.50	138.17	114.71	60.861
1.80V/cell	988.3	779.1	645.54	385.19	295.97	242.08	205.64	179.17	143.52	120.00	63.063
1.75V/cell	1046.5	819.2	673.55	401.13	306.94	250.30	211.93	183.42	146.25	121.32	63.664
1.70V/cell	1098.1	850.1	697.10	412.90	315.06	255.78	215.59	186.65	148.47	122.52	64.364
1.67V/cell	1151.9	887.1	722.27	425.29	321.96	261.26	220.26	189.88	150.59	124.12	65.165
1.60V/cell	1191.6	911.1	739.33	435.44	328.86	264.92	223.40	192.51	152.61	125.53	65.866

Constant Power Discharge Table (25°C/77°F) Unit: W											
F.V/Time	30min	45min	1h	2h	3h	4h	5h	6h	8h	10h	20h
1.85V/cell	1760.3	1404.2	1159.46	700.30	543.84	448.25	383.38	335.84	271.77	228.13	121.121
1.80V/cell	1873.6	1467.6	1224.52	735.33	567.77	466.67	397.70	349.45	281.28	238.54	125.325
1.75V/cell	1968.9	1534.1	1272.07	762.66	587.29	480.88	408.51	356.66	285.99	240.64	126.426
1.70V/cell	2048.5	1580.8	1309.71	781.88	600.50	489.39	414.31	362.36	290.19	242.84	127.628
1.67V/cell	2132.8	1640.4	1349.15	802.00	611.01	498.20	421.72	367.57	293.59	245.55	129.129
1.60V/cell	2184.2	1669.0	1371.47	815.92	620.82	502.90	426.13	371.47	296.80	248.05	130.430

☐ 动力电池

■ 储能电池

■ 备用电池

☐ 摩托车电池



### 阀控式免维护铅酸蓄电池-通用型

# TN2-1200

(2V 1200Ah)

## 产品特点

- ◆ 阀控式免维护设计，寿命期间无需加水或加酸
- ◆ 专利稀土合金板栅，减少气体产生，自放电率低，抗腐蚀能力出众
- ◆ 在25°C下，产品浮充设计寿命为11~13年，优良的深放电恢复能力
- ◆ 高质量AGM隔板：防止微短路，延长循环寿命
- ◆ ABS壳盖：电池外壳强度高（阻燃壳体UL94-V0可选）

## 尺寸

单个尺寸

长	471±2mm
宽	171±2mm
高	330±3mm
总高	342±3mm

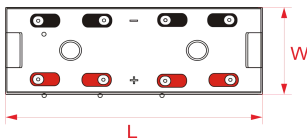
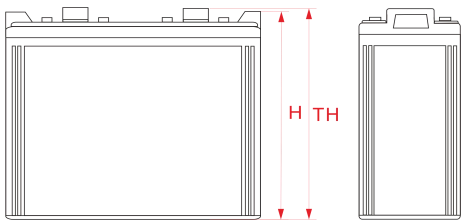

## 产品应用

- ◆ 不间断电源(UPS)
- ◆ 通信和电力设备
- ◆ 紧急照明设备
- ◆ 火灾报警及安防系统
- ◆ 控制设备及其他机械自动化设备
- ◆ 应急电源系统
- ◆ 便携式音频设备
- ◆ 电动工具，割草机，真空吸尘器
- ◆ 照相设备
- ◆ 便携式测量工具
- ◆ 便携式通话设备
- ◆ 各式电动玩具及娱乐设施
- ◆ 照明设备

## 端子类型

单位:mm

端子类型 I7

## 重量

66.2kg 146.36lbs

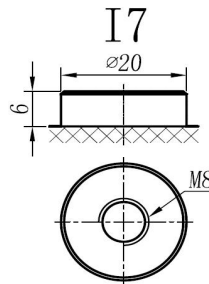

ISO9001 ISO14001 OHSAS18001

内容如有改动，恕不另行通知



动力电池

储能电池

备用电池

摩托车电池



## TN2-1200

### 规格书

额定电压	2V	
额定容量	1261Ah	20hr Rate (1.80V/cell)
	1200Ah	10hr Rate (1.80V/cell)
	1060Ah	5hr Rate (1.75V/cell)
	945Ah	3hr Rate (1.70V/cell)
	739Ah	1hr Rate (1.60V/cell)
壳体材料	ABS (阻燃ABS壳体可选)	
使用温度范围	放电	-20 ~ +50°C
	充电	0 ~ +40°C
	储存	-15 ~ +40°C
不同温度下电池容量系数	40°C / 104°F	106%
	25°C / 77°F	100%
	0°C / 32°F	86%
	-10°C / 14°F	65%
充电	浮充电压	2.23 -2.27V/单格@25°C, 温度补偿系数: -3mV/单格/°C
	均充电压	2.35 -2.40V/单格@25°C, 温度补偿系数: -3mV/单格/°C
	循环使用电压	2.40 -2.50V/单格@25°C, 温度补偿系数: -5mV/单格/°C
最大充电电流	360A (0.3C)	
最大放电电流 (5S)	9600A	
电阻	0.4mΩ	
自放电	<3%, TN系列储存在25°C 时需每6个月进行一次补充充电, 环境温度更高时则充电间隔时间越短	

### 放电性能

恒电流放电表 (25°C/77°F) 单位: A											
F.V/Time	30min	45min	1h	2h	3h	4h	5h	6h	8h	10h	20h
1.85V/cell	921.0	740.5	607.78	365.10	282.17	231.72	197.32	171.50	138.17	114.71	60.861
1.80V/cell	988.3	779.1	645.54	385.19	295.97	242.08	205.64	179.17	143.52	120.00	63.063
1.75V/cell	1046.5	819.2	673.55	401.13	306.94	250.30	211.93	183.42	146.25	121.32	63.664
1.70V/cell	1098.1	850.1	697.10	412.90	315.06	255.78	215.59	186.65	148.47	122.52	64.364
1.67V/cell	1151.9	887.1	722.27	425.29	321.96	261.26	220.26	189.88	150.59	124.12	65.165
1.60V/cell	1191.6	911.1	739.33	435.44	328.86	264.92	223.40	192.51	152.61	125.53	65.866

恒功率放电表 (25°C/77°F) 单位: W											
F.V/Time	30min	45min	1h	2h	3h	4h	5h	6h	8h	10h	20h
1.85V/cell	1760.3	1404.2	1159.46	700.30	543.84	448.25	383.38	335.84	271.77	228.13	121.121
1.80V/cell	1873.6	1467.6	1224.52	735.33	567.77	466.67	397.70	349.45	281.28	238.54	125.325
1.75V/cell	1968.9	1534.1	1272.07	762.66	587.29	480.88	408.51	356.66	285.99	240.64	126.426
1.70V/cell	2048.5	1580.8	1309.71	781.88	600.50	489.39	414.31	362.36	290.19	242.84	127.628
1.67V/cell	2132.8	1640.4	1349.15	802.00	611.01	498.20	421.72	367.57	293.59	245.55	129.129
1.60V/cell	2184.2	1669.0	1371.47	815.92	620.82	502.90	426.13	371.47	296.80	248.05	130.430