

TN2-1500 [2V 1500Ah]



Product Features

General Purpose (AGM)		10~12 years of design life@25°C	
100% Model Coverage Both Cycle & Float Application	↑98% Capacity Retention High Purity Electrolyte	↑20% Charge Acceptance Special Negative Additive	↓50% Grid Corrosion Rare-earth patent alloy

Product Applications

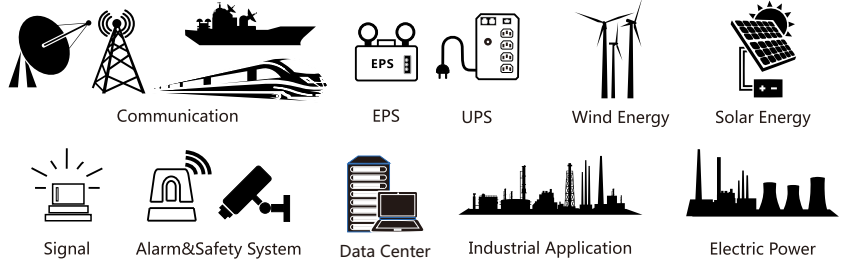

Physical Specifications

Model	Dimensions (mm/inch)				Weight (kg/lbs)	Terminal	Container
TN2-1500	Length	Width	Height	Total Height	93/205	I7	ABS UL94-HB (Optional: FR ABS UL94-V0)
	403/15.9	350/13.8	340/13.4	350/13.8			

Product Specifications

Nominal Voltage	Rated Capacity@25°C/77°F	Internal Resistance	Max. Discharge Current	Operating Temp. Range
2V	1598Ah 20hr Rate (1.80V/cell) 1500Ah 10hr Rate (1.80V/cell) 1315Ah 5hr Rate (1.75V/cell) 1194Ah 3hr Rate (1.70V/cell)	0.21mΩ@25°C/77°F	9300A (5s)	Discharge:-15~50°C (5~122°F) Charge:0~40°C (32~104°F) Storage:-15~40°C (5~104°F) Optimum:25±2°C (77±4°F)

Constant Current Discharge (A)@25°C (77°F)

F.V/Time	30min	45min	1h	2h	3h	4h	5h	6h	8h	10h	20h
1.85V/cell	1227	1008	845	504	368	297	250	218	176	146	78.5
1.80V/cell	1305	1052	886	526	383	306	257	224	180	150	79.9
1.75V/cell	1368	1100	920	539	392	312	263	229	183	152	81.0
1.70V/cell	1434	1140	941	548	398	318	267	233	185	154	82.7
1.67V/cell	1494	1176	968	560	404	324	272	236	188	156	84.1
1.60V/cell	1566	1214	995	569	411	328	276	239	191	158	85.7

Constant Power Discharge (W/cell)@25°C (77°F)

F.V/Time	30min	45min	1h	2h	3h	4h	5h	6h	8h	10h	20h
1.85V/cell	2415	1999	1682	1013	745	602	510	446	362	300	162
1.80V/cell	2560	2081	1760	1053	772	619	522	457	369	307	164
1.75V/cell	2676	2170	1822	1077	787	629	533	466	374	312	166
1.70V/cell	2796	2245	1859	1092	797	640	540	472	377	314	168
1.67V/cell	2905	2310	1907	1112	807	649	547	477	381	318	171
1.60V/cell	3032	2375	1953	1126	819	656	554	481	385	319	174

TN2-1500 [2V 1500Ah]



Battery Dimensions(mm)

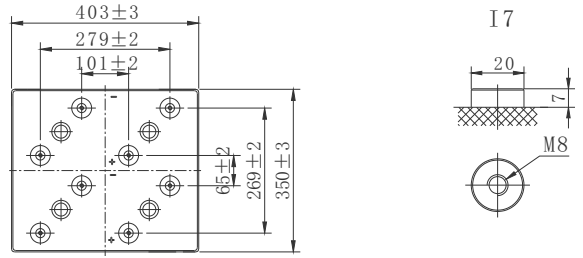
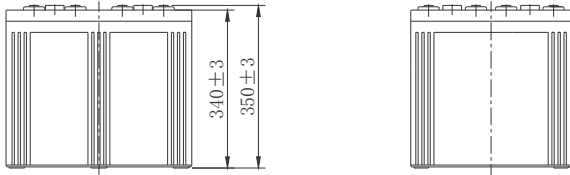

Electrical Characteristics

Discharging Characteristics(25°C)

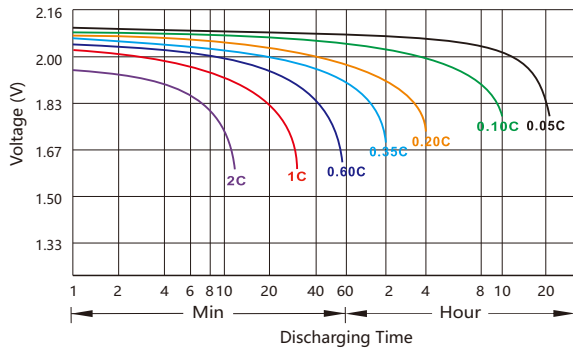

Charging Characteristics(25°C)

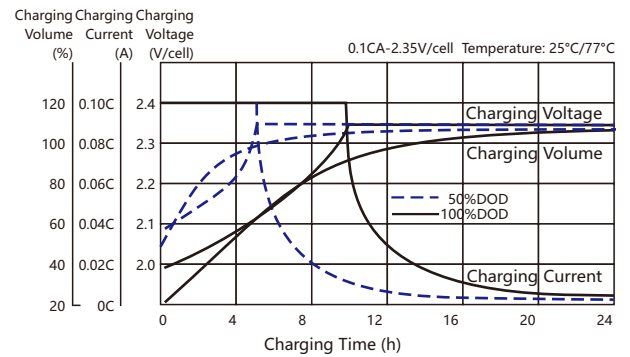

Capacity vs Temperature

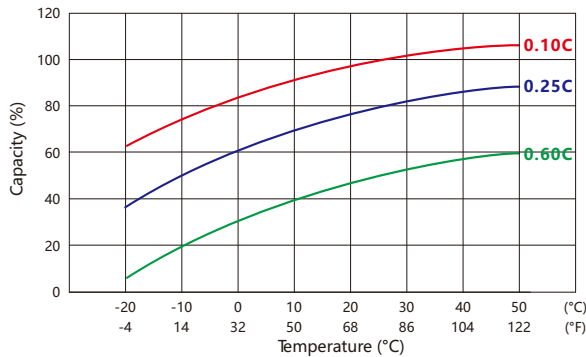

Self-discharge vs Time

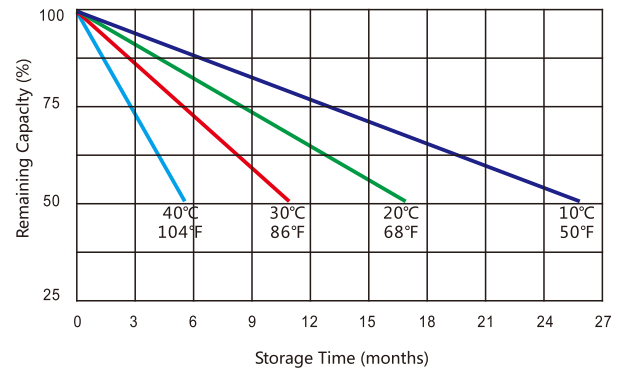

Cycle Life vs Depth of Discharge

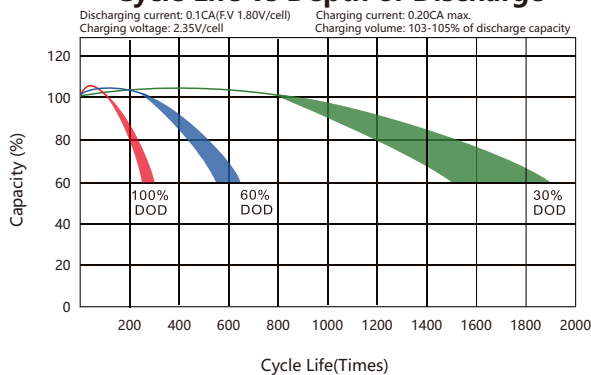

Floating Life vs Temperature

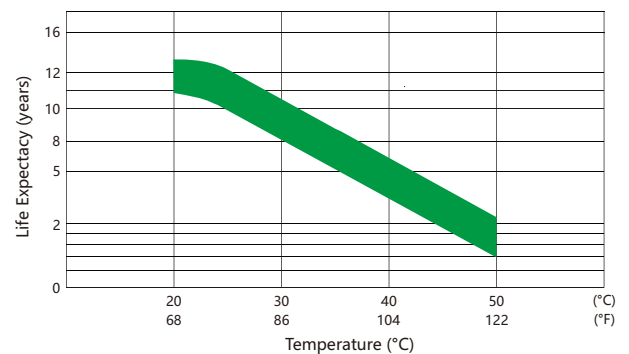

Usage and Maintenance

Charge Current	Equalization Charge	Float Charge
Limited current: $\leq 0.2 C_{10}A$	Constant Voltage: 2.35~2.4V@25°C(77°F) Temp.Coefficient:-4mV/°C	Constant Voltage: 2.23~2.27V@25°C(77°F) Temp.Coefficient:-3mV/°C