

# TN2-2000 [2V 2000Ah]



## Product Features

General Purpose (AGM)		10~12 years of design life@25°C	
100% Model Coverage Both Cycle & Float Application	↑98% Capacity Retention High Purity Electrolyte	↑20% Charge Acceptance Special Negative Additive	↓50% Grid Corrosion Rare-earth patent alloy

## Product Applications

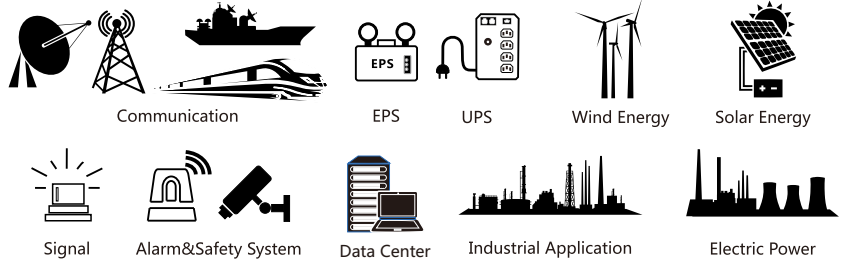

## Physical Specifications

Model	Dimensions (mm/inch)				Weight (kg/lbs)	Terminal	Container
TN2-2000	Length	Width	Height	Total Height	119/262.4	I7	ABS UL94-HB (Optional: FR ABS UL94-V0)
	490/19.3	350/13.8	340/13.4	350/13.8			

## Product Specifications

Nominal Voltage	Rated Capacity@25°C/77°F	Internal Resistance	Max. Discharge Current	Operating Temp. Range
2V	2140Ah 20hr Rate (1.80V/cell) 2000Ah 10hr Rate (1.80V/cell) 1750Ah 5hr Rate (1.75V/cell) 1593Ah 3hr Rate (1.70V/cell)	0.20mΩ@25°C/77°F	12400A (5s)	Discharge:-15~50°C (5~122°F) Charge:0~40°C (32~104°F) Storage:-15~40°C (5~104°F) Optimum:25±2°C (77±4°F)

## Constant Current Discharge (A)@25°C (77°F)

F.V/Time	30min	45min	1h	2h	3h	4h	5h	6h	8h	10h	20h
1.85V/cell	1636	1344	1126	672	491	396	333	291	235	195	105
1.80V/cell	1740	1403	1182	701	511	408	343	299	241	200	107
1.75V/cell	1824	1467	1227	719	523	415	350	306	244	203	108
1.70V/cell	1912	1520	1254	731	531	424	356	311	247	206	110
1.67V/cell	1992	1568	1290	746	539	432	362	315	251	209	112
1.60V/cell	2088	1619	1326	758	548	437	368	318	254	210	114

## Constant Power Discharge (W/cell)@25°C (77°F)

F.V/Time	30min	45min	1h	2h	3h	4h	5h	6h	8h	10h	20h
1.85V/cell	3220	2665	2242	1350	993	803	679	594	482	400	215
1.80V/cell	3414	2774	2347	1404	1029	825	697	609	492	409	219
1.75V/cell	3568	2894	2430	1436	1050	839	710	622	499	415	221
1.70V/cell	3728	2993	2479	1456	1063	853	720	629	503	418	225
1.67V/cell	3874	3080	2543	1482	1076	866	729	635	508	424	228
1.60V/cell	4042	3166	2604	1501	1092	874	739	641	513	425	232

# TN2-2000 [2V 2000Ah]



## Battery Dimensions(mm)

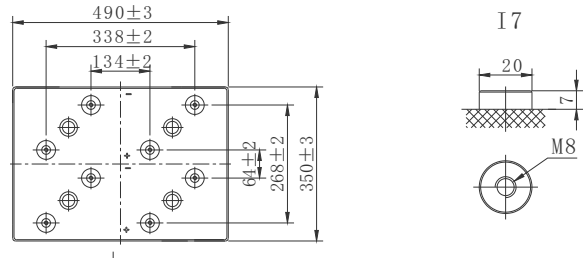
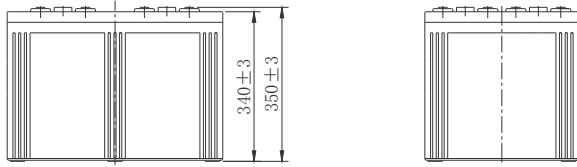

## Electrical Characteristics

### Discharging Characteristics(25°C)

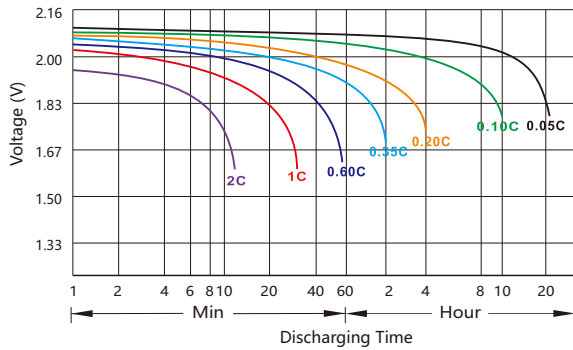

### Charging Characteristics(25°C)

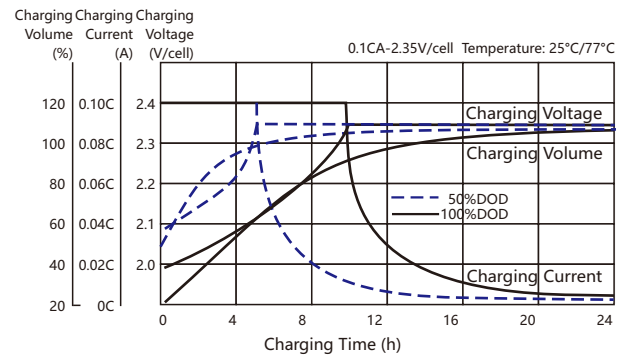

### Capacity vs Temperature

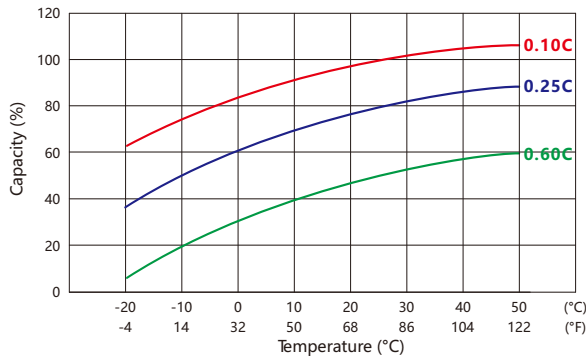

### Self-discharge vs Time

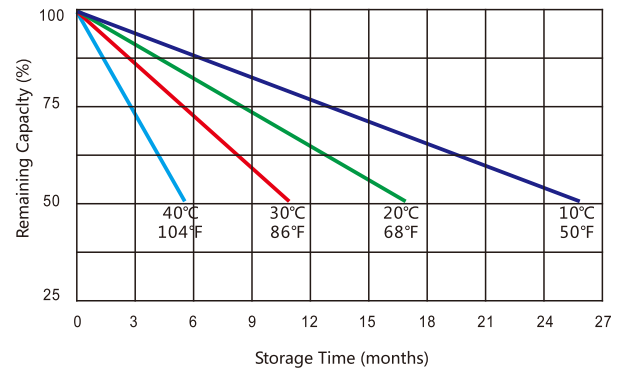

### Cycle Life vs Depth of Discharge

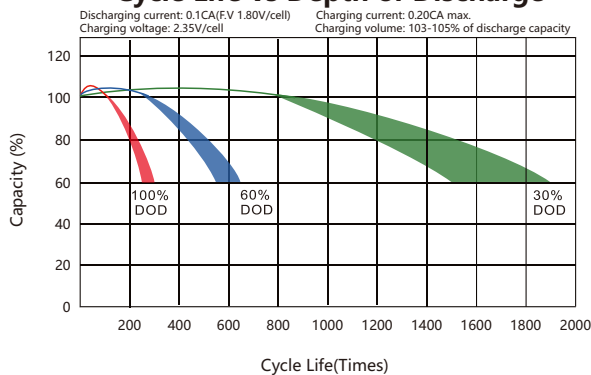

### Floating Life vs Temperature

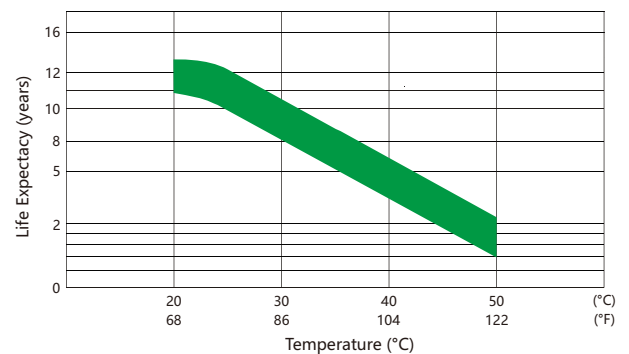

## Usage and Maintenance

Charge Current	Equalization Charge	Float Charge
Limited current: $\leq 0.2 C_{10}A$	Constant Voltage: 2.35~2.4V@25°C(77°F) Temp.Coefficient:-4mV/°C	Constant Voltage: 2.23~2.27V@25°C(77°F) Temp.Coefficient:-3mV/°C