

Motive Battery

Energy Storage Battery

Reserve Battery

Motorcycle Battery



Industry Battery-General Purpose AGM Battery-TN Series

TN2-2500

(2V 2500Ah)

GENERAL FEATURES

- ♦ Oxygen recombination technology: maintenance-free, no need to add water or acid
- ♦ The patent grid alloy: less gassing, low self-discharge, excellent corrosion resistance
- ♦ Design life is 11~13 years at 25°C under standby application, deep discharge recoverability
- ♦ High quality AGM separator: extend cycle life and prevent micro short circuit
- ♦ ABS container: increase the strength of battery (Flame-retardant ABS UL94-V0 is optional)

Dimension

Unit:mm

Length 490±2mm / 19.29inch

Width 350±2mm / 13.78inch

Container Height 339±3mm / 13.35inch

Total Height 349±3mm / 13.74inch

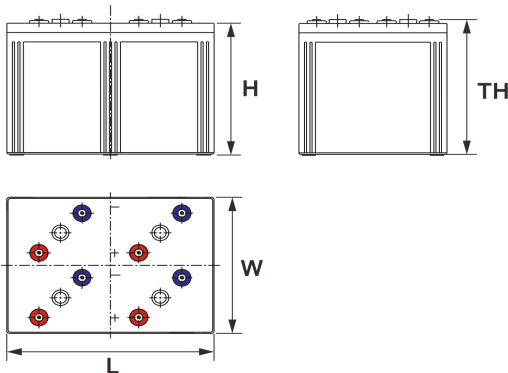

Application

- ♦ Uninterrupted Power Supply (UPS)
- ♦ Communications and electric equipment
- ♦ Emergency lighting equipment
- ♦ Fire alarm and security system
- ♦ Control equipment, and other factory automation equipment
- ♦ Emergency power supply (EPS)
- ♦ Portable VTR/TV, radio and so on
- ♦ Power tools, lawn mowers, vacuum cleaners
- ♦ Cameras and photographic equipment
- ♦ Portable measuring equipment
- ♦ Portable telephone sets
- ♦ Various power toys and hobby equipment
- ♦ Lighting equipment

Terminal

Unit:mm

Terminal Type: I7

Weight

133.5kg 295.16lbs

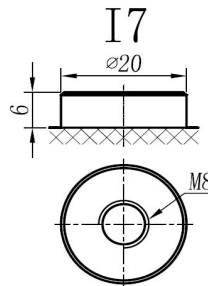

ISO9001 ISO14001 OHSAS18001

This document is subject to change without prior notification

Motive Battery

Energy Storage Battery

Reserve Battery

Motorcycle Battery



TN2-2500

Specificaion

Nominal Voltage	2V	
Rated Capacity(25°C)	2663Ah	20hr Rate (1.80V/cell)
	2500Ah	10hr Rate (1.80V/cell)
	2208Ah	5hr Rate (1.75V/cell)
	1969Ah	3hr Rate (1.70V/cell)
	1540Ah	1hr Rate (1.60V/cell)
Container Material	ABS (Flame-retardant ABS UL94-V0 is optional)	
Operating Temperature Range	Discharge	-20 ~ +50°C
	Charge	0 ~ +40°C
	Storage	-15 ~ +40°C
Capacity Effected by Temperature	40°C / 104°F	106%
	25°C / 77°F	100%
	0°C / 32°F	86%
	-10°C / 14°F	65%
Charge	Float Voltage	2.23 -2.27V/cell@25°C, Tem.Coefficient : -3mV/cell/°C
	Equalize Voltage	2.35 -2.40V/cell@25°C, Tem.Coefficient : -3mV/cell/°C
	Cycle Voltage	2.40 -2.50V/cell@25°C, Tem.Coefficient : -5mV/cell/°C
Max. Charging Current	750A (0.3C)	
Max. Discharge Current (5S)	20000A	
Internal Resistance	0.25mΩ	
Self-Discharge	<3%, TN series stored at 25 °C require a supplementary charge every six months, the charging interval would shrink when the ambient temperature went higher	

Discharge Performance

Constant Current Discharge Table (25°C/77°F) Unit: A											
F.V/Time	30min	45min	1h	2h	3h	4h	5h	6h	8h	10h	20h
1.85V/cell	1918.9	1542.8	1266.21	760.54	587.89	482.73	411.08	357.34	287.85	239.04	128.461
1.80V/cell	\	1623.2	1344.88	802.46	616.61	504.35	428.33	373.30	298.86	250.00	133.125
1.75V/cell	\	1706.7	1403.24	835.65	639.45	521.51	441.53	382.08	304.62	252.75	134.443
1.70V/cell	\	1771.0	1452.36	860.21	656.40	532.88	449.14	388.85	309.36	255.26	135.761
1.67V/cell	\	1848.1	1504.74	886.10	670.71	544.34	458.78	395.62	313.71	258.56	137.485
1.60V/cell	\	1898.1	1540.26	907.21	685.13	551.96	465.38	401.07	317.85	261.56	139.107

Constant Power Discharge Table (25°C/77°F) Unit: W											
F.V/Time	30min	45min	1h	2h	3h	4h	5h	6h	8h	10h	20h
1.85V/cell	3667.2	2925.4	2415.41	1458.96	1133.03	933.73	798.70	699.70	566.17	475.37	255.706
1.80V/cell	\	3057.5	2551.15	1531.83	1182.78	972.17	828.53	728.03	586.09	497.00	264.527
1.75V/cell	\	3196.0	2650.15	1588.99	1223.42	1001.80	851.15	743.04	595.90	501.30	266.858
1.70V/cell	\	3293.4	2728.53	1628.93	1251.05	1019.52	863.26	754.95	604.50	506.01	269.393
1.67V/cell	\	3417.5	2810.81	1670.77	1272.87	1037.84	878.68	765.66	611.61	511.61	272.435
1.60V/cell	\	3477.0	2857.25	1699.80	1293.39	1047.75	887.79	773.87	618.32	516.72	275.172

□ 动力电池

■ 储能电池

■ 备用电池

□ 摩托车电池



阀控式免维护铅酸蓄电池-通用型

TN2-2500

(2V 2500Ah)

产品特点

- ◆ 阀控式免维护设计，寿命期间无需加水或加酸
- ◆ 专利稀土合金板栅，减少气体产生，自放电率低，抗腐蚀能力出众
- ◆ 在25°C下，产品浮充设计寿命为11~13年，优良的深放电恢复能力
- ◆ 高质量AGM隔板：防止微短路，延长循环寿命
- ◆ ABS壳盖：电池外壳强度高（阻燃壳体UL94-V0可选）

尺寸

单个尺寸

长	490±2mm
宽	350±2mm
高	339±3mm
总高	349±3mm

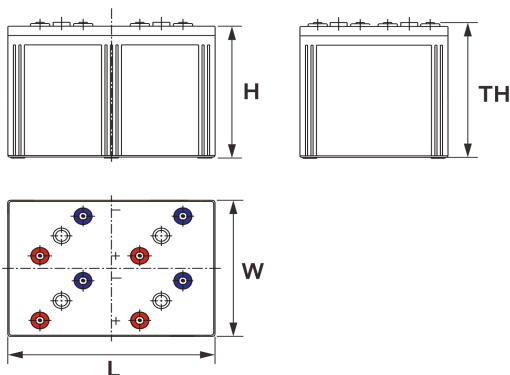

产品应用

- ◆ 不间断电源(UPS)
- ◆ 通信和电力设备
- ◆ 紧急照明设备
- ◆ 火灾报警及安防系统
- ◆ 控制设备及其他机械自动化设备
- ◆ 应急电源系统
- ◆ 便携式音频设备
- ◆ 电动工具，割草机，真空吸尘器
- ◆ 照相设备
- ◆ 便携式测量工具
- ◆ 便携式通话设备
- ◆ 各式电动玩具及娱乐设施
- ◆ 照明设备

端子类型

单位:mm

端子类型 I7

重量

133.5kg 295.16lbs

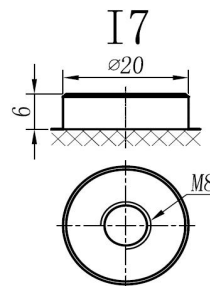

ISO9001 ISO14001 OHSAS18001

内容如有改动，恕不另行通知

动力电池

储能电池

备用电池

摩托车电池



TN2-2500

规格书

额定电压	2V	
额定容量	2663Ah	20hr Rate (1.80V/cell)
	2500Ah	10hr Rate (1.80V/cell)
	2208Ah	5hr Rate (1.75V/cell)
	1969Ah	3hr Rate (1.70V/cell)
	1540Ah	1hr Rate (1.60V/cell)
壳体材料	ABS (阻燃ABS壳体可选)	
使用温度范围	放电	-20 ~ +50°C
	充电	0 ~ +40°C
	储存	-15 ~ +40°C
不同温度下电池容量系数	40°C / 104°F	106%
	25°C / 77°F	100%
	0°C / 32°F	86%
	-10°C / 14°F	65%
充电	浮充电压	2.23 -2.27V/单格@25°C, 温度补偿系数: -3mV/单格/°C
	均充电压	2.35 -2.40V/单格@25°C, 温度补偿系数: -3mV/单格/°C
	循环使用电压	2.40 -2.50V/单格@25°C, 温度补偿系数: -5mV/单格/°C
最大充电电流	750A (0.3C)	
最大放电电流 (5S)	20000A	
电阻	0.25mΩ	
自放电	<3%, TN系列储存在25°C 时需每6个月进行一次补充充电, 环境温度更高时则充电间隔时间越短	

放电性能

恒电流放电表 (25°C/77°F) 单位: A											
F.V/Time	30min	45min	1h	2h	3h	4h	5h	6h	8h	10h	20h
1.85V/cell	1918.9	1542.8	1266.21	760.54	587.89	482.73	411.08	357.34	287.85	239.04	128.461
1.80V/cell	\	1623.2	1344.88	802.46	616.61	504.35	428.33	373.30	298.86	250.00	133.125
1.75V/cell	\	1706.7	1403.24	835.65	639.45	521.51	441.53	382.08	304.62	252.75	134.443
1.70V/cell	\	1771.0	1452.36	860.21	656.40	532.88	449.14	388.85	309.36	255.26	135.761
1.67V/cell	\	1848.1	1504.74	886.10	670.71	544.34	458.78	395.62	313.71	258.56	137.485
1.60V/cell	\	1898.1	1540.26	907.21	685.13	551.96	465.38	401.07	317.85	261.56	139.107

恒功率放电表 (25°C/77°F) 单位: W											
F.V/Time	30min	45min	1h	2h	3h	4h	5h	6h	8h	10h	20h
1.85V/cell	3667.2	2925.4	2415.41	1458.96	1133.03	933.73	798.70	699.70	566.17	475.37	255.706
1.80V/cell	\	3057.5	2551.15	1531.83	1182.78	972.17	828.53	728.03	586.09	497.00	264.527
1.75V/cell	\	3196.0	2650.15	1588.99	1223.42	1001.80	851.15	743.04	595.90	501.30	266.858
1.70V/cell	\	3293.4	2728.53	1628.93	1251.05	1019.52	863.26	754.95	604.50	506.01	269.393
1.67V/cell	\	3417.5	2810.81	1670.77	1272.87	1037.84	878.68	765.66	611.61	511.61	272.435
1.60V/cell	\	3477.0	2857.25	1699.80	1293.39	1047.75	887.79	773.87	618.32	516.72	275.172