

Motive Battery

Energy Storage Battery

Reserve Battery

Motorcycle Battery



Industry Battery-General Purpose AGM Battery-TN Series

TN2-600

(2V 600Ah)

GENERAL FEATURES

- ♦ Oxygen recombination technology: maintenance-free, no need to add water or acid
- ♦ The patent grid alloy: less gassing, low self-discharge, excellent corrosion resistance
- ♦ Design life is 11~13 years at 25°C under standby application, deep discharge recoverability
- ♦ High quality AGM separator: extend cycle life and prevent micro short circuit
- ♦ ABS container: increase the strength of battery (Flame-retardant ABS UL94-V0 is optional)

Dimension

Unit:mm

Length 300±2mm / 11.81inch

Width 175±2mm / 6.89inch

Container Height 330±3mm / 12.99inch

Total Height 350±3mm / 13.78inch

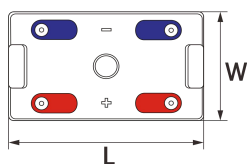
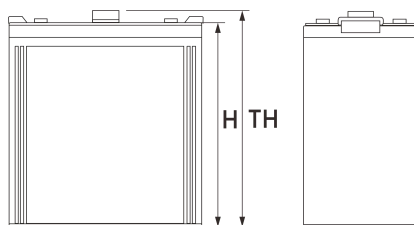

Application

- ♦ Uninterrupted Power Supply (UPS)
- ♦ Communications and electric equipment
- ♦ Emergency lighting equipment
- ♦ Fire alarm and security system
- ♦ Control equipment, and other factory automation equipment
- ♦ Emergency power supply (EPS)
- ♦ Portable VTR/TV, radio and so on
- ♦ Power tools, lawn mowers, vacuum cleaners
- ♦ Cameras and photographic equipment
- ♦ Portable measuring equipment
- ♦ Portable telephone sets
- ♦ Various power toys and hobby equipment
- ♦ Lighting equipment

Terminal

Unit:mm

Terminal Type: I7

Weight

38kg

83.77lbs

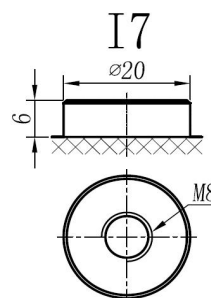

ISO9001 ISO14001 OHSAS18001

This document is subject to change without prior notification

Motive Battery Energy Storage Battery Reserve Battery Motorcycle Battery

TN2-600

Specificaion

Nominal Voltage	2V	
Rated Capacity(25°C)	631Ah	20hr Rate (1.80V/cell)
	601Ah	10hr Rate (1.80V/cell)
	530Ah	5hr Rate (1.75V/cell)
	473Ah	3hr Rate (1.70V/cell)
	370Ah	1hr Rate (1.60V/cell)
Container Material	ABS (Flame-retardant ABS UL94-V0 is optional)	
Operating Temperature Range	Discharge	-20 ~ +50°C
	Charge	0 ~ +40°C
	Storage	-15 ~ +40°C
Capacity Effected by Temperature	40°C / 104°F	106%
	25°C / 77°F	100%
	0°C / 32°F	86%
	-10°C / 14°F	65%
Charge	Float Voltage	2.23 -2.27V/cell@25°C, Tem.Coefficient : -3mV/cell/°C
	Equalize Voltage	2.35 -2.40V/cell@25°C, Tem.Coefficient : -3mV/cell/°C
	Cycle Voltage	2.40 -2.50V/cell@25°C, Tem.Coefficient : -5mV/cell°C
Max. Charging Current	180A (0.3C)	
Max. Discharge Current (5S)	4800A	
Internal Resistance	0.55mΩ	
Self-Discharge	<3%, TN series stored at 25 °C require a supplementary charge every six months, the charging interval would shrink when the ambient temperature went higher	

Discharge Performance

Constant Current Discharge Table (25°C/77°F) Unit: A

F.V/Time	30min	45min	1h	2h	3h	4h	5h	6h	8h	10h	20h
1.85V/cell	460.6	370.3	303.89	182.50	141.09	115.91	98.66	85.75	69.08	57.36	30.430
1.80V/cell	494.2	389.6	322.77	192.55	147.99	121.09	102.82	89.59	71.71	60.06	31.532
1.75V/cell	523.3	409.7	336.78	200.56	153.47	125.15	105.97	91.71	73.12	60.66	31.832
1.70V/cell	549.0	425.1	348.55	206.45	157.53	127.89	107.79	93.32	74.24	61.26	32.132
1.67V/cell	576.0	443.6	361.14	212.64	160.98	130.63	110.13	94.94	75.35	62.06	32.533
1.60V/cell	595.8	455.5	369.66	217.72	164.43	132.46	111.65	96.25	76.26	62.76	32.933

Constant Power Discharge Table (25°C/77°F) Unit: W

F.V/Time	30min	45min	1h	2h	3h	4h	5h	6h	8h	10h	20h
1.85V/cell	880.1	702.1	579.68	350.15	271.87	224.12	191.69	167.97	135.84	114.11	60.561
1.80V/cell	936.7	733.8	612.31	367.67	283.88	233.33	198.80	174.77	140.64	119.32	62.663
1.75V/cell	984.5	767.1	636.04	381.38	293.59	240.44	204.30	178.28	143.04	120.32	63.263
1.70V/cell	1024.2	790.4	654.85	390.89	300.30	244.64	207.21	181.18	145.04	121.42	63.864
1.67V/cell	1066.5	820.2	674.57	401.00	305.51	249.05	210.91	183.78	146.75	122.82	64.565
1.60V/cell	1092.1	834.4	685.79	408.01	310.41	251.45	213.11	185.69	148.45	124.02	65.165

动力电池

储能电池

备用电池

摩托车电池



阀控式免维护铅酸蓄电池 - 通用型

TN2-600

(2V 600Ah)

产品特点

- ◆ 阀控式免维护设计，寿命期间无需加水或加酸
- ◆ 专利稀土合金板栅，减少气体产生，自放电率低，抗腐蚀能力出众
- ◆ 在25°C下，产品浮充设计寿命为11~13年，优良的深放电恢复能力
- ◆ 高质量AGM隔板：防止微短路，延长循环寿命
- ◆ ABS壳盖：电池外壳强度高（阻燃壳体UL94-V0可选）



产品应用

- ◆ 不间断电源(UPS)
- ◆ 通信和电力设备
- ◆ 紧急照明设备
- ◆ 火灾报警及安防系统
- ◆ 控制设备及其他机械自动化设备
- ◆ 应急电源系统
- ◆ 便携式音频设备
- ◆ 电动工具，割草机，真空吸尘器
- ◆ 照相设备
- ◆ 便携式测量工具
- ◆ 便携式通话设备
- ◆ 各式电动玩具及娱乐设施
- ◆ 照明设备

尺寸

单个尺寸

长	300±2mm
宽	175±2mm
高	330±3mm
总高	350±3mm

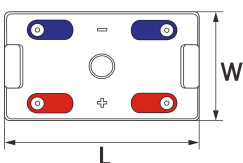
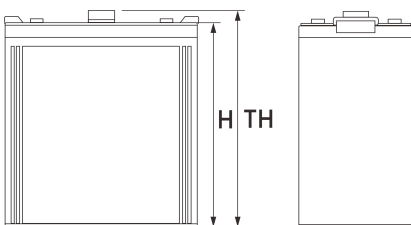

端子类型

单位:mm

端子类型 I7

重量

38kg 83.77lbs

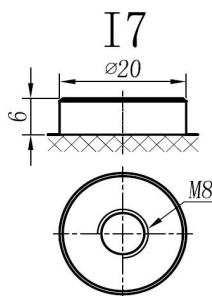

ISO9001 ISO14001 OHSAS18001

内容如有改动，恕不另行通知

动力电池

储能电池

备用电池

摩托车电池



TN2-600

规格书

额定电压	2V	
额定容量	631Ah	20hr Rate (1.80V/cell)
	601Ah	10hr Rate (1.80V/cell)
	530Ah	5hr Rate (1.75V/cell)
	473Ah	3hr Rate (1.70V/cell)
	370Ah	1hr Rate (1.60V/cell)
壳体材料	ABS (阻燃ABS壳体可选)	
使用温度范围	放电	-20 ~ +50°C
	充电	0 ~ +40°C
	储存	-15 ~ +40°C
不同温度下电池容量系数	40°C / 104°F	106%
	25°C / 77°F	100%
	0°C / 32°F	86%
	-10°C / 14°F	65%
充电	浮充电压	2.23 -2.27V/单格@25°C, 温度补偿系数: -3mV/单格/°C
	均充电压	2.35 -2.40V/单格@25°C, 温度补偿系数: -3mV/单格/°C
	循环使用电压	2.40 -2.50V/单格@25°C, 温度补偿系数: -5mV/单格/°C
最大充电电流	180A (0.3C)	
最大放电电流 (5S)	4800A	
电阻	0.55mΩ	
自放电	<3%, TN系列储存在25°C 时需每6个月进行一次补充充电, 环境温度更高时则充电间隔时间越短	

放电性能

恒电流放电表 (25°C/77°F) 单位: A											
F.V/Time	30min	45min	1h	2h	3h	4h	5h	6h	8h	10h	20h
1.85V/cell	460.6	370.3	303.89	182.50	141.09	115.91	98.66	85.75	69.08	57.36	30.430
1.80V/cell	494.2	389.6	322.77	192.55	147.99	121.09	102.82	89.59	71.71	60.06	31.532
1.75V/cell	523.3	409.7	336.78	200.56	153.47	125.15	105.97	91.71	73.12	60.66	31.832
1.70V/cell	549.0	425.1	348.55	206.45	157.53	127.89	107.79	93.32	74.24	61.26	32.132
1.67V/cell	576.0	443.6	361.14	212.64	160.98	130.63	110.13	94.94	75.35	62.06	32.533
1.60V/cell	595.8	455.5	369.66	217.72	164.43	132.46	111.65	96.25	76.26	62.76	32.933

恒功率放电表 (25°C/77°F) 单位: W											
F.V/Time	30min	45min	1h	2h	3h	4h	5h	6h	8h	10h	20h
1.85V/cell	880.1	702.1	579.68	350.15	271.87	224.12	191.69	167.97	135.84	114.11	60.561
1.80V/cell	936.7	733.8	612.31	367.67	283.88	233.33	198.80	174.77	140.64	119.32	62.663
1.75V/cell	984.5	767.1	636.04	381.38	293.59	240.44	204.30	178.28	143.04	120.32	63.263
1.70V/cell	1024.2	790.4	654.85	390.89	300.30	244.64	207.21	181.18	145.04	121.42	63.864
1.67V/cell	1066.5	820.2	674.57	401.00	305.51	249.05	210.91	183.78	146.75	122.82	64.565
1.60V/cell	1092.1	834.4	685.79	408.01	310.41	251.45	213.11	185.69	148.45	124.02	65.165