



TNC12-200P (12V200Ah)

Pb-C技术 Lead Carbon technology	AGM技术 AGM separator	多元稀土合金 Multi-element patent rare earth alloy	HRPSoC技术 HRPSoC technology	15%放电循环 15%DOD ≥10000cycles
--	----------------------------------	--	---	--



应用领域 Product Applications

通信 COMMUNICATION	风能 WIND ENERGY	太阳能 SOLAR ENERGY
数据中心 Data Center	不间断电源 UPS	工业 INDUSTRIAL
	电力 ELECTRIC POWER	

产品特性 Product Specifications

额定电压 Nominal Voltage	额定容量 Rated Capacity (10hr)	内阻 Internal Resistance	短路电流 Short Circuit Current	推荐使用温度范围 Operating Temp. Range
12V	200Ah/2.4kWh (25°C/77°F , 1.80V/cell)	3.5mΩ@25°C(77°F)	2400A(5s)	放电 Discharge : -15~50°C (5~122°F) 充电 Charge : 0~40°C (32~104°F) 储存 Storage : -15~40°C (5~104°F) 最佳 Optimum : 25±3°C (77±5°F)

物理特性 Physical Specifications

材料 Material	端子 Terminal Type	尺寸 Dimensions				重量 Weight
		长 Length	宽 Width	高 Height	总高 TH	
ABS UL94-HB (阻燃 ABS UL94-V0)	I7	522±2mm (20.55 inch.)	268±2mm (10.55 inch.)	220±2mm (8.66 inch.)	225±2mm (8.86 inch.)	72.5kg 159.9(lbs)

恒流放电参数 Constant Current Discharge(A)@25°C(77°F)

终止电压/时间 F.V / Time	5min	10min	15min	20min	30min	45min	1h	2h	3h	4h	5h	6h	8h	10h	20h
1.85V/cell	362.1	254.4	218.1	194.5	161.7	130.5	108.4	65.3	47.7	39.0	33.5	29.4	23.8	19.6	10.5
1.80V/cell	438.0	295.1	243.7	216.0	173.3	137.1	113.4	68.3	49.9	40.3	34.5	30.2	24.4	20.0	10.6
1.75V/cell	501.3	333.3	270.1	233.0	183.4	144.3	118.8	71.0	51.7	41.4	35.2	30.9	24.8	20.3	10.7
1.70V/cell	557.0	360.0	289.7	249.1	192.3	149.5	122.7	73.8	53.4	42.6	36.1	31.6	25.3	20.6	10.8
1.67V/cell	617.8	384.1	301.6	262.1	202.1	155.8	127.0	76.2	54.8	43.8	36.9	32.3	25.6	21.0	11.0
1.60V/cell	653.3	403.2	316.9	271.6	208.8	160.1	130.0	77.7	55.9	44.9	38.0	32.9	26.0	21.3	11.1

恒功率放电参数 Constant Power Discharge(W/cell)@25°C(77°F)

终止电压/时间 F.V / Time	5min	10min	15min	20min	30min	45min	1h	2h	3h	4h	5h	6h	8h	10h	20h
1.85V/cell	676.1	480.6	416.0	374.1	314.5	256.3	213.9	129.7	95.1	78.0	67.3	59.2	48.0	39.8	21.5
1.80V/cell	807.6	550.6	459.2	411.4	333.8	267.1	222.5	134.8	99.1	80.4	68.9	60.5	49.0	40.4	21.7
1.75V/cell	906.2	611.9	502.2	438.7	350.3	279.3	231.8	139.6	102.4	82.2	70.2	61.8	49.8	40.9	22.0
1.70V/cell	984.9	650.8	531.9	465.3	364.6	287.6	238.2	144.7	105.3	84.4	71.7	62.9	50.6	41.6	22.2
1.67V/cell	1073	683.5	548.1	484.7	380.5	298.5	245.6	148.9	107.7	86.3	73.1	64.2	51.3	42.2	22.4
1.60V/cell	1112	705.7	567.3	496.9	389.9	304.1	249.7	150.5	109.2	88.1	74.9	65.1	51.9	42.7	22.6

ISO9001 ISO14001 OHSAS18001 IEC ROHS CE ETS EMC

外形尺寸 Battery Dimensions(mm)

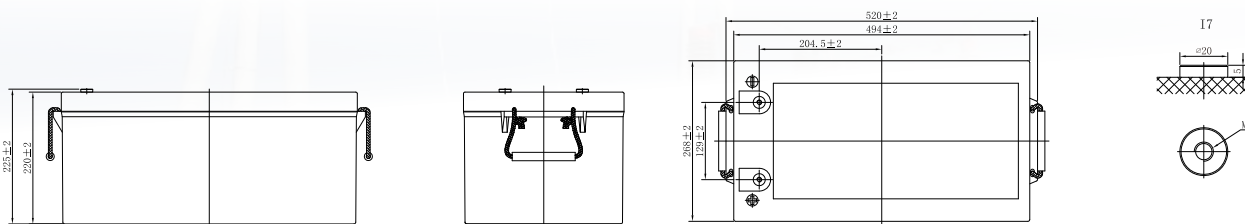

电性能 Electrical Characteristics

不同倍率放电特性 Discharge Characteristics(25°C/77°F)

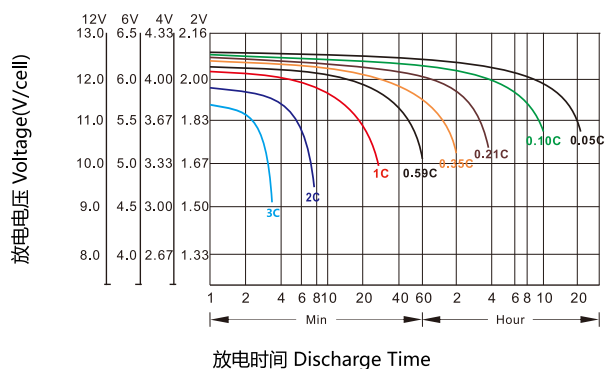

充电特性曲线 Charging Characteristics

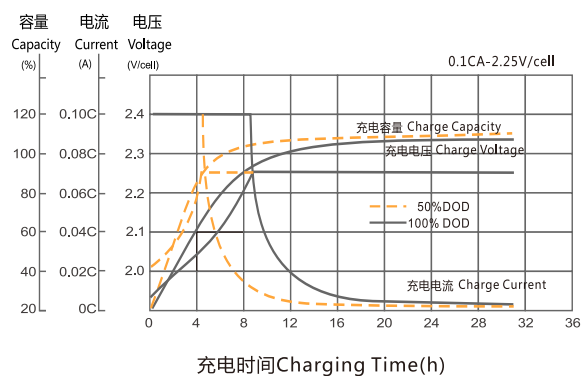

电池容量曲线 Capacity vs Temperature

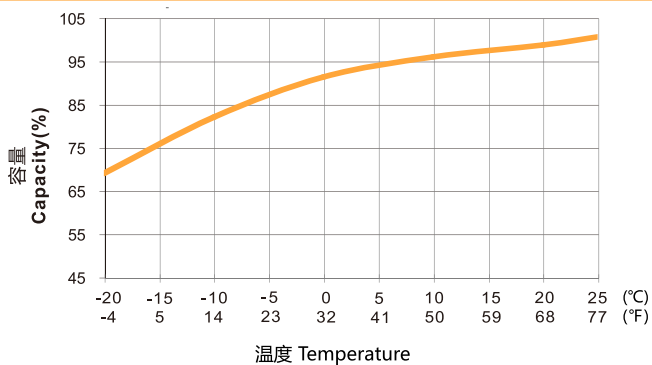

自放电曲线 Self-discharge vs Time

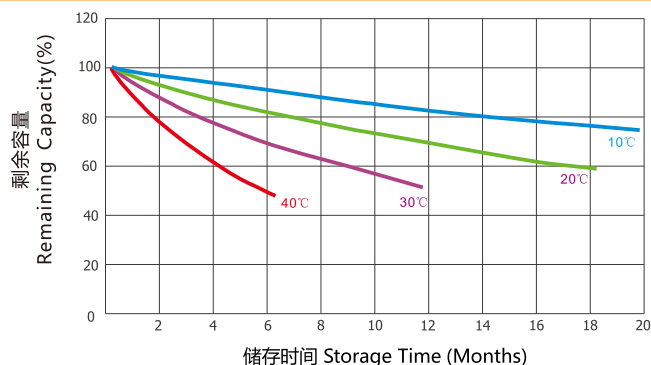

循环次数与放电深度 Cycle Life vs DOD

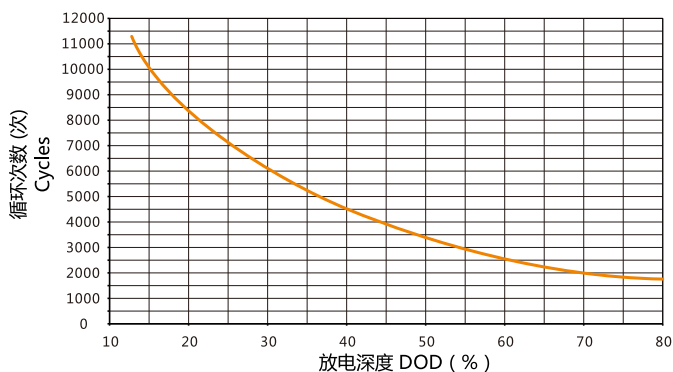

充电时间与放电深度 Charging Time vs DOD

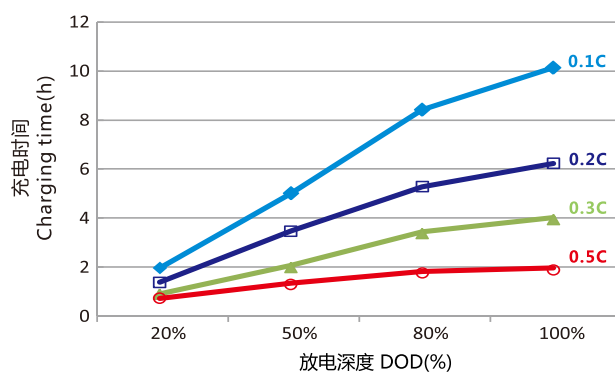

充电电流 Charge Current

限流: $\leq 0.4C_{10A}$
Limited current: $\leq 0.4C_{10A}$

快速充电 Fast Charge

恒压 Constant voltage: 13.8~14.4V@25°C(77°F)
温度补偿系数 Temp. Coefficient: -30mV/°C

浮充充电 Float Charge

恒压 Constant voltage: 13.2~13.8V@25°C(77°F)
温度补偿系数 Temp. Coefficient: -20mV/°C