

Motive Battery

Energy Storage Battery

Reserve Battery

Motorcycle Battery



## Energy Storage Battery-AGM-GEL Technology-TNG Series

# TNG12-200

## (12V 200Ah)

### GENERAL FEATURES

- ◆ Oxygen recombination technology: maintenance-free, no need to add water or acid
- ◆ The patent grid alloy: less gassing, low self-discharge, excellent corrosion resistance
- ◆ Special paste formula: additives for deep discharge, long cycle life
- ◆ High quality AGM separator: extend cycle life and prevent micro short circuit
- ◆ The patent Nano silica electrolytes, extend cycle life and improve the deep discharge performance
- ◆ ABS container: increase the strength of battery (Flame-retardant ABS UL94-V0 is optional)

### Dimension

Unit:mm

Length 520±2mm / 20.47inch

Width 239±2mm / 9.41inch

Container Height 220±3mm / 8.66inch

Total Height 225±3mm / 8.86inch

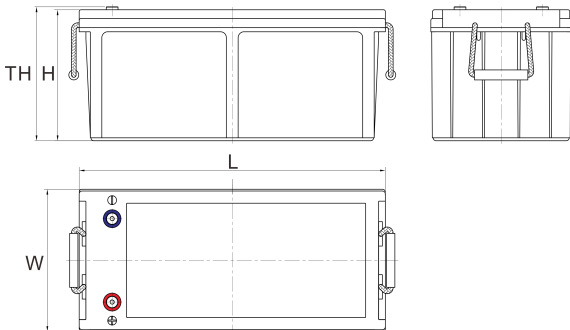

### Application

- ◆ Renewable energy system
- ◆ Hybrid solar power system
- ◆ Uninterrupted Power Supply ( UPS )
- ◆ Communications and electric equipment
- ◆ Emergency lighting equipment
- ◆ Fire alarm and security systems
- ◆ Robots, control equipment, and other factory automation equipment
- ◆ Emergency power supply ( EPS )
- ◆ Various power toy and hobby equipment
- ◆ Lighting equipment

### Terminal

Unit:mm

Terminal Type: I7

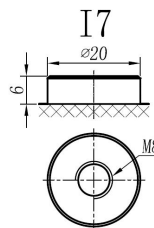

### Weight

63.2kg 139.33lbs



This document is subject to change without prior notification

Motive Battery Energy Storage Battery Reserve Battery Motorcycle Battery

## TNG12-200

### Specification

<b>Nominal Voltage</b>	12V	
	212Ah	20hr Rate(1.80V/cell)
	200Ah	10hr Rate(1.80V/cell)
<b>Rated Capacity(25°C)</b>	172Ah	5hr Rate(1.75V/cell)
	160Ah	3hr Rate(1.70V/cell)
	122Ah	1hr Rate(1.60V/cell)
<b>Container Material</b>	ABS ( Flame-retardant ABS UL94-V0 is optional )	
<b>Operating Temperature Range</b>	<b>Discharge</b>	-20 ~ +50°C
	<b>Charge</b>	0 ~ +40°C
	<b>Storage</b>	-15 ~ +40°C
<b>Capacity Effected by Temperature</b>	<b>40°C / 104°F</b>	106%
	<b>25°C / 77°F</b>	100%
	<b>0°C / 32°F</b>	86%
	<b>-10°C / 14°F</b>	65%
<b>Charge Voltage</b>	<b>Float Voltage</b>	2.25 -2.30V/cell@25°C, Tem. Coefficient: -3mV/cell/°C
	<b>Equalize Voltage</b>	2.35 -2.40V/cell@25°C, Tem. Coefficient: -3mV/cell/°C
	<b>Cycle Voltage</b>	2.40 -2.50V/cell@25°C, Tem. Coefficient: -5mV/cell/°C
<b>Max Charging Current</b>	60A (0.3C)	
<b>Max. Discharge Current (5S)</b>	2000A	
<b>Internal Resistance</b>	2.7mΩ	
<b>Self Discharge</b>	<3%, TN series stored at 25 °C require a supplementary charge every six months, the charging interval would shrink when the ambient temperature went higher	

### Discharge Performance

Constant Current Discharge Table (25°C/77°F) Unit: A														
F.V/Time	10min	15min	20min	30min	45min	1h	2h	3h	4h	5h	6h	8h	10h	20h
1.85V/cell	273.1	235.4	200.7	151.9	114.5	94.28	60.09	46.2	37.6	31.3	27.2	22.10	18.9	10.5
1.80V/cell	337.4	277.0	231.3	176.1	133.2	105.58	65.49	50.6	40.6	33.6	29.2	23.40	20.0	10.6
1.75V/cell	370.6	296.3	245.4	185.6	138.3	110.48	67.98	52.0	41.7	34.5	30.0	23.80	20.2	10.7
1.70V/cell	404.0	316.4	259.0	192.7	143.7	113.97	70.68	53.5	42.7	35.3	30.6	24.20	20.4	10.9
1.65V/cell	435.9	336.4	276.0	200.7	147.3	117.77	72.68	55.8	44.2	36.3	31.3	24.70	20.8	11.0
1.60V/cell	467.3	359.7	291.9	211.9	153.6	121.97	75.08	57.5	45.5	37.3	32.0	25.10	21.0	11.1

Constant Power Discharge Table (25°C/77°F) Unit: W														
F.V/Time	10min	15min	20min	30min	45min	1h	2h	3h	4h	5h	6h	8h	10h	20h
1.85V/cell	504.5	439.3	378.4	289.4	217.1	179.35	115.0	88.84	72.37	60.44	53.02	43.21	37.44	20.400
1.80V/cell	615.8	510.0	429.7	330.5	250.5	199.76	124.6	96.73	77.79	64.58	56.68	45.68	39.54	20.600
1.75V/cell	665.8	538.8	451.4	345.5	257.5	208.04	128.8	99.09	79.57	66.26	58.07	46.38	39.94	20.700
1.70V/cell	709.2	567.2	472.8	356.6	266.8	213.96	133.7	101.66	81.44	67.64	59.16	46.97	40.24	21.100
1.65V/cell	758.4	598.5	500.2	368.6	271.0	219.58	136.6	105.50	83.91	69.22	60.25	47.96	41.04	21.400
1.60V/cell	794.4	629.5	523.3	386.3	281.0	226.18	140.5	108.26	86.08	70.99	61.34	48.56	41.44	21.500

动力电池

储能电池

备用电池

摩托车电池



### 储能电池-AGM-凝胶技术-TNG系列

# TNG12-200

## (12V 200Ah)

### 产品特点

- ◆ 阀控式免维护设计，寿命期间无需加水或加酸
- ◆ 专利稀土合金板栅，减少气体产生，自放电率低，抗腐蚀能力出众
- ◆ 特制组成配方，添加特殊试剂，增进深放电性能，延长循环寿命
- ◆ 高质量AGM隔板：防止微短路，延长循环寿命
- ◆ 纳米硅胶专利电解质，延长循环寿命，增进深放电性能
- ◆ ABS壳盖：电池外壳强度高（阻燃壳体UL94-V0可选）



### 产品应用

- ◆ 可再生能源系统
- ◆ 太阳能混合动力系统
- ◆ 不间断电源 (UPS)
- ◆ 通信及电力设备
- ◆ 应急照明系统
- ◆ 安防及火灾报警系统
- ◆ 机械自动化控制设备
- ◆ 应急电源 (EPS)
- ◆ 各式电动玩具及娱乐设施
- ◆ 照明设备

### 尺寸

单个尺寸

长	520±2mm / 20.47inch
宽	239±2mm / 9.41inch
高	220±3mm / 8.66inch
总高	225±3mm / 8.86inch

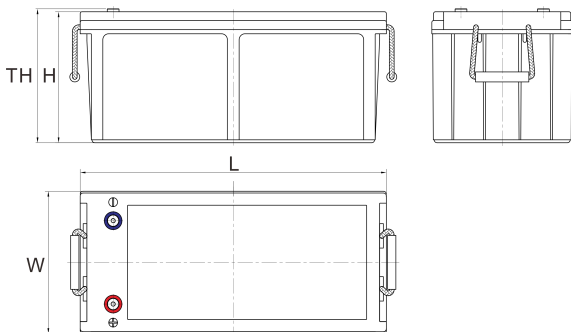

### 端子类型

单位:mm

端子类型 I7

### 重量

63.2kg 139.33lbs

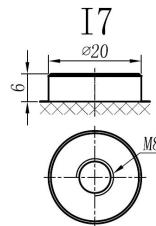

ISO9001 ISO14001 OHSAS18001

内容如有改动，恕不另行通知

动力电池 储能电池 备用电池 摩托车电池

## TNG12-200

### 规格书

额定电压	12V	
容量(25°C)	212Ah	20hr Rate(1.80V/cell)
	200Ah	10hr Rate(1.80V/cell)
	172Ah	5hr Rate(1.75V/cell)
	160Ah	3hr Rate(1.70V/cell)
	122Ah	1hr Rate(1.60V/cell)
壳体材料	ABS (阻燃ABS壳体可选)	
使用温度范围	放电	-20 ~ +50°C
	充电	0 ~ +40°C
	储存	-15 ~ +40°C
不同温度下电 池容量系数	40°C / 104°F	106%
	25°C / 77°F	100%
	0°C / 32°F	86%
	-10°C / 14°F	65%
充电电压	浮充	2.25 -2.30V/单格@25°C, 温度补偿系数: -3mV/单格/°C
	均充	2.35 -2.40V/单格@25°C, 温度补偿系数: -3mV/单格/°C
	循环使用	2.40 -2.50V/单格@25°C, 温度补偿系数: -5mV/单格/°C
最大充电电流	60A (0.3C)	
最大放电电流(5S)	2000A	
电阻	2.7mΩ	
自放电	<3%, TN系列储存在25°C 时需每6个月进行一次补充充电, 环境温度更高时则充电间隔时间越短	

### 放电性能

恒电流放电表 (25°C/77°F) 单位: A														
F.V/Time	10min	15min	20min	30min	45min	1h	2h	3h	4h	5h	6h	8h	10h	20h
1.85V/cell	273.1	235.4	200.7	151.9	114.5	94.28	60.09	46.19	37.59	31.29	27.20	22.10	18.92	10.517
1.80V/cell	337.4	277.0	231.3	176.1	133.2	105.58	65.49	50.59	40.59	33.59	29.20	23.40	20.02	10.619
1.75V/cell	370.6	296.3	245.4	185.6	138.3	110.48	67.98	51.99	41.69	34.49	30.00	23.80	20.22	10.721
1.70V/cell	404.0	316.4	259.0	192.7	143.7	113.97	70.68	53.49	42.69	35.29	30.60	24.20	20.42	10.925
1.65V/cell	435.9	336.4	276.0	200.7	147.3	117.77	72.68	55.79	44.19	36.29	31.30	24.70	20.82	11.027
1.60V/cell	467.3	359.7	291.9	211.9	153.6	121.97	75.08	57.49	45.49	37.29	32.00	25.10	21.02	11.129

恒功率放电表 (25°C/77°F) 单位: W														
F.V/Time	10min	15min	20min	30min	45min	1h	2h	3h	4h	5h	6h	8h	10h	20h
1.85V/cell	504.5	439.3	378.4	289.4	217.1	179.35	114.97	88.84	72.37	60.44	53.02	43.21	37.44	20.400
1.80V/cell	615.8	510.0	429.7	330.5	250.5	199.76	124.63	96.73	77.79	64.58	56.68	45.68	39.54	20.600
1.75V/cell	665.8	538.8	451.4	345.5	257.5	208.04	128.77	99.09	79.57	66.26	58.07	46.38	39.94	20.700
1.70V/cell	709.2	567.2	472.8	356.6	266.8	213.96	133.70	101.66	81.44	67.64	59.16	46.97	40.24	21.100
1.65V/cell	758.4	598.5	500.2	368.6	271.0	219.58	136.56	105.50	83.91	69.22	60.25	47.96	41.04	21.400
1.60V/cell	794.4	629.5	523.3	386.3	281.0	226.18	140.50	108.26	86.08	70.99	61.34	48.56	41.44	21.500