

Motive Battery

Energy Storage Battery

Reserve Battery

Motorcycle Battery



Energy Storage Battery-AGM-GEL Technology-TNG Series

TNG12-250

(12V 250Ah)

GENERAL FEATURES

- ◆ Oxygen recombination technology: maintenance-free, no need to add water or acid
- ◆ The patent grid alloy: less gassing, low self-discharge, excellent corrosion resistance
- ◆ Special paste formula: additives for deep discharge, long cycle life
- ◆ High quality AGM separator: extend cycle life and prevent micro short circuit
- ◆ The patent Nano silica electrolytes, extend cycle life and improve the deep discharge performance
- ◆ ABS container: increase the strength of battery (Flame-retardant ABS UL94-V0 is optional)



Application

- ◆ Renewable energy system
- ◆ Hybrid solar power system
- ◆ Uninterrupted Power Supply (UPS)
- ◆ Communications and electric equipment
- ◆ Emergency lighting equipment
- ◆ Fire alarm and security systems
- ◆ Robots, control equipment, and other factory automation equipment
- ◆ Emergency power supply (EPS)
- ◆ Various power toy and hobby equipment
- ◆ Lighting equipment

Dimension

Unit:mm

Length 520±2mm / 20.47inch

Width 268±2mm / 10.55inch

Container Height 223±3mm / 8.78inch

Total Height 223±3mm / 8.78inch

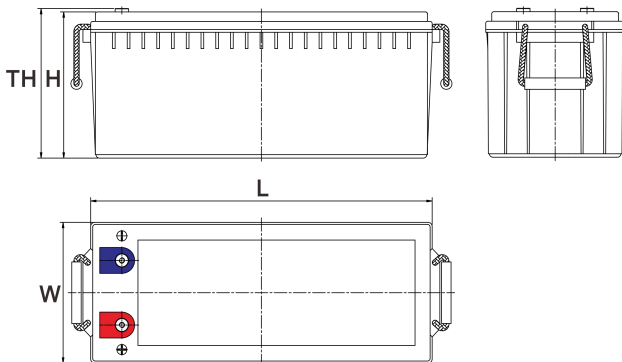

Terminal

Unit:mm

Terminal Type: I7

Weight

74.5kg 164.24lbs

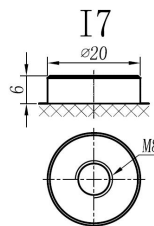

ISO9001 ISO14001 OHSAS18001

This document is subject to change without prior notification

Motive Battery Energy Storage Battery Reserve Battery Motorcycle Battery

TNG12-250

Specificaion

Nominal Voltage	12V	
	265Ah	20hr Rate(1.80V/cell)
	250Ah	10hr Rate(1.80V/cell)
Rated Capacity(25°C)	215Ah	5hr Rate(1.75V/cell)
	201Ah	3hr Rate(1.70V/cell)
	152Ah	1hr Rate(1.60V/cell)
Container Material	ABS (Flame-retardant ABS UL94-V0 is optional)	
Operating Temperature Range	Discharge	-20 ~ +50°C
	Charge	0 ~ +40°C
	Storage	-15 ~ +40°C
Capacity Effected by Temperature	40°C / 104°F	106%
	25°C / 77°F	100%
	0°C / 32°F	86%
	-10°C / 14°F	65%
Charge Voltage	Float Voltage	2.25 -2.30V/cell@25°C, Tem. Coefficient: -3mV/cell/°C
	Equalize Voltage	2.35 -2.40V/cell@25°C, Tem. Coefficient: -3mV/cell/°C
	Cycle Voltage	2.40 -2.50V/cell@25°C, Tem. Coefficient: -5mV/cell/°C
Max Charging Current	75A (0.3C)	
Max. Discharge Current (5S)	2500A	
Internal Resistance	2.5mΩ	
Self Discharge	<3%, TN series stored at 25 °C require a supplementary charge every six months, the charging interval would shrink when the ambient temperature went higher	

Discharge Performance

Constant Current Discharge Table (25°C/77°F) Unit: A														
F.V/Time	10min	15min	20min	30min	45min	1h	2h	3h	4h	5h	6h	8h	10h	20h
1.85V/cell	330.0	280.7	234.7	186.6	143.1	117.9	75.1	59.39	48.49	39.09	34.00	27.60	23.62	13.171
1.80V/cell	421.6	339.1	277.5	220.1	166.5	132.0	81.9	63.89	51.79	41.99	36.50	29.30	25.03	13.273
1.75V/cell	463.3	370.4	298.5	228.6	172.8	138.1	85.0	65.09	52.89	42.99	37.50	29.80	25.33	13.375
1.70V/cell	\	395.4	313.7	237.9	179.7	142.5	88.4	66.88	54.29	44.19	38.30	30.20	25.53	13.682
1.65V/cell	\	420.4	333.2	250.9	184.2	147.3	90.8	69.68	56.19	45.39	39.10	30.70	26.03	13.784
1.60V/cell	\	449.7	355.0	265.0	192.0	152.5	93.9	71.88	57.99	46.89	40.00	31.00	26.33	13.886

Constant Power Discharge Table (25°C/77°F) Unit: W														
F.V/Time	10min	15min	20min	30min	45min	1h	2h	3h	4h	5h	6h	8h	10h	20h
1.85V/cell	609.6	523.6	442.4	355.6	271.4	224.1	143.8	114.08	93.47	75.53	66.30	54.01	46.75	25.270
1.80V/cell	769.7	624.2	515.3	413.2	313.2	249.8	155.8	122.06	99.29	80.75	70.86	57.18	49.45	25.468
1.75V/cell	832.2	673.4	549.1	425.4	322.0	260.1	161.0	123.84	101.16	82.63	72.54	57.97	49.85	25.667
1.70V/cell	\	709.0	572.7	440.3	333.5	267.4	167.0	127.09	103.63	84.50	73.93	58.77	50.35	26.162
1.65V/cell	\	748.1	603.9	460.7	338.8	274.4	170.8	131.83	106.78	86.57	75.32	59.56	51.25	26.459
1.60V/cell	\	786.8	636.3	482.9	351.2	282.7	175.6	135.28	109.74	89.13	76.70	59.95	51.75	26.559

动力电池

储能电池

备用电池

摩托车电池



储能电池-AGM-凝胶技术-TNG系列

TNG12-250

(12V 250Ah)

产品特点

- ◆ 阀控式免维护设计，寿命期间无需加水或加酸
- ◆ 专利稀土合金板栅，减少气体产生，自放电率低，抗腐蚀能力出众
- ◆ 特制组成配方，添加特殊试剂，增进深放电性能，延长循环寿命
- ◆ 高质量AGM隔板：防止微短路，延长循环寿命
- ◆ 纳米硅胶专利电解质，延长循环寿命，增进深放电性能
- ◆ ABS壳盖：电池外壳强度高（阻燃壳体UL94-V0可选）

产品应用

- ◆ 可再生能源系统
- ◆ 太阳能混合动力系统
- ◆ 不间断电源 (UPS)
- ◆ 通信及电力设备
- ◆ 应急照明系统
- ◆ 安防及火灾报警系统
- ◆ 机械自动化控制设备
- ◆ 应急电源 (EPS)
- ◆ 各式电动玩具及娱乐设施
- ◆ 照明设备

尺寸

单个尺寸

长	520±2mm / 20.47inch
宽	268±2mm / 10.55inch
高	223±3mm / 8.78inch
总高	223±3mm / 8.78inch

端子类型

单位:mm

端子类型 I7

重量

74.5kg 164.24lbs

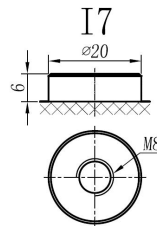

内容如有改动，恕不另行通知

动力电池 储能电池 备用电池 摩托车电池

TNG12-250

规格书

额定电压	12V	
容量(25°C)	265Ah	20hr Rate(1.80V/cell)
	250Ah	10hr Rate(1.80V/cell)
	215Ah	5hr Rate(1.75V/cell)
	201Ah	3hr Rate(1.70V/cell)
	152Ah	1hr Rate(1.60V/cell)
壳体材料	ABS (阻燃ABS壳体可选)	
使用温度范围	放电	-20 ~ +50°C
	充电	0 ~ +40°C
	储存	-15 ~ +40°C
不同温度下电 池容量系数	40°C / 104°F	106%
	25°C / 77°F	100%
	0°C / 32°F	86%
	-10°C / 14°F	65%
充电电压	浮充	2.25 -2.30V/单格@25°C, 温度补偿系数: -3mV/单格/°C
	均充	2.35 -2.40V/单格@25°C, 温度补偿系数: -3mV/单格/°C
	循环使用	2.40 -2.50V/单格@25°C, 温度补偿系数: -5mV/单格/°C
最大充电电流	75A (0.3C)	
最大放电电流(5S)	2500A	
电阻	2.5mΩ	
自放电	<3%, TN系列储存在25°C 时需每6个月进行一次补充充电, 环境温度更高时则充电间隔时间越短	

放电性能

F.V/Time	恒电流放电表 (25°C/77°F) 单位: A													
	10min	15min	20min	30min	45min	1h	2h	3h	4h	5h	6h	8h	10h	20h
1.85V/cell	330.0	280.7	234.7	186.6	143.1	117.9	75.1	59.39	48.49	39.09	34.00	27.60	23.62	13.171
1.80V/cell	421.6	339.1	277.5	220.1	166.5	132.0	81.9	63.89	51.79	41.99	36.50	29.30	25.03	13.273
1.75V/cell	463.3	370.4	298.5	228.6	172.8	138.1	85.0	65.09	52.89	42.99	37.50	29.80	25.33	13.375
1.70V/cell	\	395.4	313.7	237.9	179.7	142.5	88.4	66.88	54.29	44.19	38.30	30.20	25.53	13.682
1.65V/cell	\	420.4	333.2	250.9	184.2	147.3	90.8	69.68	56.19	45.39	39.10	30.70	26.03	13.784
1.60V/cell	\	449.7	355.0	265.0	192.0	152.5	93.9	71.88	57.99	46.89	40.00	31.00	26.33	13.886

F.V/Time	恒功率放电表 (25°C/77°F) 单位: W													
	10min	15min	20min	30min	45min	1h	2h	3h	4h	5h	6h	8h	10h	20h
1.85V/cell	609.6	523.6	442.4	355.6	271.4	224.1	143.8	114.08	93.47	75.53	66.30	54.01	46.75	25.270
1.80V/cell	769.7	624.2	515.3	413.2	313.2	249.8	155.8	122.06	99.29	80.75	70.86	57.18	49.45	25.468
1.75V/cell	832.2	673.4	549.1	425.4	322.0	260.1	161.0	123.84	101.16	82.63	72.54	57.97	49.85	25.667
1.70V/cell	\	709.0	572.7	440.3	333.5	267.4	167.0	127.09	103.63	84.50	73.93	58.77	50.35	26.162
1.65V/cell	\	748.1	603.9	460.7	338.8	274.4	170.8	131.83	106.78	86.57	75.32	59.56	51.25	26.459
1.60V/cell	\	786.8	636.3	482.9	351.2	282.7	175.6	135.28	109.74	89.13	76.70	59.95	51.75	26.559