

Motive Battery

Energy Storage Battery

Reserve Battery

Motorcycle Battery



## Energy Storage Battery-AGM-GEL Technology-TNG Series

# TNG12-55

## (12V 55Ah)

### GENERAL FEATURES

- ◆ Oxygen recombination technology: maintenance-free, no need to add water or acid
- ◆ The patent grid alloy: less gassing, low self-discharge, excellent corrosion resistance
- ◆ Special paste formula: additives for deep discharge, long cycle life
- ◆ High quality AGM separator: extend cycle life and prevent micro short circuit
- ◆ The patent Nano silica electrolytes, extend cycle life and improve the deep discharge performance
- ◆ ABS container: increase the strength of battery (Flame-retardant ABS UL94-V0 is optional)



### Application

- ◆ Renewable energy system
- ◆ Hybrid solar power system
- ◆ Uninterrupted Power Supply ( UPS )
- ◆ Communications and electric equipment
- ◆ Emergency lighting equipment
- ◆ Fire alarm and security systems
- ◆ Control and other automation equipment
- ◆ Emergency power supply ( EPS )
- ◆ Various power toy and hobby equipment
- ◆ Lighting equipment

### Dimension

Unit:mm

Length	229±2mm / 9.02inch
Width	138.5±2mm / 5.45inch
Container Height	211±3mm / 8.31inch
Total Height	216±3mm / 8.5inch

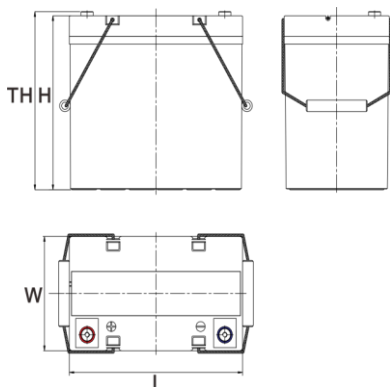

### Terminal

Unit:mm

Terminal Type I3

### Weight

16.55kg 36.49lbs

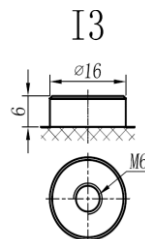

ISO9001 ISO14001 OHSAS18001

This document is subject to change without prior notification

Motive Battery

 Energy Storage Battery

 Reserve Battery

 Motorcycle Battery

## TNG12-55

### Specification

<b>Nominal Voltage</b>	12V	
	58Ah	20hr Rate(1.80V/cell)
	55Ah	10hr Rate(1.80V/cell)
<b>Rated Capacity(25°C)</b>	47Ah	5hr Rate(1.75V/cell)
	44Ah	3hr Rate(1.70V/cell)
	34Ah	1hr Rate(1.60V/cell)
<b>Container Material</b>	ABS ( Flame-retardant ABS UL94-V0 is optional )	
<b>Operating Temperature Range</b>	<b>Discharge</b>	-20 ~ +50°C
	<b>Charge</b>	0 ~ +40°C
	<b>Storage</b>	-15 ~ +40°C
<b>Capacity Effected by Temperature</b>	<b>40°C / 104°F</b>	106%
	<b>25°C / 77°F</b>	100%
	<b>0°C / 32°F</b>	86%
	<b>-10°C / 14°F</b>	65%
<b>Charge Voltage</b>	<b>Float Voltage</b>	2.25 -2.30V/cell@25°C, Tem. Coefficient: -3mV/cell/°C
	<b>Equalize Voltage</b>	2.35 -2.40V/cell@25°C, Tem. Coefficient: -3mV/cell/°C
	<b>Cycle Voltage</b>	2.40 -2.50V/cell@25°C, Tem. Coefficient: -5mV/cell°C
<b>Max Charging Current</b>	16.5A (0.3C)	
<b>Max. Discharge Current (5S)</b>	660A	
<b>Internal Resistance</b>	7.5mΩ	
<b>Self Discharge</b>	<3%, TNG series stored at 25 °C require a supplementary charge every six months, the charging interval would shrink when the ambient temperature went higher	

### Discharge Performance

Constant Current Discharge Table (25°C/77°F) Unit: A															
F.V/Time	5min	10min	15min	20min	30min	45min	1h	2h	3h	4h	5h	6h	8h	10h	20h
1.85V/cell	92.3	72.6	61.7	51.6	41.0	31.5	25.89	16.50	13.10	10.70	8.60	7.49	6.08	5.20	2.889
1.80V/cell	124.0	92.8	74.6	61.0	48.5	36.6	28.99	18.00	14.10	11.40	9.23	8.03	6.45	5.51	2.920
1.75V/cell	139.8	101.9	81.5	65.6	50.3	38.0	30.39	18.70	14.30	11.60	9.46	8.25	6.56	5.57	2.951
1.70V/cell	153.9	111.1	87.0	69.1	52.3	39.5	31.29	19.40	14.70	11.90	9.71	8.42	6.65	5.62	3.002
1.65V/cell	169.7	119.9	92.5	73.3	55.2	40.5	32.39	20.00	15.30	12.40	9.98	8.61	6.75	5.74	3.043
1.60V/cell	187.2	130.2	98.9	78.1	58.3	42.3	33.59	20.70	15.80	12.70	10.30	8.79	6.82	5.80	3.063

Constant Power Discharge Table (25°C/77°F) Unit: W															
F.V/Time	5min	10min	15min	20min	30min	45min	1h	2h	3h	4h	5h	6h	8h	10h	20h
1.85V/cell	168.8	134.1	115.2	97.3	78.2	59.7	49.30	31.65	25.14	20.61	16.66	14.57	11.89	10.31	5.610
1.80V/cell	224.3	169.3	137.3	113.4	90.9	68.9	54.92	34.31	26.82	21.89	17.75	15.56	12.59	10.91	5.660
1.75V/cell	247.4	183.1	148.1	120.8	93.6	70.8	57.19	35.40	27.21	22.28	18.14	15.95	12.78	11.01	5.700
1.70V/cell	264.9	195.0	156.0	126.0	96.8	73.4	58.86	36.78	28.00	22.78	18.64	16.25	12.88	11.11	5.810
1.65V/cell	288.0	208.6	164.6	132.8	101.3	74.6	60.34	37.57	28.99	23.47	19.03	16.55	13.08	11.31	5.880
1.60V/cell	310.3	221.2	173.1	140.0	106.2	77.3	62.22	38.65	29.78	24.16	19.62	16.85	13.18	11.41	5.900

动力电池

储能电池

备用电池

摩托车电池



### 储能电池-AGM-凝胶技术-TNG系列

# TNG12-55

## (12V 55Ah)

### 产品特点

- ◆ 阀控式免维护设计，寿命期间无需加水或加酸
- ◆ 专利稀土合金板栅，减少气体产生，自放电率低，抗腐蚀能力出众
- ◆ 特制组成配方，添加特殊试剂，增进深放电性能，延长循环寿命
- ◆ 高质量AGM隔板：防止微短路，延长循环寿命
- ◆ 纳米硅胶专利电解质，延长循环寿命，增进深放电性能
- ◆ ABS壳盖：电池外壳强度高（阻燃壳体UL94-V0可选）

### 产品应用

- ◆ 可再生能源系统
- ◆ 太阳能混合动力系统
- ◆ 不间断电源 (UPS)
- ◆ 通信及电力设备
- ◆ 应急照明系统
- ◆ 安防及火灾报警系统
- ◆ 机械自动化控制设备
- ◆ 应急电源 (EPS)
- ◆ 各式电动玩具及娱乐设施
- ◆ 照明设备

### 尺寸

单个尺寸

长	229±2mm / 9.02inch
宽	38.5±2mm / 5.45inch
高	211±3mm / 8.31inch
总高	216±3mm / 8.5inch

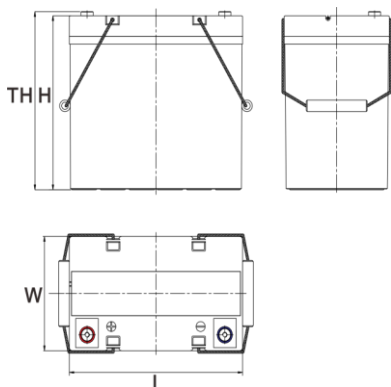

### 端子类型

单位:mm

端子类型 I3

### 重量

16.55kg 36.49lbs

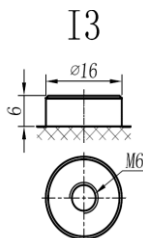

ISO9001 ISO14001 OHSAS18001

内容如有改动，恕不另行通知

动力电池

储能电池

备用电池

摩托车电池



## TNG12-55

### 规格书

额定电压	12V	
容量(25°C)	58Ah	20hr Rate(1.80V/cell)
	55Ah	10hr Rate(1.80V/cell)
	47Ah	5hr Rate(1.75V/cell)
	44Ah	3hr Rate(1.70V/cell)
	34Ah	1hr Rate(1.60V/cell)
壳体材料	ABS (阻燃ABS壳体可选)	
使用温度范围	放电	-20 ~ +50°C
	充电	0 ~ +40°C
	储存	-15 ~ +40°C
不同温度下电 池容量系数	40°C / 104°F	106%
	25°C / 77°F	100%
	0°C / 32°F	86%
	-10°C / 14°F	65%
充电电压	浮充	2.25 -2.30V/单格@25°C, 温度补偿系数: -3mV/单格/°C
	均充	2.35 -2.40V/单格@25°C, 温度补偿系数: -3mV/单格/°C
	循环使用	2.40 -2.50V/单格@25°C, 温度补偿系数: -5mV/单格/°C
最大充电电流	16.5A (0.3C)	
最大放电电流(5S)	660A	
电阻	7.5mΩ	
自放电	<3%, TN系列储存在25°C 时需每6个月进行一次补充充电, 环境温度更高时则充电间隔时间越短	

### 放电性能

恒电流放电表 (25°C/77°F) 单位: A

F.V/Time	5min	10min	15min	20min	30min	45min	1h	2h	3h	4h	5h	6h	8h	10h	20h
1.85V/cell	92.3	72.6	61.7	51.6	41.0	31.5	25.89	16.50	13.10	10.70	8.60	7.49	6.08	5.20	2.889
1.80V/cell	124.0	92.8	74.6	61.0	48.5	36.6	28.99	18.00	14.10	11.40	9.23	8.03	6.45	5.51	2.920
1.75V/cell	139.8	101.9	81.5	65.6	50.3	38.0	30.39	18.70	14.30	11.60	9.46	8.25	6.56	5.57	2.951
1.70V/cell	153.9	111.1	87.0	69.1	52.3	39.5	31.29	19.40	14.70	11.90	9.71	8.42	6.65	5.62	3.002
1.65V/cell	169.7	119.9	92.5	73.3	55.2	40.5	32.39	20.00	15.30	12.40	9.98	8.61	6.75	5.74	3.043
1.60V/cell	187.2	130.2	98.9	78.1	58.3	42.3	33.59	20.70	15.80	12.70	10.30	8.79	6.82	5.80	3.063

恒功率放电表 (25°C/77°F) 单位: W

F.V/Time	5min	10min	15min	20min	30min	45min	1h	2h	3h	4h	5h	6h	8h	10h	20h
1.85V/cell	168.8	134.1	115.2	97.3	78.2	59.7	49.30	31.65	25.14	20.61	16.66	14.57	11.89	10.31	5.610
1.80V/cell	224.3	169.3	137.3	113.4	90.9	68.9	54.92	34.31	26.82	21.89	17.75	15.56	12.59	10.91	5.660
1.75V/cell	247.4	183.1	148.1	120.8	93.6	70.8	57.19	35.40	27.21	22.28	18.14	15.95	12.78	11.01	5.700
1.70V/cell	264.9	195.0	156.0	126.0	96.8	73.4	58.86	36.78	28.00	22.78	18.64	16.25	12.88	11.11	5.810
1.65V/cell	288.0	208.6	164.6	132.8	101.3	74.6	60.34	37.57	28.99	23.47	19.03	16.55	13.08	11.31	5.880
1.60V/cell	310.3	221.2	173.1	140.0	106.2	77.3	62.22	38.65	29.78	24.16	19.62	16.85	13.18	11.41	5.900