

Motive Battery

Energy Storage Battery

Reserve Battery

Motorcycle Battery



## Energy Storage Battery-AGM-GEL Technology-TNG Series

# TNG2-200

(2V 200Ah)

## GENERAL FEATURES

- ◆ Oxygen recombination technology: maintenance-free, no need to add water or acid
- ◆ The patent grid alloy: less gassing, low self-discharge, excellent corrosion resistance
- ◆ Special paste formula: additives for deep discharge, long cycle life
- ◆ High quality AGM separator: extend cycle life and prevent micro short circuit
- ◆ The patent Nano silica electrolytes, extend cycle life and improve the deep discharge performance
- ◆ ABS container: increase the strength of battery (Flame-retardant ABS UL94-V0 is optional)



## Application

- ◆ Renewable energy system
- ◆ Hybrid solar power system
- ◆ Uninterrupted Power Supply ( UPS )
- ◆ Communications and electric equipment
- ◆ Emergency lighting equipment
- ◆ Fire alarm and security systems
- ◆ Control and other automation equipment
- ◆ Emergency power supply ( EPS )
- ◆ Various power toy and hobby equipment
- ◆ Lighting equipment

## Dimension

Unit:mm

Length	170±2mm / 6.69inch
Width	106±2mm / 4.17inch
Container Height	330±3mm / 12.99inch
Total Height	342±3mm / 13.46inch

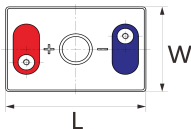
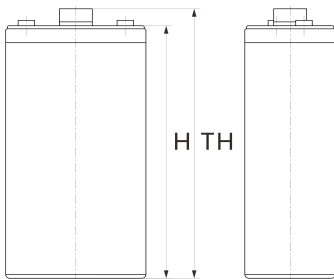

## Terminal

Unit:mm

Terminal Type: I7

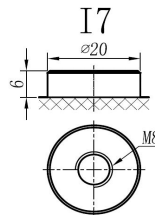

## Weight

12.8kg 28.3lbs



This document is subject to change without prior notification

Motive Battery Energy Storage Battery Reserve Battery Motorcycle Battery

## TNG2-200

### Specificaion

<b>Nominal Voltage</b>	2V	
	214Ah	20hr Rate(1.80V/cell)
	200Ah	10hr Rate(1.80V/cell)
<b>Rated Capacity(25°C)</b>	174Ah	5hr Rate(1.75V/cell)
	155Ah	3hr Rate(1.70V/cell)
	121Ah	1hr Rate(1.60V/cell)
<b>Container Material</b>	ABS ( Flame-retardant ABS UL94-V0 is optional )	
<b>Operating Temperature Range</b>	<b>Discharge</b>	-20 ~ +50°C
	<b>Charge</b>	0 ~ +40°C
	<b>Storage</b>	-15 ~ +40°C
<b>Capacity Effected by Temperature</b>	<b>40°C / 104°F</b>	106%
	<b>25°C / 77°F</b>	100%
	<b>0°C / 32°F</b>	86%
	<b>-10°C / 14°F</b>	65%
<b>Charge Voltage</b>	<b>Float Voltage</b>	2.25 -2.30V/cell@25°C, Tem. Coefficient: -3mV/cell/°C
	<b>Equalize Voltage</b>	2.35 -2.40V/cell@25°C, Tem. Coefficient: -3mV/cell/°C
	<b>Cycle Voltage</b>	2.40 -2.50V/cell@25°C, Tem. Coefficient: -5mV/cell/°C
<b>Max Charging Current</b>	60A (0.3C)	
<b>Max. Discharge Current (5S)</b>	1600A	
<b>Internal Resistance</b>	1mΩ	
<b>Self Discharge</b>	<3%, TN series stored at 25 °C require a supplementary charge every six months, the charging interval would shrink when the ambient temperature	

### Discharge Performance

Constant Current Discharge Table (25°C/77°F) Unit: A

F.V/Time	15min	20min	30min	45min	1h	2h	3h	4h	5h	6h	8h	10h	20h
1.85V/cell	202.1	181.9	150.5	121.0	99.8	59.9	46.29	38.09	32.39	28.30	22.80	19.12	10.272
1.80V/cell	229.5	202.5	161.5	127.2	106.0	63.2	48.59	39.79	33.79	29.60	23.70	20.02	10.679
1.75V/cell	252.2	218.3	171.0	133.8	110.6	65.9	50.39	41.09	34.79	30.30	24.10	20.22	10.780
1.70V/cell	269.2	233.4	179.3	138.9	114.5	67.8	51.69	41.99	35.39	30.80	24.50	20.42	10.882
1.65V/cell	283.7	245.0	188.2	144.9	118.6	69.8	52.89	42.89	36.19	31.30	24.90	20.72	10.984
1.60V/cell	297.4	254.0	194.6	148.8	121.4	71.5	53.99	43.49	36.69	31.80	25.20	20.92	11.187

Constant Power Discharge Table (25°C/77°F) Unit: W

F.V/Time	15min	20min	30min	45min	1h	2h	3h	4h	5h	6h	8h	10h	20h
1.85V/cell	382.6	345.9	287.5	229.4	190.3	115.0	89.23	73.55	62.91	55.40	44.79	38.04	20.200
1.80V/cell	429.1	381.1	306.0	239.8	201.0	120.7	93.18	76.61	65.27	57.68	46.38	39.74	20.900
1.75V/cell	464.7	406.0	321.6	250.5	208.8	125.2	96.43	78.98	67.05	58.86	47.17	40.14	21.100
1.70V/cell	490.9	430.6	334.6	258.2	215.0	128.4	98.60	80.36	68.03	59.76	47.86	40.44	21.300
1.65V/cell	511.0	446.9	348.3	267.9	221.5	131.6	100.27	81.74	69.22	60.65	48.46	40.94	21.500
1.60V/cell	526.9	458.2	356.8	272.6	225.2	134.0	101.95	82.53	70.00	61.24	48.95	41.34	21.700

☐ 动力电池

■ 储能电池

☐ 备用电池

☐ 摩托车电池



### 储能电池-AGM-凝胶技术-TNG系列

# TNG2-200

## (2V 200Ah)

### 产品特点

- ◆ 阀控式免维护设计，寿命期间无需加水或加酸
- ◆ 专利稀土合金板栅，减少气体产生，自放电率低，抗腐蚀能力出众
- ◆ 特制组成配方，添加特殊试剂，增进深放电性能，延长循环寿命
- ◆ 高质量AGM隔板：防止微短路，延长循环寿命
- ◆ 纳米硅胶专利电解质，延长循环寿命，增进深放电性能
- ◆ ABS壳盖：电池外壳强度高（阻燃壳体UL94-V0可选）



### 产品应用

- ◆ 可再生能源系统
- ◆ 太阳能混合动力系统
- ◆ 不间断电源 (UPS)
- ◆ 通信及电力设备
- ◆ 应急照明系统
- ◆ 安防及火灾报警系统
- ◆ 机械自动化控制设备
- ◆ 应急电源 (EPS)
- ◆ 各式电动玩具及娱乐设施
- ◆ 照明设备

### 尺寸

单个尺寸

长	170±2mm
宽	106±2mm
高	330±3mm
总高	342±3mm

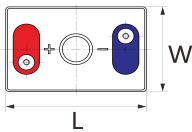
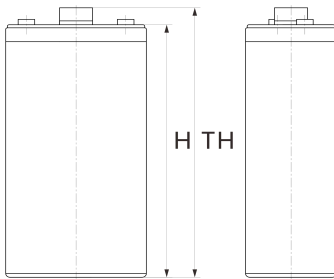

### 端子类型

单位:mm

端子类型 I7

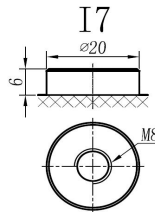

### 重量

12.8kg 28.3lbs



内容如有改动，恕不另行通知

动力电池

储能电池

备用电池

摩托车电池



## TNG2-200

### 规格书

额定电压	2V	
容量(25°C)	214Ah	20hr Rate(1.80V/cell)
	200Ah	10hr Rate(1.80V/cell)
	174Ah	5hr Rate(1.75V/cell)
	155Ah	3hr Rate(1.70V/cell)
	121Ah	1hr Rate(1.60V/cell)
壳体材料	ABS (阻燃ABS壳体可选)	
使用温度范围	放电	-20 ~ +50°C
	充电	0 ~ +40°C
	储存	-15 ~ +40°C
不同温度下电 池容量系数	40°C / 104°F	106%
	25°C / 77°F	100%
	0°C / 32°F	86%
	-10°C / 14°F	65%
充电电压	浮充	2.25 -2.30V/单格@25°C, 温度补偿系数: -3mV/单格/°C
	均充	2.35 -2.40V/单格@25°C, 温度补偿系数: -3mV/单格/°C
	循环使用	2.40 -2.50V/单格@25°C, 温度补偿系数: -5mV/单格/°C
最大充电电流	60A (0.3C)	
最大放电电流(5S)	1600A	
电阻	1mΩ	
自放电	<3%, TN系列储存在25°C时需每6个月进行一次补充充电, 环境温度更高时则充电间隔时间越短	

### 放电性能

恒电流放电表 (25°C/77°F) 单位: A													
F.V/Time	15min	20min	30min	45min	1h	2h	3h	4h	5h	6h	8h	10h	20h
1.85V/cell	202.1	181.9	150.5	121.0	99.8	59.9	46.29	38.09	32.39	28.30	22.80	19.12	10.272
1.80V/cell	229.5	202.5	161.5	127.2	106.0	63.2	48.59	39.79	33.79	29.60	23.70	20.02	10.679
1.75V/cell	252.2	218.3	171.0	133.8	110.6	65.9	50.39	41.09	34.79	30.30	24.10	20.22	10.780
1.70V/cell	269.2	233.4	179.3	138.9	114.5	67.8	51.69	41.99	35.39	30.80	24.50	20.42	10.882
1.65V/cell	283.7	245.0	188.2	144.9	118.6	69.8	52.89	42.89	36.19	31.30	24.90	20.72	10.984
1.60V/cell	297.4	254.0	194.6	148.8	121.4	71.5	53.99	43.49	36.69	31.80	25.20	20.92	11.187

恒功率放电表 (25°C/77°F) 单位: W													
F.V/Time	15min	20min	30min	45min	1h	2h	3h	4h	5h	6h	8h	10h	20h
1.85V/cell	382.6	345.9	287.5	229.4	190.3	115.0	89.23	73.55	62.91	55.40	44.79	38.04	20.200
1.80V/cell	429.1	381.1	306.0	239.8	201.0	120.7	93.18	76.61	65.27	57.68	46.38	39.74	20.900
1.75V/cell	464.7	406.0	321.6	250.5	208.8	125.2	96.43	78.98	67.05	58.86	47.17	40.14	21.100
1.70V/cell	490.9	430.6	334.6	258.2	215.0	128.4	98.60	80.36	68.03	59.76	47.86	40.44	21.300
1.65V/cell	511.0	446.9	348.3	267.9	221.5	131.6	100.27	81.74	69.22	60.65	48.46	40.94	21.500
1.60V/cell	526.9	458.2	356.8	272.6	225.2	134.0	101.95	82.53	70.00	61.24	48.95	41.34	21.700