

Motive Battery

Energy Storage Battery

Reserve Battery

Motorcycle Battery



Energy Storage Battery-AGM-GEL Technology-TNG Series

TNG2-500

(2V 500Ah)

GENERAL FEATURES

- ◆ Oxygen recombination technology: maintenance-free, no need to add water or acid
- ◆ The patent grid alloy: less gassing, low self-discharge, excellent corrosion resistance
- ◆ Special paste formula: additives for deep discharge, long cycle life
- ◆ High quality AGM separator: extend cycle life and prevent micro short circuit
- ◆ The patent Nano silica electrolytes, extend cycle life and improve the deep discharge performance
- ◆ ABS container: increase the strength of battery (Flame-retardant ABS UL94-V0 is optional)

Dimension

Unit:mm

Length	240±2mm / 9.45inch
Width	170±2mm / 6.77inch
Container Height	330±3mm / 12.99inch
Total Height	341.5±3mm / 13.78inch

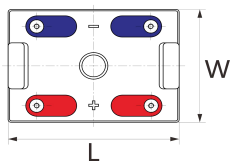
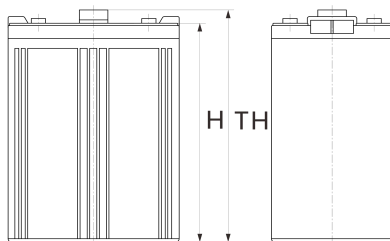

Application

- ◆ Renewable energy system
- ◆ Hybrid solar power system
- ◆ Uninterrupted Power Supply (UPS)
- ◆ Communications and electric equipment
- ◆ Emergency lighting equipment
- ◆ Fire alarm and security systems
- ◆ Robots, control equipment, and other automation equipment
- ◆ Emergency power supply (EPS)
- ◆ Various power toy and hobby equipment
- ◆ Lighting equipment

Terminal

Unit:mm

Terminal Type: I7

Weight

31.5kg 69.44lbs

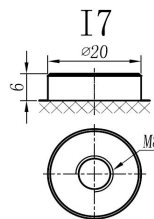

ISO9001 ISO14001 OHSAS18001

This document is subject to change without prior notification

Motive Battery Energy Storage Battery Reserve Battery Motorcycles Battery

TNG2-500

Specificaion

Nominal Voltage	2V	
Rated Capacity(25°C)	534Ah	20hr Rate(1.80V/cell)
	500Ah	10hr Rate(1.80V/cell)
	435Ah	5hr Rate(1.75V/cell)
	388Ah	3hr Rate(1.70V/cell)
	303Ah	1hr Rate(1.60V/cell)
Container Material	ABS (Flame-retardant ABS UL94-V0 is optional)	
Operating Temperature Range	Discharge	-20 ~ +50°C
	Charge	0 ~ +40°C
	Storage	-15 ~ +40°C
Capacity Effected by Temperature	40°C / 104°F	106%
	25°C / 77°F	100%
	0°C / 32°F	86%
	-10°C / 14°F	65%
Charge Voltage	Float Voltage	2.25 -2.30V/cell@25°C, Tem. Coefficient: -3mV/cell/°C
	Equalize Voltage	2.35 -2.40V/cell@25°C, Tem. Coefficient: -3mV/cell/°C
	Cycle Voltage	2.40 -2.50V/cell@25°C, Tem. Coefficient: -5mV/cell°C
Max Charging Current	150A (0.3C)	
Max. Discharge Current (5S)	4000A	
Internal Resistance	0.6mΩ	
Self Discharge	<3%, TN series stored at 25 °C require a supplementary charge every six months, the charging interval would shrink when the ambient temperature went higher	

Discharge Performance

Constant Current Discharge Table (25°C/77°F) Unit: A											
F.V/Time	30min	45min	1h	2h	3h	4h	5h	6h	8h	10h	20h
1.85V/cell	376.1	302.4	249.4	149.9	115.8	95.08	80.98	70.79	56.99	47.85	25.680
1.80V/cell	403.6	318.1	264.9	158.1	121.5	99.38	84.38	73.89	59.19	50.04	26.695
1.75V/cell	427.3	334.5	276.4	164.7	126.0	102.78	86.98	75.69	60.29	50.55	26.898
1.70V/cell	448.4	347.2	286.1	169.5	129.3	104.98	88.48	76.99	61.29	51.05	27.202
1.65V/cell	470.4	362.3	296.4	174.6	132.2	107.28	90.38	78.29	62.09	51.75	27.507
1.60V/cell	486.6	372.0	303.4	178.8	135.0	108.78	91.68	79.39	62.89	52.35	27.811

Constant Power Discharge Table (25°C/77°F) Unit: W											
F.V/Time	30min	45min	1h	2h	3h	4h	5h	6h	8h	10h	20h
1.85V/cell	718.8	573.4	475.8	287.4	223.2	183.98	157.36	138.54	112.08	95.10	50.400
1.80V/cell	765.1	599.3	502.6	301.8	233.0	191.48	163.18	144.19	116.04	99.40	52.200
1.75V/cell	804.0	626.5	522.1	313.1	241.0	197.39	167.72	147.16	118.03	100.30	52.600
1.70V/cell	836.5	645.5	537.6	320.9	246.5	200.85	170.08	149.44	119.71	101.20	53.100
1.65V/cell	870.9	669.8	553.7	329.1	250.7	204.49	173.14	151.62	121.10	102.30	53.700
1.60V/cell	891.9	681.5	562.9	334.8	254.8	206.37	174.91	153.21	122.39	103.30	54.300

动力电池

储能电池

备用电池

摩托车电池



储能电池-AGM-凝胶技术-TNG系列

TNG2-500

(2V 500Ah)

产品特点

- ◆ 阀控式免维护设计，寿命期间无需加水或加酸
- ◆ 专利稀土合金板栅，减少气体产生，自放电率低，抗腐蚀能力出众
- ◆ 特制组成配方，添加特殊试剂，增进深放电性能，延长循环寿命
- ◆ 高质量AGM隔板：防止微短路，延长循环寿命
- ◆ 纳米硅胶专利电解质，延长循环寿命，增进深放电性能
- ◆ ABS壳盖：电池外壳强度高（阻燃壳体UL94-V0可选）



产品应用

- ◆ 可再生能源系统
- ◆ 太阳能混合动力系统
- ◆ 不间断电源 (UPS)
- ◆ 通信及电力设备
- ◆ 应急照明系统
- ◆ 安防及火灾报警系统
- ◆ 机械自动化控制设备
- ◆ 应急电源 (EPS)
- ◆ 各式电动玩具及娱乐设施
- ◆ 照明设备

尺寸

单个尺寸

长	240±2mm / 9.45inch
宽	170±2mm / 6.77inch
高	330±3mm / 12.99inch
总高	341.5±3mm / 13.78inch

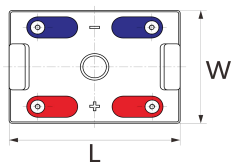
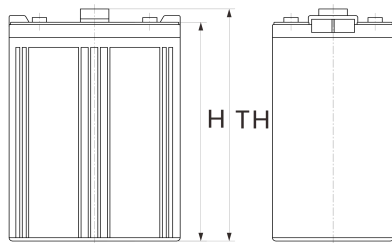

端子类型

单位:mm

端子类型 I7

重量

31.5kg 69.44lbs

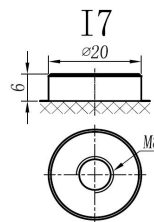

内容如有改动，恕不另行通知

动力电池

储能电池

备用电池

摩托车电池



TNG2-500

规格书

额定电压	2V	
容量 (25°C)	534Ah	20hr Rate(1.80V/cell)
	500Ah	10hr Rate(1.80V/cell)
	435Ah	5hr Rate(1.75V/cell)
	388Ah	3hr Rate(1.70V/cell)
	303Ah	1hr Rate(1.60V/cell)
壳体材料	ABS (阻燃ABS壳体可选)	
使用温度范围	放电	-20 ~ +50°C
	充电	0 ~ +40°C
	储存	-15 ~ +40°C
不同温度下电池容量系数	40°C / 104°F	106%
	25°C / 77°F	100%
	0°C / 32°F	86%
	-10°C / 14°F	65%
充电电压	浮充	2.25 -2.30V/单格@25°C, 温度补偿系数: -3mV/单格/°C
	均充	2.35 -2.40V/单格@25°C, 温度补偿系数: -3mV/单格/°C
	循环使用	2.40 -2.50V/单格@25°C, 温度补偿系数: -5mV/单格/°C
最大充电电流	150A (0.3C)	
最大放电电流 (5S)	4000A	
电阻	0.6mΩ	
自放电	<3%, TN系列储存在25°C时需每6个月进行一次补充充电, 环境温度更高时则充电间隔时间越短	

放电性能

恒电流放电表 (25°C/77°F) 单位: A											
F.V/Time	30min	45min	1h	2h	3h	4h	5h	6h	8h	10h	20h
1.85V/cell	376.1	302.4	249.4	149.9	115.8	95.08	80.98	70.79	56.99	47.85	25.680
1.80V/cell	403.6	318.1	264.9	158.1	121.5	99.38	84.38	73.89	59.19	50.04	26.695
1.75V/cell	427.3	334.5	276.4	164.7	126.0	102.78	86.98	75.69	60.29	50.55	26.898
1.70V/cell	448.4	347.2	286.1	169.5	129.3	104.98	88.48	76.99	61.29	51.05	27.202
1.65V/cell	470.4	362.3	296.4	174.6	132.2	107.28	90.38	78.29	62.09	51.75	27.507
1.60V/cell	486.6	372.0	303.4	178.8	135.0	108.78	91.68	79.39	62.89	52.35	27.811

恒功率放电表 (25°C/77°F) 单位: W											
F.V/Time	30min	45min	1h	2h	3h	4h	5h	6h	8h	10h	20h
1.85V/cell	718.8	573.4	475.8	287.4	223.2	183.98	157.36	138.54	112.08	95.10	50.400
1.80V/cell	765.1	599.3	502.6	301.8	233.0	191.48	163.18	144.19	116.04	99.40	52.200
1.75V/cell	804.0	626.5	522.1	313.1	241.0	197.39	167.72	147.16	118.03	100.30	52.600
1.70V/cell	836.5	645.5	537.6	320.9	246.5	200.85	170.08	149.44	119.71	101.20	53.100
1.65V/cell	870.9	669.8	553.7	329.1	250.7	204.49	173.14	151.62	121.10	102.30	53.700
1.60V/cell	891.9	681.5	562.9	334.8	254.8	206.37	174.91	153.21	122.39	103.30	54.300