

Motive Battery

Energy Storage Battery

Reserve Battery

Motorcycle Battery



Maintenance Free VRLA AGM Battery - Long Life Type

TNL12-70

(12V 70Ah)

GENERAL FEATURES

- ♦ Oxygen recombination technology: maintenance-free, no need to add water or acid
- ♦ The patent grid alloy: less gassing, low self-discharge, excellent corrosion resistance
- ♦ Long life, low self-discharge rate and high reliability, deep discharge recoverability
- ♦ High quality AGM separator: extend cycle life and prevent micro short circuit
- ♦ ABS container: increase the strength of battery (Flame-retardant ABS UL94-V0 is optional)

Dimension

Unit:mm

Length 350±2mm / 13.78inch

Width 167±2mm / 6.57inch

Container Height 180±3mm / 7.09inch

Total Height 180±3mm / 7.09inch

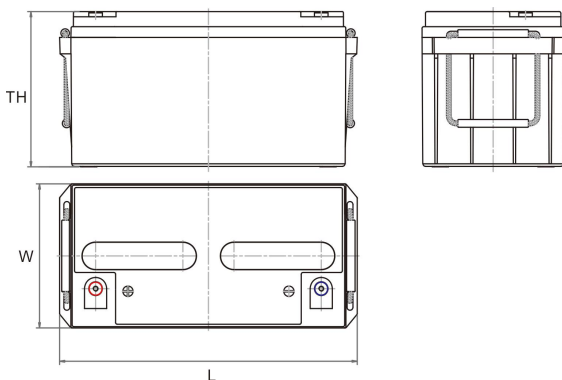

Application

- ♦ Uninterrupted Power Supply (UPS)
- ♦ Communications and electric equipment
- ♦ Emergency lighting equipment
- ♦ Fire alarm and security system
- ♦ Robots, control equipment, and other factory automation equipment
- ♦ Emergency power supply (EPS)
- ♦ Portable VTR/TV, radio and so on
- ♦ Power tools, lawn mowers, vacuum cleaners
- ♦ Cameras and photographic equipment
- ♦ Portable measuring equipment
- ♦ Portable telephone sets
- ♦ Various power toys and hobby equipment
- ♦ Lighting equipment

Terminal

Unit:mm

Terminal Type: I3

Weight

24kg

53.06lbs

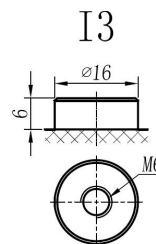

This document is subject to change without prior notification

Motive Battery

Energy Storage Battery

Reserve Battery

Motorcycle Battery



TNL12-70

Specificaion

Nominal Voltage	12V	
Rated Capacity(25°C)	74Ah	20hr Rate(1.80V/cell)
	70Ah	10hr Rate(1.80V/cell)
	62Ah	5hr Rate(1.75V/cell)
	58Ah	3hr Rate(1.70V/cell)
	44Ah	1hr Rate(1.60V/cell)
Container Material	ABS (Flame-retardant ABS UL94-V0 is optional)	
Operating Temperature Range	Discharge	-20 ~ +50°C
	Charge	0 ~ +40°C
	Storage	-15 ~ +40°C
Capacity Effected by Temperature	40°C / 104°F	106%
	25°C / 77°F	100%
	0°C / 32°F	86%
	-10°C / 14°F	65%
Charge	Float Voltage	2.23 -2.27V/cell@25°C, Tem.Coefficient : -3mV/cell/°C
	Equalize Voltage	2.35 -2.40V/cell@25°C, Tem.Coefficient : -3mV/cell/°C
	Cycle Voltage	2.40 -2.50V/cell@25°C, Tem.Coefficient : -5mV/cell°C
Max. Charging Current	21A (0.3C)	
Max. Discharge Current (5!)	840A	
Internal Resistance	6.6mΩ	
Self-Discharge	<3%, TN series stored at 25 °C require a supplementary charge every six months, the charging interval would shrink when the ambient temperature went higher	

Discharge Performance

Constant Current Discharge Table (25°C/77°F) Unit: A

F.V/Time	10min	15min	20min	30min	45min	1h	2h	3h	4h	5h	6h	8h	10h	20h
1.85V/cell	82.0	68.9	61.2	50.7	39.7	33.96	21.99	16.53	13.54	11.39	9.93	7.97	6.790	3.623
1.80V/cell	93.8	77.4	67.6	55.1	42.8	35.85	23.64	17.76	14.40	12.08	10.53	8.39	7.007	3.714
1.75V/cell	106.5	87.3	74.7	59.9	46.7	39.08	24.58	18.47	14.89	12.36	10.85	8.67	7.195	3.844
1.70V/cell	120.3	96.8	82.5	65.4	50.3	41.35	25.90	19.44	15.56	13.07	11.38	9.03	7.472	3.941
1.67V/cell	129.2	103.7	87.8	69.0	53.2	42.77	26.85	20.23	16.17	13.49	11.77	9.34	7.681	4.064
1.60V/cell	142.2	113.5	95.3	73.6	55.3	44.05	27.53	20.75	16.53	13.81	12.02	9.50	7.842	4.130

Constant Power Discharge Table (25°C/77°F) Unit: W

F.V/Time	10min	15min	20min	30min	45min	1h	2h	3h	4h	5h	6h	8h	10h	20h
1.85V/cell	153.1	130.0	116.5	97.7	76.0	65.28	42.55	32.11	26.38	22.26	19.55	15.75	13.573	7.249
1.80V/cell	173.1	144.1	127.0	104.5	81.4	68.54	45.44	34.30	27.90	23.48	20.64	16.53	13.985	7.490
1.75V/cell	193.5	160.4	139.0	112.6	87.9	74.37	47.08	35.54	28.76	23.95	21.21	17.04	14.344	7.670
1.70V/cell	213.6	175.5	152.3	122.3	94.4	78.45	49.49	37.34	29.99	25.29	22.20	17.74	14.885	7.861
1.67V/cell	227.4	186.5	160.8	128.0	99.0	80.57	51.02	38.67	31.06	26.00	22.90	18.30	15.278	8.096
1.60V/cell	244.5	200.9	172.8	135.7	102.3	82.54	52.06	39.49	31.65	26.54	23.31	18.58	15.572	8.214

动力电池

储能电池

备用电池

摩托车电池



阀控式免维护AGM电池-长寿命系列

TNL12-70

(12V 70Ah)

产品特点

- ◆ 阀控式免维护设计，寿命期间无需加水或加酸
- ◆ 专利稀土合金板栅，减少气体产生，自放电率低，抗腐蚀能力出众
- ◆ 电池寿命长，自放电率低具有高可靠性，深放电恢复能力出色
- ◆ 高质量AGM隔板：防止微短路，延长循环寿命
- ◆ ABS壳盖：电池外壳强度高（阻燃壳体UL94-V0可选）



产品应用

- ◆ 不间断电源(UPS)
- ◆ 通信和电力设备
- ◆ 紧急照明设备
- ◆ 火灾报警及安防系统
- ◆ 机器人、控制设备及其他机械自动化设备
- ◆ 应急电源系统
- ◆ 便携式音频设备
- ◆ 电动工具，割草机，真空吸尘器
- ◆ 照相设备
- ◆ 便携式测量工具
- ◆ 便携式通话设备
- ◆ 各式电动玩具及娱乐设施
- ◆ 照明设备

尺寸

单个尺寸

长	350±2mm
宽	167±2mm
高	180±3mm
总高	180±3mm

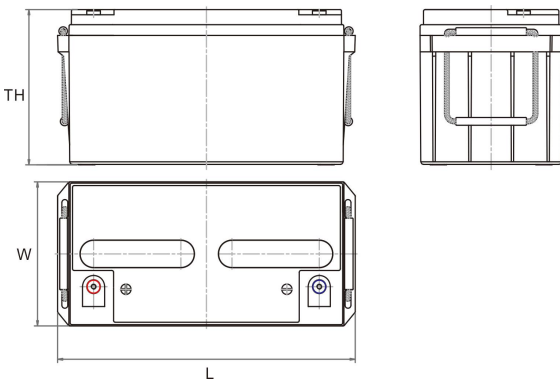

端子类型

单位:mm

端子类型 I3

重量

24kg 53.06lbs

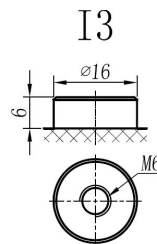

内容如有改动，恕不另行通知

动力电池

储能电池

备用电池

摩托车电池



TNL12-70

规格书

额定电压	12V	
容量(25°C)	74Ah	20hr Rate(1.80V/cell)
	70Ah	10hr Rate(1.80V/cell)
	62Ah	5hr Rate(1.75V/cell)
	58Ah	3hr Rate(1.70V/cell)
	44Ah	1hr Rate(1.60V/cell)
壳体材料	ABS (阻燃ABS壳体可选)	
使用温度范围	放电	-20 ~ +50°C
	充电	0 ~ +40°C
	储存	-15 ~ +40°C
不同温度下 电池容量系数	40°C / 104°F	106%
	25°C / 77°F	100%
	0°C / 32°F	86%
	-10°C / 14°F	65%
充电	浮充电压	2.23 -2.27V/单格@25°C, 温度补偿系数: -3mV/单格/°C
	均充电压	2.35 -2.40V/单格@25°C, 温度补偿系数: -3mV/单格/°C
	循环使用电压	2.40 -2.50V/单格@25°C, 温度补偿系数: -5mV/单格/°C
最大充电电流	21A (0.3C)	
最大放电电流 (5S)	840A	
电阻	6.6mΩ	
自放电	<3%, TN系列储存在25°C 时需每6个月进行一次补充充电, 环境温度更高时则充电间隔时间越短	

放电性能

恒电流放电表 (25°C/77°F) 单位: A														
F.V/Time	10min	15min	20min	30min	45min	1h	2h	3h	4h	5h	6h	8h	10h	20h
1.85V/cell	82.0	68.9	61.2	50.7	39.7	33.96	21.99	16.53	13.54	11.39	9.93	7.97	6.790	3.623
1.80V/cell	93.8	77.4	67.6	55.1	42.8	35.85	23.64	17.76	14.40	12.08	10.53	8.39	7.007	3.714
1.75V/cell	106.5	87.3	74.7	59.9	46.7	39.08	24.58	18.47	14.89	12.36	10.85	8.67	7.195	3.844
1.70V/cell	120.3	96.8	82.5	65.4	50.3	41.35	25.90	19.44	15.56	13.07	11.38	9.03	7.472	3.941
1.67V/cell	129.2	103.7	87.8	69.0	53.2	42.77	26.85	20.23	16.17	13.49	11.77	9.34	7.681	4.064
1.60V/cell	142.2	113.5	95.3	73.6	55.3	44.05	27.53	20.75	16.53	13.81	12.02	9.50	7.842	4.130

恒功率放电表 (25°C/77°F) 单位: W														
F.V/Time	10min	15min	20min	30min	45min	1h	2h	3h	4h	5h	6h	8h	10h	20h
1.85V/cell	153.1	130.0	116.5	97.7	76.0	65.28	42.55	32.11	26.38	22.26	19.55	15.75	13.573	7.249
1.80V/cell	173.1	144.1	127.0	104.5	81.4	68.54	45.44	34.30	27.90	23.48	20.64	16.53	13.985	7.490
1.75V/cell	193.5	160.4	139.0	112.6	87.9	74.37	47.08	35.54	28.76	23.95	21.21	17.04	14.344	7.670
1.70V/cell	213.6	175.5	152.3	122.3	94.4	78.45	49.49	37.34	29.99	25.29	22.20	17.74	14.885	7.861
1.67V/cell	227.4	186.5	160.8	128.0	99.0	80.57	51.02	38.67	31.06	26.00	22.90	18.30	15.278	8.096
1.60V/cell	244.5	200.9	172.8	135.7	102.3	82.54	52.06	39.49	31.65	26.54	23.31	18.58	15.572	8.214