

Motive Battery

Energy Storage Battery

Reserve Battery

Motorcycle Battery



## Maintenance Free VRLA AGM Battery - Long Life Type

# TNL12-75

(12V 75Ah)

### GENERAL FEATURES

- Oxygen recombination technology: maintenance-free, no need to add water or acid
- The patent grid alloy: less gassing, low self-discharge, excellent corrosion resistance
- Long life, low self-discharge rate and high reliability, deep discharge recoverability
- High quality AGM separator: extend cycle life and prevent micro short circuit
- ABS container: increase the strength of battery (Flame-retardant ABS UL94-V0 is optional)

### Dimension

Unit:mm

Length 260±2mm / 10.24inch

Width 168±2mm / 6.61inch

Container Height 211±3mm / 8.31inch

Total Height 213.5±3mm / 8.41inch

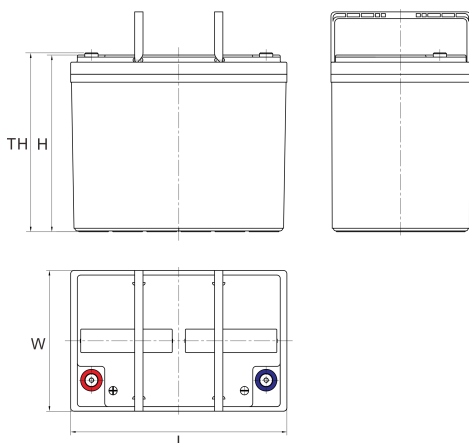

### Application

- Uninterrupted Power Supply ( UPS )
- Communications and electric equipment
- Emergency lighting equipment
- Fire alarm and security system
- Robots, control equipment, and other factory automation equipment
- Emergency power supply ( EPS )
- Portable VTR/TV, radio and so on
- Power tools, lawn mowers, vacuum cleaners
- Cameras and photographic equipment
- Portable measuring equipment
- Portable telephone sets
- Various power toys and hobby equipment
- Lighting equipment

### Terminal

Unit:mm

Terminal Type: I3

### Weight

22.8kg 50.41lbs

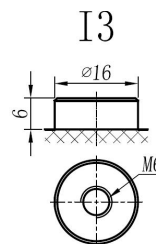

This document is subject to change without prior notification

Motive Battery

Energy Storage Battery

Reserve Battery

Motorcycle Battery



## TNL12-75

### Specificaion

<b>Nominal Voltage</b>	12V	
<b>Rated Capacity(25°C)</b>	80Ah	20hr Rate(1.80V/cell )
	75Ah	10hr Rate(1.80V/cell )
	66Ah	5hr Rate(1.75V/cell )
	62Ah	3hr Rate(1.70V/cell )
	47Ah	1hr Rate(1.60V/cell )
<b>Container Material</b>	ABS ( Flame-retardant ABS UL94-V0 is optional )	
<b>Operating Temperature Range</b>	<b>Discharge</b>	-20 ~ +50°C
	<b>Charge</b>	0 ~ +40°C
	<b>Storage</b>	-15 ~ +40°C
<b>Capacity Effected by Temperature</b>	<b>40°C / 104°F</b>	106%
	<b>25°C / 77°F</b>	100%
	<b>0°C / 32°F</b>	86%
	<b>-10°C / 14°F</b>	65%
<b>Charge</b>	<b>Float Voltage</b>	2.23 -2.27V/cell@25°C, Tem.Coefficient : -3mV/cell/°C
	<b>Equalize Voltage</b>	2.35 -2.40V/cell@25°C, Tem.Coefficient : -3mV/cell/°C
	<b>Cycle Voltage</b>	2.40 -2.50V/cell@25°C, Tem.Coefficient : -5mV/cell°C
<b>Max. Charging Current</b>	22.5A ( 0.3C )	
<b>Max. Discharge Current (5'</b>	900A	
<b>Internal Resistance</b>	6.6mΩ	
<b>Self-Discharge</b>	<3%, TN series stored at 25 °C require a supplementary charge every six months, the charging interval would shrink when the ambient temperature went higher	

### Discharge Performance

Constant Current Discharge Table (25°C/77°F) Unit: A

F.V/Time	10min	15min	20min	30min	45min	1h	2h	3h	4h	5h	6h	8h	10h	20h
1.85V/cell	87.9	73.9	65.6	54.4	42.5	36.44	23.55	17.76	14.51	12.18	10.61	8.54	7.277	3.884
1.80V/cell	100.5	83.0	72.5	59.1	45.9	38.37	25.38	19.08	15.43	12.99	11.31	8.99	7.508	4.014
1.75V/cell	114.1	93.5	80.1	64.2	50.0	41.92	26.39	19.79	15.94	13.30	11.62	9.29	11.011	4.114
1.70V/cell	128.9	103.7	88.4	70.1	53.9	44.46	27.71	20.81	16.65	14.01	12.22	9.68	8.008	4.224
1.67V/cell	138.4	111.1	94.0	73.9	57.0	45.88	28.72	21.72	17.36	14.41	12.63	10.01	8.228	4.354
1.60V/cell	152.4	121.6	102.2	78.9	59.3	47.20	29.54	22.23	17.76	14.82	12.93	10.20	8.398	4.424

Constant Power Discharge Table (25°C/77°F) Unit: W

F.V/Time	10min	15min	20min	30min	45min	1h	2h	3h	4h	5h	6h	8h	10h	20h
1.85V/cell	164.0	139.3	124.8	104.7	81.5	69.97	45.55	34.43	28.23	23.82	20.92	16.92	14.515	7.768
1.80V/cell	185.5	154.4	136.0	112.0	87.2	73.47	48.65	36.74	29.93	25.13	22.12	17.72	15.015	8.028
1.75V/cell	207.3	171.9	148.9	120.7	94.2	79.68	50.45	38.04	30.83	25.63	22.72	18.22	21.822	8.218
1.70V/cell	228.5	188.1	163.2	131.0	101.1	84.08	53.05	40.04	32.13	27.13	23.82	19.02	15.916	8.418
1.67V/cell	243.5	199.8	172.3	137.1	106.0	86.29	54.65	41.44	33.23	27.83	24.52	19.62	16.416	8.679
1.60V/cell	262.0	215.3	185.2	145.3	109.6	88.49	55.76	42.34	33.93	28.43	25.03	19.92	16.717	8.799

□ 动力电池

■ 储能电池

■ 备用电池

□ 摩托车电池



## 阀控式免维护AGM电池-长寿命系列

# TNL12-75

(12V 75Ah)

### 产品特点

- ◆ 阀控式免维护设计，寿命期间无需加水或加酸
- ◆ 专利稀土合金板栅，减少气体产生，自放电率低，抗腐蚀能力出众
- ◆ 电池寿命长，自放电率低具有高可靠性，深放电恢复能力出色
- ◆ 高质量AGM隔板：防止微短路，延长循环寿命
- ◆ ABS壳盖：电池外壳强度高（阻燃壳体UL94-V0可选）



### 尺寸

单个尺寸

长	260±2mm
宽	168±2mm
高	211±3mm
总高	213.5±3mm

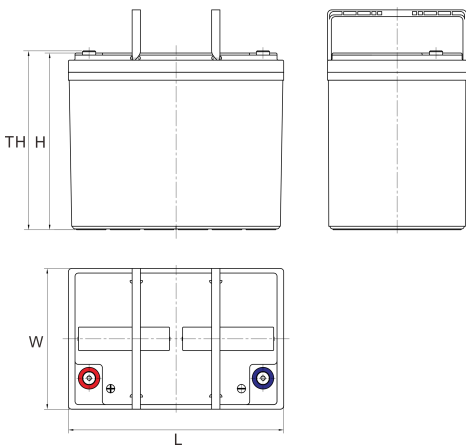

### 产品应用

- ◆ 不间断电源(UPS)
- ◆ 通信和电力设备
- ◆ 紧急照明设备
- ◆ 火灾报警及安防系统
- ◆ 机器人、控制设备及其他机械自动化设备
- ◆ 应急电源系统
- ◆ 便携式音频设备
- ◆ 电动工具，割草机，真空吸尘器
- ◆ 照相设备
- ◆ 便携式测量工具
- ◆ 便携式通话设备
- ◆ 各式电动玩具及娱乐设施
- ◆ 照明设备

### 端子类型

单位:mm

端子类型 I3

### 重量

22.8kg 50.41lbs

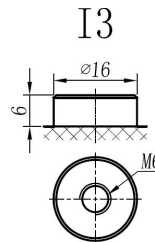

ISO9001 ISO14001 OHSAS18001

内容如有改动，恕不另行通知

动力电池

储能电池

备用电池

摩托车电池



## TNL12-75

### 规格书

额定电压	12V	
容量(25°C)	80Ah	20hr Rate(1.80V/cell)
	75Ah	10hr Rate(1.80V/cell)
	66Ah	5hr Rate(1.75V/cell)
	62Ah	3hr Rate(1.70V/cell)
	47Ah	1hr Rate(1.60V/cell)
壳体材料	ABS (阻燃ABS壳体可选)	
使用温度范围	放电	-20 ~ +50°C
	充电	0 ~ +40°C
	储存	-15 ~ +40°C
不同温度下 电池容量系数	40°C / 104°F	106%
	25°C / 77°F	100%
	0°C / 32°F	86%
	-10°C / 14°F	65%
充电	浮充电压	2.23 -2.27V/单格@25°C, 温度补偿系数: -3mV/单格/°C
	均充电压	2.35 -2.40V/单格@25°C, 温度补偿系数: -3mV/单格/°C
	循环使用电压	2.40 -2.50V/单格@25°C, 温度补偿系数: -5mV/单格/°C
最大充电电流	22.5A (0.3C)	
最大放电电流 (5S)	900A	
电阻	6.6mΩ	
自放电	<3%, TN系列储存在25°C 时需每6个月进行一次补充充电, 环境温度更高时则充电间隔时间越短	

### 放电性能

恒电流放电表 (25°C/77°F) 单位: A														
F.V/Time	10min	15min	20min	30min	45min	1h	2h	3h	4h	5h	6h	8h	10h	20h
1.85V/cell	87.9	73.9	65.6	54.4	42.5	36.44	23.55	17.76	14.51	12.18	10.61	8.54	7.277	3.884
1.80V/cell	100.5	83.0	72.5	59.1	45.9	38.37	25.38	19.08	15.43	12.99	11.31	8.99	7.508	4.014
1.75V/cell	114.1	93.5	80.1	64.2	50.0	41.92	26.39	19.79	15.94	13.30	11.62	9.29	11.011	4.114
1.70V/cell	128.9	103.7	88.4	70.1	53.9	44.46	27.71	20.81	16.65	14.01	12.22	9.68	8.008	4.224
1.67V/cell	138.4	111.1	94.0	73.9	57.0	45.88	28.72	21.72	17.36	14.41	12.63	10.01	8.228	4.354
1.60V/cell	152.4	121.6	102.2	78.9	59.3	47.20	29.54	22.23	17.76	14.82	12.93	10.20	8.398	4.424

恒功率放电表 (25°C/77°F) 单位: W														
F.V/Time	10min	15min	20min	30min	45min	1h	2h	3h	4h	5h	6h	8h	10h	20h
1.85V/cell	164.0	139.3	124.8	104.7	81.5	69.97	45.55	34.43	28.23	23.82	20.92	16.92	14.515	7.768
1.80V/cell	185.5	154.4	136.0	112.0	87.2	73.47	48.65	36.74	29.93	25.13	22.12	17.72	15.015	8.028
1.75V/cell	207.3	171.9	148.9	120.7	94.2	79.68	50.45	38.04	30.83	25.63	22.72	18.22	21.822	8.218
1.70V/cell	228.5	188.1	163.2	131.0	101.1	84.08	53.05	40.04	32.13	27.13	23.82	19.02	15.916	8.418
1.67V/cell	243.5	199.8	172.3	137.1	106.0	86.29	54.65	41.44	33.23	27.83	24.52	19.62	16.416	8.679
1.60V/cell	262.0	215.3	185.2	145.3	109.6	88.49	55.76	42.34	33.93	28.43	25.03	19.92	16.717	8.799