

Motive Battery

Energy Storage Battery

Reserve Battery

Motorcycle Battery



Maintenance Free VRLA AGM Battery - Long Life Type

TNL2-800

(2V 800Ah)

GENERAL FEATURES

- ◆ Cycle or standby (or float) application
- ◆ Design life is 12~16 years at 25°C under standby application, deep discharge recoverability
- ◆ It has safety, low resistance so recharge is easy and energy output is more remarkable
- ◆ Deep discharge recoverability
- ◆ Strictly manufacture process control and high consistency
- ◆ ISO9001, ISO14001 certified
- ◆ UL, IEC60896-21&22, TLC, CE and European council Directive 2006/66/EC and its amendment (2008/12/EC) certification

Dimension

Unit:mm

Length 382±2mm / 15.04inch

Width 170±2mm / 6.69inch

Container Height 330±3mm / 12.99inch

Total Height 341.5±3mm / 13.44inch

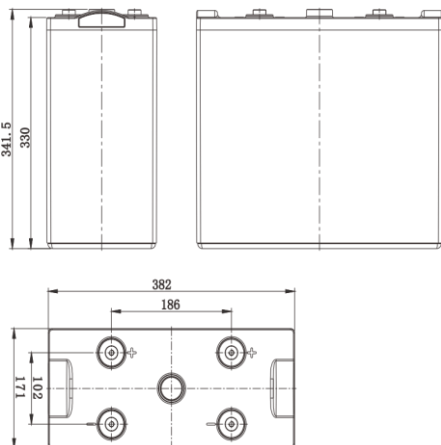

Application

- ◆ Uninterrupted Power Supply (UPS)
- ◆ Communications and electric equipment
- ◆ Emergency lighting equipment
- ◆ Fire alarm and security system
- ◆ Robots, control equipment, and other factory automation equipment
- ◆ Emergency power supply (EPS)
- ◆ Portable VTR/TV, radio and so on
- ◆ Power tools, lawn mowers, vacuum cleaners
- ◆ Cameras and photographic equipment
- ◆ Portable measuring equipment
- ◆ Portable telephone sets
- ◆ Various power toys and hobby equipment
- ◆ Lighting equipment

Terminal

Unit:mm

Terminal Type: I7

Weight

48.5kg 106.92lbs

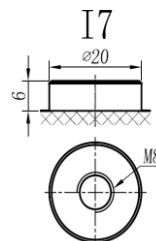

ISO9001 ISO14001 OHSAS18001

This document is subject to change without prior notification

Motive Battery Energy Storage Battery

Reserve Battery Motorcycle Battery



TNL2-800

Specificaion

Nominal Voltage	2V	
Rated Capacity(25°C)	855Ah	20hr Rate(1.80V/cell)
	801Ah	10hr Rate(1.80V/cell)
	721Ah	5hr Rate(1.75V/cell)
	646Ah	3hr Rate(1.70V/cell)
	488Ah	1hr Rate(1.60V/cell)
Container Material	ABS (Flame-retardant ABS UL94-V0 is optional)	
Operating Temperature Range	Discharge	-20 ~ +50°C
	Charge	0 ~ +40°C
	Storage	-15 ~ +40°C
Capacity Effected by Temperature	40°C / 104°F	106%
	25°C / 77°F	100%
	0°C / 32°F	86%
	-10°C / 14°F	65%
Charge	Float Voltage	2.23 -2.27V/cell@25°C, Tem.Coefficient : -3mV/cell/°C
	Equalize Voltage	2.35 -2.40V/cell@25°C, Tem.Coefficient : -3mV/cell/°C
	Cycle Voltage	2.40 -2.50V/cell@25°C, Tem.Coefficient : -5mV/cell°C
Max. Charging Current	240A (0.3C)	
Max. Discharge Current (5S)	6400A	
Internal Resistance	0.5mΩ	
Self-Discharge	<3%, TN series stored at 25 °C require a supplementary charge every six months, the charging interval would shrink when the ambient temperature went higher	

Discharge Performance

Constant Current Discharge Table (25°C/77°F) Unit: A

F.V/Time	30min	45min	1h	2h	3h	4h	5h	6h	8h	10h	20h
1.85V/cell	600.9	488.5	407.32	252.53	192.75	157.53	134.18	116.66	93.32	77.077	41.241
1.80V/cell	644.7	513.9	425.89	263.90	202.19	164.63	139.77	121.81	97.36	80.080	42.743
1.75V/cell	682.8	540.4	444.37	274.46	208.99	170.22	144.13	124.74	99.28	81.081	42.943
1.70V/cell	716.4	560.8	460.00	285.42	215.48	173.97	146.57	126.96	101.00	82.082	43.443
1.67V/cell	751.5	585.1	476.54	294.76	220.36	177.63	149.71	129.08	102.52	83.083	43.844
1.60V/cell	777.2	600.9	487.71	300.44	224.11	180.16	151.95	130.90	104.03	84.284	44.144

Constant Power Discharge Table (25°C/77°F) Unit: W

F.V/Time	30min	45min	1h	2h	3h	4h	5h	6h	8h	10h	20h
1.85V/cell	1148.3	926.3	776.98	484.38	371.47	304.80	260.66	228.43	183.58	153.353	82.182
1.80V/cell	1222.2	968.1	807.91	503.80	387.89	317.32	270.47	237.64	190.89	159.059	84.885
1.75V/cell	1284.5	1012.0	839.24	521.92	399.80	327.03	277.78	242.54	194.19	160.861	85.185
1.70V/cell	1336.4	1042.7	864.06	540.44	410.61	332.73	281.78	246.45	197.40	162.663	86.086
1.67V/cell	1391.4	1082.1	890.09	555.76	418.12	338.74	286.79	249.95	199.90	164.364	86.887
1.60V/cell	1424.6	1100.8	904.80	562.96	423.12	341.94	289.79	252.55	202.40	166.466	87.387