

Motive Battery

Energy Storage Battery

Reserve Battery

Motorcycle Battery



## Maintenance Free VRLA AGM Battery - Long Life Type

# TNL2-600

(2V 600Ah)

### GENERAL FEATURES

- ◆ Cycle or standby (or float) application
- ◆ Design life is 12~16 years at 25°C under standby application, deep discharge recoverability
- ◆ It has safety, low resistance so recharge is easy and energy output is more remarkable
- ◆ Deep discharge recoverability
- ◆ Strictly manufacture process control and high consistency
- ◆ ISO9001, ISO14001 certified
- ◆ UL, IEC60896-21&22, TLC, CE and European council Directive 2006/66/EC and its amendment (2008/12/EC) certification



### Application

- ◆ Uninterrupted Power Supply ( UPS )
- ◆ Communications and electric equipment
- ◆ Emergency lighting equipment
- ◆ Fire alarm and security system
- ◆ Robots, control equipment, and other factory automation equipment
- ◆ Emergency power supply ( EPS )
- ◆ Portable VTR/TV, radio and so on
- ◆ Power tools, lawn mowers, vacuum cleaners
- ◆ Cameras and photographic equipment
- ◆ Portable measuring equipment
- ◆ Portable telephone sets
- ◆ Various power toys and hobby equipment
- ◆ Lighting equipment

### Dimension

Unit:mm

Length	285±2mm	/	11.22inch
Width	170±2mm	/	6.69inch
Container Height	330±3mm	/	12.99inch
Total Height	341.5±3mm	/	13.44inch

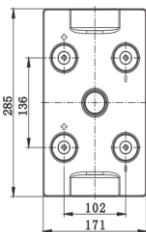
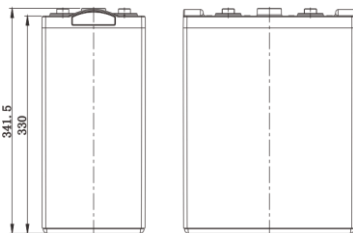

### Terminal

Unit:mm

Terminal Type: I7

### Weight

36kg

79.37lbs

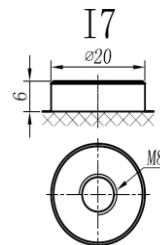

ISO9001 ISO14001 OHSAS18001

This document is subject to change without prior notification

- Motive Battery
- Energy Storage Battery
- Reserve Battery
- Motorcycle Battery



## TNL2-600

### Specifaicon

<b>Nominal Voltage</b>	2V	
<b>Rated Capacity(25°C)</b>	641Ah	20hr Rate(1.80V/cell )
	601Ah	10hr Rate(1.80V/cell )
	540Ah	5hr Rate(1.75V/cell )
	485Ah	3hr Rate(1.70V/cell )
	366Ah	1hr Rate(1.60V/cell )
<b>Container Material</b>	ABS ( Flame-retardant ABS UL94-V0 is optional )	
<b>Operating Temperature Range</b>	<b>Discharge</b>	-20 ~ +50°C
	<b>Charge</b>	0 ~ +40°C
	<b>Storage</b>	-15 ~ +40°C
<b>Capacity Effected by Temperature</b>	<b>40°C / 104°F</b>	106%
	<b>25°C / 77°F</b>	100%
	<b>0°C / 32°F</b>	86%
	<b>-10°C / 14°F</b>	65%
<b>Charge</b>	<b>Float Voltage</b>	2.23 -2.27V/cell@25°C, Tem.Coefficient : -3mV/cell/°C
	<b>Equalize Voltage</b>	2.35 -2.40V/cell@25°C, Tem.Coefficient : -3mV/cell/°C
	<b>Cycle Voltage</b>	2.40 -2.50V/cell@25°C, Tem.Coefficient : -5mV/cell°C
<b>Max. Charging Current</b>	180A ( 0.3C )	
<b>Max. Discharge Current (5S)</b>	4800A	
<b>Internal Resistance</b>	0.55mΩ	
<b>Self-Discharge</b>	<3%, TN series stored at 25 °C require a supplementary charge every six months, the charging interval would shrink when the ambient temperature went higher	

### Discharge Performance

Constant Current Discharge Table (25°C/77°F) Unit: A

F.V/Time	30min	45min	1h	2h	3h	4h	5h	6h	8h	10h	20h
1.85V/cell	450.7	366.4	305.52	189.40	144.54	118.15	100.59	87.47	69.99	57.858	30.931
1.80V/cell	483.6	385.5	319.42	197.93	151.64	123.42	104.85	91.41	73.02	60.060	32.032
1.75V/cell	512.1	405.3	333.33	205.84	156.72	127.69	108.10	93.53	74.44	60.861	32.232
1.70V/cell	537.2	420.6	345.00	214.06	161.59	130.43	109.92	95.14	75.75	61.562	32.533
1.67V/cell	563.6	438.9	357.38	221.07	165.24	133.27	112.26	96.86	76.86	62.262	32.933
1.60V/cell	582.9	450.7	365.81	225.33	168.08	135.10	113.88	98.17	78.07	63.163	33.133

Constant Power Discharge Table (25°C/77°F) Unit: W

F.V/Time	30min	45min	1h	2h	3h	4h	5h	6h	8h	10h	20h
1.85V/cell	861.3	694.7	582.68	363.36	278.58	228.63	195.50	171.27	137.64	115.015	61.562
1.80V/cell	916.7	726.0	605.91	377.88	290.89	238.04	202.80	178.28	143.14	119.319	63.664
1.75V/cell	963.4	759.0	629.43	391.39	299.80	245.25	208.31	181.88	145.65	120.721	63.964
1.70V/cell	1002.3	782.1	648.05	405.30	308.01	249.55	211.31	184.78	148.05	122.022	64.565
1.67V/cell	1043.5	811.6	667.57	416.82	313.61	254.05	215.11	187.49	149.85	123.223	65.165
1.60V/cell	1068.5	825.6	678.58	422.22	317.32	256.46	217.32	189.49	151.75	124.825	65.566