

Motive Battery

Energy Storage Battery

Reserve Battery

Motorcycle Battery



Maintenance Free-High Rate UPS Battery-TNX Series

TNX12-125W

(12V 126W, 15min@1.67Vpc)

(12V 45Ah, C10 @1.80Vpc)

GENERAL FEATURES

- Oxygen recombination technology: maintenance-free, no need to add water or acid during application
- Optimized plate design to increase power output at 15min backup time, high performance in high-rate discharge
- Wide operating temperature range from -20°C to 55°C, excellent deep discharge recovery capability
- New structure for plate grid, good corrosion resistance and greatly reduced resistance of the battery,
- 12 years design life @25°C, low self-discharge rate



Application

- UPS (High Rate)
- Communication Equipments
- Security systems
- Data & Network centers
- Emergency power supply (EPS)
- Bank and financial system
- Hospitals & Testing laboratories

Dimension

Unit:mm

Length 198.5±2mm / 7.81inch

Width 166±2mm / 6.54inch

Container Height 169.5±3mm / 6.67inch

Total Height 169.5±3mm / 6.67inch

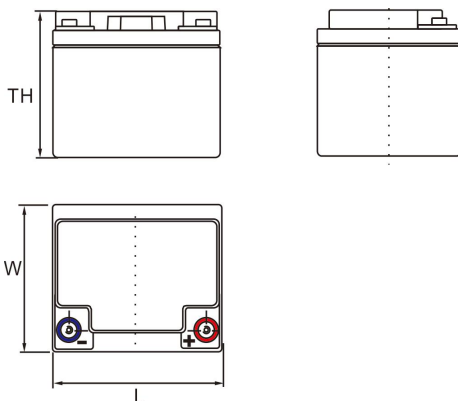

Terminal

Unit:mm

Terminal Type: I3

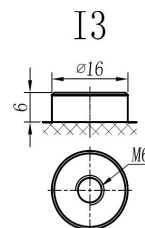

Weight

13.5kg 29.76lbs



ISO9001 ISO14001 OHSAS18001

This document is subject to change without prior notification

- Motive Battery Energy Storage Battery
 Reserve Battery Motorcycle Battery



TNX12-125W

Specification

Nominal Voltage	12V	
Rated Power (15min Rate 25°C)	126W F.V (1.67V/cell)	
Rated Capacity (10HR 25°C)	40Ah (1.80V/cell)	
Dimension	Length	198.5±2mm / 7.81inch
	Width	166±2mm / 6.54inch
	Container Height	169.5±3mm / 6.67inch
	Total Height	169.5±3mm / 6.67inch
Weight	13.5kg / 29.76lbs	
Terminal	I3	
Container Material	ABS (Flame-retardant ABS UL94-V0 is optional)	
Operating Temperature Range	Discharge	-20 ~ +50°C
	Charge	0 ~ +40°C
	Storage	-15 ~ +40°C
Capacity Effected by Temperature	40°C / 104°F	106%
	25°C / 77°F	100%
	0°C / 32°F	86%
	-10°C / 14°F	65%
Charge	Float Voltage	2.25 -2.27V/cell@25°C, Tem.Coefficient : -3mV/cell/°C
	Equalize Voltage	2.40 -2.50V/cell@25°C, Tem.Coefficient : -3mV/cell/°C
	Cycle Voltage	2.40 -2.50V/cell@25°C, Tem.Coefficient : -5mV/cell/°C
Max. Charging Current	13.5A (0.3C)	
Max. Discharge Current (5S)	456A	
Internal Resistance	10mΩ	
Self-Discharge	<3%, TNX series stored at 25 °C require a supplementary charge every six months, the charging interval would shrink when the ambient temperature went higher	

Discharge Performance

Constant Current Discharge Table (25°C/77°F) Unit: A															
F.V/Time	5min	10min	15min	20min	30min	45min	1h	2h	3h	4h	5h	6h	8h	10h	20h
1.85V/cell	68.6	55.0	50.8	41.5	32.8	24.8	21.01	12.58	9.72	7.71	6.31	5.47	4.58	3.869	2.122
1.80V/cell	89.3	68.2	59.5	47.5	37.5	27.9	22.78	13.31	10.19	8.07	6.65	5.75	4.76	4.025	2.142
1.75V/cell	100.8	75.0	65.1	51.2	38.9	28.9	23.82	13.83	10.39	8.24	6.82	5.90	4.85	4.066	2.163
1.70V/cell	111.0	81.7	69.4	53.8	40.6	30.1	24.65	14.46	10.61	8.47	7.00	6.02	4.91	4.098	2.205
1.67V/cell	122.4	88.2	73.8	57.1	42.7	30.9	25.38	14.77	11.13	8.76	7.20	6.17	4.98	4.191	2.226
1.60V/cell	135.0	95.8	79.0	60.8	45.2	32.1	26.31	15.18	11.44	9.03	7.43	6.29	5.03	4.233	2.236

Constant Power Discharge Table (25°C/77°F) Unit: W															
F.V/Time	5min	10min	15min	20min	30min	45min	1h	2h	3h	4h	5h	6h	8h	10h	20h
1.85V/cell	121.8	98.7	92.0	75.9	60.6	46.1	39.19	23.74	18.48	14.75	12.22	10.61	8.70	7.434	4.091
1.80V/cell	157.1	120.9	106.4	85.9	68.5	51.6	42.42	24.95	19.19	15.35	12.83	11.21	9.02	7.706	4.131
1.75V/cell	173.3	130.7	114.8	91.4	70.4	53.1	44.14	25.76	19.49	15.66	13.13	11.41	9.16	7.777	4.161
1.70V/cell	185.5	139.2	120.9	95.3	73.0	54.9	45.45	26.77	20.00	16.06	13.43	11.62	9.28	7.848	4.242
1.67V/cell	201.7	148.9	126.3	100.5	76.4	55.9	46.66	27.37	20.81	16.56	13.74	11.82	9.39	7.999	4.282
1.60V/cell	217.3	158.1	134.1	105.9	80.0	57.9	47.98	28.08	21.31	17.07	14.14	12.02	9.47	8.070	4.303

动力电池

储能电池

备用电池

摩托车电池



阀控免维护-高功率UPS电池-TNX系列

TNX12-125W

(12V 126W, 15min@1.67Vpc)

(12V 45Ah, C10 @1.80Vpc)

产品特点：

- 氧复合技术: 阀控式免维护, 使用期间无需加水或加酸
- 极板优化处理, 提升15分钟放电性能, 高倍率放电性能优异
- 在-20°C到55°C温度区间内均可正常使用, 深放电恢复能力出色
- 隔板特色设计, 抗腐蚀性能佳, 同时大幅度降低电池内阻
- 12年设计寿命(25°C), 自放电率低



产品应用

- 不间断电源(高功率)
- 通讯设备
- 安全系统
- 数据网络中心
- 应急电源系统
- 银行资金系统
- 医疗测试设备

尺寸

单个尺寸

长	198.5±2mm / 7.81inch
宽	166±2mm / 6.54inch
高	169.5±3mm / 6.67inch
总高	169.5±3mm / 6.67inch

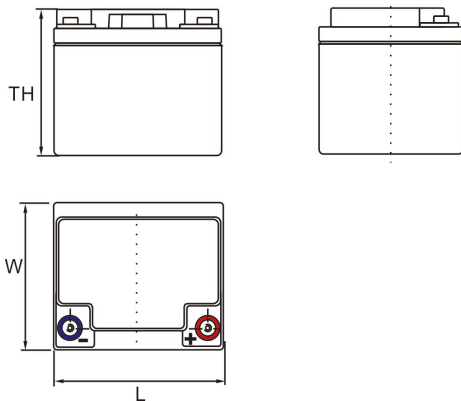

端子类型

单位:mm

端子类型 I3

重量

13.5kg 29.76lbs

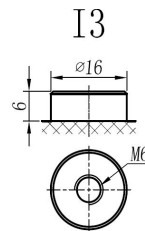

内容如有改动, 恕不另行通知

□ 动力电池

□ 储能电池

■ 备用电池

□ 摩托车电池



TNX12-125W

规格书

额定电压	12V	
15分钟放电功率	126W F.V (1.67V/cell)	
额定容量 (10小时)	40Ah (1.80V/cell)	
尺寸	长	198.5±2mm
	宽	166±2mm
	高	169.5±3mm
	总高	169.5±3mm
重量	13.5kg	
端子	I3	
壳体材料	ABS (阻燃ABS壳体可选)	
使用温度范围	放电	-20 ~ +50°C
	充电	0 ~ +40°C
	储存	-15 ~ +40°C
不同温度下 电池容量系数	40°C / 104°F	106%
	25°C / 77°F	100%
	0°C / 32°F	86%
	-10°C / 14°F	65%
充电	浮充电压	2.25 -2.27V/单格@25°C, 温度补偿系数: -3mV/单格/°C
	均充电压	2.40 -2.50V/单格@25°C, 温度补偿系数: -3mV/单格/°C
	循环使用电压	2.40 -2.50V/单格@25°C, 温度补偿系数: -5mV/单格/°C
最大充电电流	13.5A (0.3C)	
最大放电电流 (5S)	456A	
电阻	10mΩ	
自放电	<3%, TNX系列储存在25°C时需每6个月进行一次补充充电, 环境温度更高时则充电间隔时间越短	

放电性能

恒电流放电表 (25°C/77°F) 单位: A															
F.V/Time	5min	10min	15min	20min	30min	45min	1h	2h	3h	4h	5h	6h	8h	10h	20h
1.85V/cell	68.6	55.0	50.8	41.5	32.8	24.8	21.01	12.58	9.72	7.71	6.31	5.47	4.58	3.869	2.122
1.80V/cell	89.3	68.2	59.5	47.5	37.5	27.9	22.78	13.31	10.19	8.07	6.65	5.75	4.76	4.025	2.142
1.75V/cell	100.8	75.0	65.1	51.2	38.9	28.9	23.82	13.83	10.39	8.24	6.82	5.90	4.85	4.066	2.163
1.70V/cell	111.0	81.7	69.4	53.8	40.6	30.1	24.65	14.46	10.61	8.47	7.00	6.02	4.91	4.098	2.205
1.67V/cell	122.4	88.2	73.8	57.1	42.7	30.9	25.38	14.77	11.13	8.76	7.20	6.17	4.98	4.191	2.226
1.60V/cell	135.0	95.8	79.0	60.8	45.2	32.1	26.31	15.18	11.44	9.03	7.43	6.29	5.03	4.233	2.236

恒功率放电表 (25°C/77°F) 单位: W															
F.V/Time	5min	10min	15min	20min	30min	45min	1h	2h	3h	4h	5h	6h	8h	10h	20h
1.85V/cell	121.8	98.7	92.0	75.9	60.6	46.1	39.19	23.74	18.48	14.75	12.22	10.61	8.70	7.434	4.091
1.80V/cell	157.1	120.9	106.4	85.9	68.5	51.6	42.42	24.95	19.19	15.35	12.83	11.21	9.02	7.706	4.131
1.75V/cell	173.3	130.7	114.8	91.4	70.4	53.1	44.14	25.76	19.49	15.66	13.13	11.41	9.16	7.777	4.161
1.70V/cell	185.5	139.2	120.9	95.3	73.0	54.9	45.45	26.77	20.00	16.06	13.43	11.62	9.28	7.848	4.242
1.67V/cell	201.7	148.9	126.3	100.5	76.4	55.9	46.66	27.37	20.81	16.56	13.74	11.82	9.39	7.999	4.282
1.60V/cell	217.3	158.1	134.1	105.9	80.0	57.9	47.98	28.08	21.31	17.07	14.14	12.02	9.47	8.070	4.303