

Motive Battery

Energy Storage Battery

Reserve Battery

Motorcycle Battery



Maintenance Free-High Rate UPS Battery-TNX Series

TNX12-790W

(12V 790W, 15min@1.67Vpc)

(12V 250Ah, C10 @1.80Vpc)

GENERAL FEATURES

- ♦ Oxygen recombination technology: maintenance-free, no need to add water or acid during application
- ♦ Optimized plate design to increase power output at 15min backup time, high performance in high-rate discharge
- ♦ Wide operating temperature range from -20°C to 55°C, excellent deep discharge recovery capability
- ♦ New structure for plate grid, good corrosion resistance and greatly reduced resistance of the battery,
- ♦ 12 years design life @25°C, low self-discharge rate



Application

- ♦ UPS (High Rate)
- ♦ Communication Equipments
- ♦ Security systems
- ♦ Data & Network centers
- ♦ Emergency power supply (EPS)
- ♦ Bank and financial system
- ♦ Hospitals & Testing laboratories

Dimension

Unit:mm

Length 522±2mm / 20.55inch

Width 268±2mm / 10.55inch

Container Height 220±3mm / 8.66inch

Total Height 226±3mm / 8.9inch

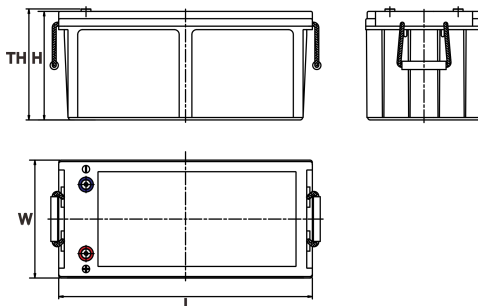

Terminal

Unit:mm

Terminal Type: I7

Weight

72.5kg 159.83lbs

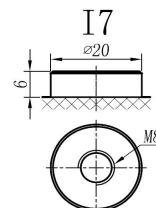

This document is subject to change without prior notification

Motive Battery Energy Storage Battery Reserve Battery Motorcycle Battery

TNX12-790W

Specificaion

Nominal Voltage	12V	
Rated Power (15min Rate 25°C)	790W F.V (1.67V/cell)	
Rated Capacity (10HR 25°C)	250Ah (1.80V/cell)	
Dimension	Length	522±2mm / 20.5inch
	Width	268±2mm / 10.5inch
	Container Height	220±3mm / 8.66inch
	Total Height	226±3mm / 8.9inch
Weight	72.5kg / 159.83lbs	
Terminal	I7	
Container Material	ABS (Flame-retardant ABS UL94-V0 is optional)	
Operating Temperature Range	Discharge	-20 ~ +50°C
	Charge	0 ~ +40°C
	Storage	-15 ~ +40°C
Capacity Effected by Temperature	40°C / 104°F	106%
	25°C / 77°F	100%
	0°C / 32°F	86%
	-10°C / 14°F	65%
Charge	Float Voltage	2.25 -2.27V/cell@25°C, Tem.Coefficient : -3mV/cell/°C
	Equalize Voltage	2.40 -2.50V/cell@25°C, Tem.Coefficient : -3mV/cell/°C
	Cycle Voltage	2.40 -2.50V/cell@25°C, Tem.Coefficient : -5mV/cell°C
Max. Charging Current	75A (0.3C)	
Max. Discharge Current (5S)	2500A	
Internal Resistance	2.5mΩ	
Self-Discharge	<3%, TNX series stored at 25 °C require a supplementary charge every six months, the charging interval would shrink when the ambient temperature went higher	

Discharge Performance

Constant Current Discharge Table (25°C/77°F) Unit: A														
F.V/Time	10min	15min	20min	30min	45min	1h	2h	3h	4h	5h	6h	8h	10h	20h
1.85V/cell	388.1	338.3	285.7	220.7	166.9	134.55	81.93	59.68	47.43	39.59	35.18	29.50	24.444	12.610
1.80V/cell	437.9	377.7	314.7	235.6	179.3	145.14	87.32	63.41	49.98	41.94	37.14	30.87	25.026	13.095
1.75V/cell	474.7	396.6	328.2	244.5	185.2	150.72	89.47	64.78	51.55	43.02	37.83	31.16	25.511	13.192
1.70V/cell	502.0	423.3	345.2	251.0	190.8	155.13	91.14	66.35	52.63	43.81	38.51	31.36	25.899	13.289
1.67V/cell	/	446.4	357.9	260.4	195.4	159.05	92.90	67.13	53.51	44.59	39.10	31.75	26.093	13.386
1.60V/cell	/	465.5	368.3	265.3	198.7	162.48	94.57	68.50	54.59	45.18	39.49	32.05	26.287	13.483

Constant Power Discharge Table (25°C/77°F) Unit: W														
F.V/Time	10min	15min	20min	30min	45min	1h	2h	3h	4h	5h	6h	8h	10h	20h
1.85V/cell	716.9	631.2	538.6	420.7	322.6	265.32	164.54	120.48	96.03	80.59	71.68	60.19	50.490	26.096
1.80V/cell	799.2	695.3	584.5	442.1	343.7	284.92	174.93	127.61	100.88	84.84	75.34	62.77	51.530	26.888
1.75V/cell	852.7	721.0	603.5	455.1	353.8	295.22	178.79	129.89	103.55	86.63	76.63	63.26	52.183	26.987
1.70V/cell	881.2	759.0	630.2	464.5	364.0	302.94	181.47	132.66	105.44	88.01	77.72	63.46	52.787	27.185
1.67V/cell	/	790.2	648.5	478.1	369.7	309.38	184.44	134.05	107.12	89.30	78.71	64.05	53.183	27.393
1.60V/cell	/	814.6	660.0	483.8	371.5	313.53	186.91	136.22	108.90	90.19	79.40	64.45	53.480	27.492

动力电池

储能电池

备用电池

摩托车电池



阀控免维护-高功率UPS电池-TNX系列

TNX12-790W

(12V 790W, 15min@1.67Vpc)

(12V 250Ah, C10 @1.80Vpc)

产品特点：

- ◆ 氧复合技术: 阀控式免维护, 使用期间无需加水或加酸
- ◆ 极板优化处理, 提升15分钟放电性能, 高倍率放电性能优异
- ◆ 在-20°C到55°C温度区间内均可正常使用, 深放电恢复能力出色
- ◆ 隔板特色设计, 抗腐蚀性能佳, 同时大幅度降低电池内阻
- ◆ 12年设计寿命(25°C), 自放电率低



产品应用

- ◆ 不间断电源(高功率)
- ◆ 通讯设备
- ◆ 安全系统
- ◆ 数据网络中心
- ◆ 应急电源系统
- ◆ 银行资金系统
- ◆ 医疗测试设备

尺寸

单个尺寸

长	522±2mm / 20.55inch
宽	268±2mm / 10.55inch
高	220±3mm / 8.66inch
总高	226±3mm / 8.9inch

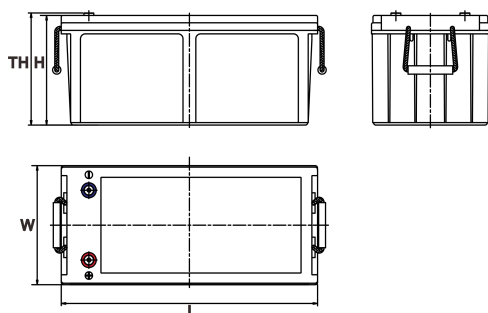

端子类型

单位:mm

端子类型 I7

重量

72.5kg 159.83lbs

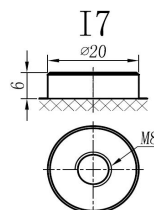

ISO9001 ISO14001 OHSAS18001

内容如有改动, 恕不另行通知

动力电池 储能电池 备用电池 摩托车电池

TNX12-790W

规格书

额定电压	12V	
15分钟放电功率	790W F.V (1.67V/cell)	
额定容量 (10小时)	250Ah (1.80V/cell)	
尺寸	长	522±2mm
	宽	268±2mm
	高	220±3mm
	总高	226±3mm
重量	72.5kg	
端子	I7	
壳体材料	ABS (阻燃ABS壳体可选)	
使用温度范围	放电	-20 ~ +50°C
	充电	0 ~ +40°C
	储存	-15 ~ +40°C
不同温度下 电池容量系数	40°C / 104°F	106%
	25°C / 77°F	100%
	0°C / 32°F	86%
	-10°C / 14°F	65%
充电	浮充电压	2.25 - 2.27V/单格@25°C, 温度补偿系数: -3mV/单格/°C
	均充电压	2.40 - 2.50V/单格@25°C, 温度补偿系数: -3mV/单格/°C
	循环使用电压	2.40 - 2.50V/单格@25°C, 温度补偿系数: -5mV/单格/°C
最大充电电流	75A (0.3C)	
最大放电电流 (5S)	2500A	
电阻	2.5mΩ	
自放电	<3%, TNX系列储存在25°C时需每6个月进行一次补充充电, 环境温度更高时则充电间隔时间越短	

放电性能

恒电流放电表 (25°C/77°F) 单位: A														
F.V/Time	10min	15min	20min	30min	45min	1h	2h	3h	4h	5h	6h	8h	10h	20h
1.85V/cell	388.1	338.3	285.7	220.7	166.9	134.55	81.93	59.68	47.43	39.59	35.18	29.50	24.444	12.610
1.80V/cell	437.9	377.7	314.7	235.6	179.3	145.14	87.32	63.41	49.98	41.94	37.14	30.87	25.026	13.095
1.75V/cell	474.7	396.6	328.2	244.5	185.2	150.72	89.47	64.78	51.55	43.02	37.83	31.16	25.511	13.192
1.70V/cell	502.0	423.3	345.2	251.0	190.8	155.13	91.14	66.35	52.63	43.81	38.51	31.36	25.899	13.289
1.67V/cell	/	446.4	357.9	260.4	195.4	159.05	92.90	67.13	53.51	44.59	39.10	31.75	26.093	13.386
1.60V/cell	/	465.5	368.3	265.3	198.7	162.48	94.57	68.50	54.59	45.18	39.49	32.05	26.287	13.483

恒功率放电表 (25°C/77°F) 单位: W														
F.V/Time	10min	15min	20min	30min	45min	1h	2h	3h	4h	5h	6h	8h	10h	20h
1.85V/cell	716.9	631.2	538.6	420.7	322.6	265.32	164.54	120.48	96.03	80.59	71.68	60.19	50.490	26.096
1.80V/cell	799.2	695.3	584.5	442.1	343.7	284.92	174.93	127.61	100.88	84.84	75.34	62.77	51.530	26.888
1.75V/cell	852.7	721.0	603.5	455.1	353.8	295.22	178.79	129.89	103.55	86.63	76.63	63.26	52.183	26.987
1.70V/cell	881.2	759.0	630.2	464.5	364.0	302.94	181.47	132.66	105.44	88.01	77.72	63.46	52.787	27.185
1.67V/cell	/	790.2	648.5	478.1	369.7	309.38	184.44	134.05	107.12	89.30	78.71	64.05	53.183	27.393
1.60V/cell	/	814.6	660.0	483.8	371.5	313.53	186.91	136.22	108.90	90.19	79.40	64.45	53.480	27.492