

Motive Battery

Energy Storage Battery

Reserve Battery

Motorcycle Battery



## Maintenance Free-High Rate UPS Battery-TNX Series

# TNX12-80W

(12V 81W, 15min@1.67Vpc)

(12V 22Ah, C10 @1.80Vpc)

### GENERAL FEATURES

- ◆ Oxygen recombination technology: maintenance-free, no need to add water or acid during application
- ◆ Optimized plate design to increase power output at 15min backup time, high performance in high-rate discharge
- ◆ Wide operating temperature range from -20°C to 55°C, excellent deep discharge recovery capability
- ◆ New structure for plate grid, good corrosion resistance and greatly reduced resistance of the battery,
- ◆ 12 years design life @25°C, low self-discharge rate



### Application

- ◆ UPS ( High Rate )
- ◆ Communication Equipments
- ◆ Security systems
- ◆ Data & Network centers
- ◆ Emergency power supply ( EPS )
- ◆ Bank and financial system
- ◆ Hospitals & Testing laboratories

### Dimension

Unit:mm

Length 182±2mm / 7.17inch

Width 77±2mm / 3.03inch

Container Height 170±3mm / 6.69inch

Total Height 170±3mm / 6.69inch

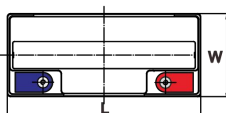
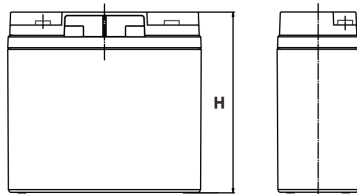

### Terminal

Unit:mm

Terminal Type: I1

### Weight

6.9kg

15.21lbs

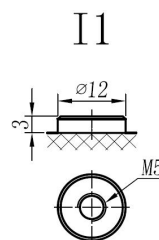

ISO9001 ISO14001 OHSAS18001

This document is subject to change without prior notification

- Motive Battery     Energy Storage Battery  
 Reserve Battery     Motorcycle Battery



## TNX12-80W

### Specifaion

<b>Nominal Voltage</b>	12V	
<b>Rated Power (15min Rate 25°C)</b>	81W F.V (1.67V/cell)	
<b>Rated Capacity (10HR 25°C)</b>	20Ah (1.80V/cell)	
<b>Dimension</b>	<b>Length</b>	182±2mm / 7.17inch
	<b>Width</b>	77±2mm / 3.03inch
	<b>Container Height</b>	170±3mm / 6.69inch
	<b>Total Height</b>	170±3mm / 6.69inch
<b>Weight</b>	6.9kg / 15.21lbs	
<b>Terminal</b>	I1	
<b>Container Material</b>	ABS ( Flame-retardant ABS UL94-V0 is optional )	
<b>Operating Temperature Range</b>	<b>Discharge</b>	-20 ~ +50°C
	<b>Charge</b>	0 ~ +40°C
	<b>Storage</b>	-15 ~ +40°C
<b>Capacity Effected by Temperature</b>	<b>40°C / 104°F</b>	106%
	<b>25°C / 77°F</b>	100%
	<b>0°C / 32°F</b>	86%
	<b>-10°C / 14°F</b>	65%
<b>Charge</b>	<b>Float Voltage</b>	2.25 -2.27V/cell@25°C, Tem.Coefficient : -3mV/cell/°C
	<b>Equalize Voltage</b>	2.40 -2.50V/cell@25°C, Tem.Coefficient : -3mV/cell/°C
	<b>Cycle Voltage</b>	2.40 -2.50V/cell@25°C, Tem.Coefficient : -5mV/cell/°C
<b>Max. Charging Current</b>	6.6A ( 0.3C )	
<b>Max. Discharge Current (5S)</b>	300A	
<b>Internal Resistance</b>	14mΩ	
<b>Self-Discharge</b>	<3%, TNX series stored at 25 °C require a supplementary charge every six months, the charging interval would shrink when the ambient temperature went higher	

### Discharge Performance

Constant Current Discharge Table (25°C/77°F) Unit: A															
F.V/Time	5min	10min	15min	20min	30min	45min	1h	2h	3h	4h	5h	6h	8h	10h	20h
1.85V/cell	53.9	39.5	33.3	28.2	21.5	15.7	12.36	7.07	5.16	4.11	3.46	3.01	2.42	1.958	1.022
1.80V/cell	62.8	44.4	36.8	30.3	22.5	16.3	12.80	7.35	5.35	4.29	3.62	3.15	2.50	1.999	1.039
1.75V/cell	70.0	47.9	39.9	32.2	23.4	16.8	13.14	7.55	5.47	4.40	3.71	3.21	2.54	2.033	1.051
1.70V/cell	75.7	51.3	42.3	33.5	24.0	17.2	13.46	7.67	5.57	4.48	3.76	3.26	2.57	2.056	1.063
1.67V/cell	81.7	54.9	44.4	35.0	24.5	17.5	13.72	7.83	5.69	4.56	3.82	3.31	2.60	2.083	1.078
1.60V/cell	86.8	58.2	46.2	36.1	25.1	17.9	13.94	7.98	5.78	4.64	3.88	3.34	2.63	2.107	1.089

Constant Power Discharge Table (25°C/77°F) Unit: W															
F.V/Time	5min	10min	15min	20min	30min	45min	1h	2h	3h	4h	5h	6h	8h	10h	20h
1.85V/cell	101.7	75.3	64.0	54.6	41.9	30.8	24.59	14.14	10.36	8.27	6.99	6.11	4.92	4.068	2.128
1.80V/cell	117.4	83.9	70.4	58.4	43.8	31.8	25.39	14.65	10.71	8.61	7.28	6.35	5.06	4.137	2.154
1.75V/cell	129.6	89.9	75.8	61.8	45.2	32.8	26.00	15.01	10.91	8.80	7.44	6.45	5.12	4.192	2.170
1.70V/cell	138.2	95.0	79.3	63.6	45.9	33.2	26.41	15.12	11.01	8.89	7.48	6.50	5.15	4.204	2.179
1.67V/cell	146.7	100.1	81.4	65.5	46.5	33.5	26.68	15.30	11.16	8.99	7.55	6.56	5.16	4.212	2.192
1.60V/cell	152.1	103.9	83.8	66.4	46.7	33.6	26.70	15.37	11.18	9.01	7.55	6.53	5.14	4.221	2.200

动力电池

储能电池

备用电池

摩托车电池



## 阀控免维护-高功率UPS电池-TNX系列

# TNX12-80W

(12V 81W, 15min@1.67Vpc)

(12V 22Ah, C10 @1.80Vpc)

### 产品特点：

- 氧复合技术: 阀控式免维护, 使用期间无需加水或加酸
- 极板优化处理, 提升15分钟放电性能, 高倍率放电性能优异
- 在-20°C到55°C温度区间内均可正常使用, 深放电恢复能力出色
- 隔板特色设计, 抗腐蚀性能佳, 同时大幅度降低电池内阻
- 12年设计寿命(25°C), 自放电率低



### 产品应用

- 不间断电源(高功率)
- 通讯设备
- 安全系统
- 数据网络中心
- 应急电源系统
- 银行资金系统
- 医疗测试设备

### 尺寸

单个尺寸

长	182±2mm / 7.17inch
宽	77±2mm / 3.03inch
高	170±3mm / 6.69inch
总高	170±3mm / 6.69inch

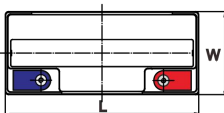
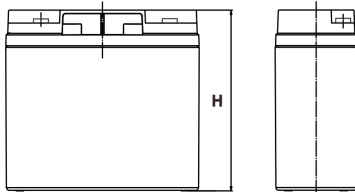

### 端子类型

单位:mm

端子类型 I1

### 重量

6.9kg 15.21lbs

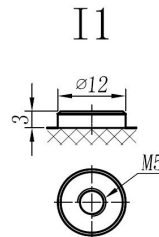

ISO9001 ISO14001 OHSAS18001

内容如有改动, 恕不另行通知

动力电池

储能电池

备用电池

摩托车电池



## TNX12-80W

### 规格书

额定电压	12V	
15分钟放电功率	81W F.V (1.67V/cell)	
额定容量 (10小时)	20Ah (1.80V/cell)	
尺寸	长	182±2mm
	宽	77±2mm
	高	170±3mm
	总高	170±3mm
重量	6.9kg	
端子	I1	
壳体材料	ABS (阻燃ABS壳体可选)	
使用温度范围	放电	-20 ~ +50°C
	充电	0 ~ +40°C
	储存	-15 ~ +40°C
不同温度下 电池容量系数	40°C / 104°F	106%
	25°C / 77°F	100%
	0°C / 32°F	86%
	-10°C / 14°F	65%
充电	浮充电压	2.25 -2.27V/单格@25°C, 温度补偿系数: -3mV/单格/°C
	均充电压	2.40 -2.50V/单格@25°C, 温度补偿系数: -3mV/单格/°C
	循环使用电压	2.40 -2.50V/单格@25°C, 温度补偿系数: -5mV/单格/°C
最大充电电流	6.6A (0.3C)	
最大放电电流 (5S)	300A	
电阻	14mΩ	
自放电	<3%, TNX系列储存在25°C时需每6个月进行一次补充充电, 环境温度更高时则充电间隔时间越短	

### 放电性能

恒电流放电表 (25°C/77°F) 单位: A															
F.V/Time	5min	10min	15min	20min	30min	45min	1h	2h	3h	4h	5h	6h	8h	10h	20h
1.85V/cell	53.9	39.5	33.3	28.2	21.5	15.7	12.36	7.07	5.16	4.11	3.46	3.01	2.42	1.958	1.022
1.80V/cell	62.8	44.4	36.8	30.3	22.5	16.3	12.80	7.35	5.35	4.29	3.62	3.15	2.50	1.999	1.039
1.75V/cell	70.0	47.9	39.9	32.2	23.4	16.8	13.14	7.55	5.47	4.40	3.71	3.21	2.54	2.033	1.051
1.70V/cell	75.7	51.3	42.3	33.5	24.0	17.2	13.46	7.67	5.57	4.48	3.76	3.26	2.57	2.056	1.063
1.67V/cell	81.7	54.9	44.4	35.0	24.5	17.5	13.72	7.83	5.69	4.56	3.82	3.31	2.60	2.083	1.078
1.60V/cell	86.8	58.2	46.2	36.1	25.1	17.9	13.94	7.98	5.78	4.64	3.88	3.34	2.63	2.107	1.089

恒功率放电表 (25°C/77°F) 单位: W															
F.V/Time	5min	10min	15min	20min	30min	45min	1h	2h	3h	4h	5h	6h	8h	10h	20h
1.85V/cell	101.7	75.3	64.0	54.6	41.9	30.8	24.59	14.14	10.36	8.27	6.99	6.11	4.92	4.068	2.128
1.80V/cell	117.4	83.9	70.4	58.4	43.8	31.8	25.39	14.65	10.71	8.61	7.28	6.35	5.06	4.137	2.154
1.75V/cell	129.6	89.9	75.8	61.8	45.2	32.8	26.00	15.01	10.91	8.80	7.44	6.45	5.12	4.192	2.170
1.70V/cell	138.2	95.0	79.3	63.6	45.9	33.2	26.41	15.12	11.01	8.89	7.48	6.50	5.15	4.204	2.179
1.67V/cell	146.7	100.1	81.4	65.5	46.5	33.5	26.68	15.30	11.16	8.99	7.55	6.56	5.16	4.212	2.192
1.60V/cell	152.1	103.9	83.8	66.4	46.7	33.6	26.70	15.37	11.18	9.01	7.55	6.53	5.14	4.221	2.200